

PITT ANNIE SPRUILL
 7246 NC 42 HWY E
 .610 AC .61AC

Wilson County
 YR 2024 3773562023.000
 7246 NC 42 HWY E
 PIN: 3773 56 2023 000
 DISTRICT: 25 C/SW/BAKERTOWN

ACCOUNT#: 1122841
 NBHD: 8121 GARDNERS
 Plat Bk/Pg 38 107
 EXCD: APPR: KRC APPR DT: 5/23/2022
 NOTICE: 82 3/08/2024

Bldg No. 1
 Imp Desc: R1.0 SFR-1.0 STY
 Grade : C+05 C+05 GRADE
 # of Units 4 Rms 3 Bedrms 1.0 Bathrms 1 HBaths

YB: 1979 7246 NC 42 HWY E
 AYB: 1969 Finished Area: 1,639.00

Exempt Code
 LAND VALUE 24,705
 MISC VALUE 5
 BLDG VALUE 0
 TOTAL VALUE 24,710

TYPE/CODE/DESCRIPTION	PCT	%CMP	UNITS	RATE	STR#	STR%	SIZ%	HGT%	PER%	COST
AC 1031 CARPORT	100		308	27.90			97.00			8,335
AC 1053 STOOP-MAS	100		15	19.40			120.00			349
AC 1071 UTILITY STG-FR	100		40	39.45			110.00			1,735
MA 111 SFR-1.0 STY	100		1639	136.00	1.00		99.38			221,520
- AR 10 FORCED AIR HEAT W/ A100			1639	.00						0
- BT BT FULL BATH	100		1-	5500.00						5,500-
- BT HBT HALF BATH	100		1	3667.00						3,667
- EW 18 BRICK VENEER	100		194	35.00						6,790
- FC 03 HARDWOOD	100		1639	4.35						7,129
- FN 03 CONT WALL-BRICK	100		194	.00						0
- FP 3 1STY SNGL	100		1	5100.00						5,100
- IF 01 DRYWALL	100		1639	.00						0
- RC 02 COMPOSITION SHINGLE	100		1639	.00						0
- RT 03 DOUBLE PITCH ROOF	100		1639	.00						0

RCN...			PCT COMPLETE		100	x				249,125
QUAL..		C+05			105.00	x				261,582
DEPR..	RC				55.00	-		143,869		
ADDL..	FD		FIRE DAMAGE		100.00	-		117,713		261,582 T
--ASV...										0

PROPERTY NOTES:	PERMIT NO	TYPE	DATE	BOOK	PAGE	DT	DATE	QS	SALES	PRICE
FD 100% ON SFR & OB OK 4'22				2021	CDTH	CDTH	1/31/2021	E		
PERMIT CODE: N MO/YR: 081995			NOTE: SW MOHO	AMOUNT		@	10/25/1999	@		
				AMOUNT	1019	461	WD	5/06/1968	X	1,000

MISC CODE	DESC	UNITS	RATE	AYB	EYB	DT	PCT	%CMP	ADD.DEPR	PCT	VALUE	EXMPT
81 1173	OFFICE	1.00	24.00	1985	1985	MFR	75.00	100			5	
							.00					
							.00					
							.00					

#	ZONE	TYPE/CODE	LAND QTY	LAND RATE	DPTH	DPT%	TOP%	LOC%	SIZ%	SHP%	OTH%	ADJ	FMV	EXMPT
1	B1	AC 0700	.610	30,000.00		.00	.00	.00	135.00	.00	.00	135.00	24,705	

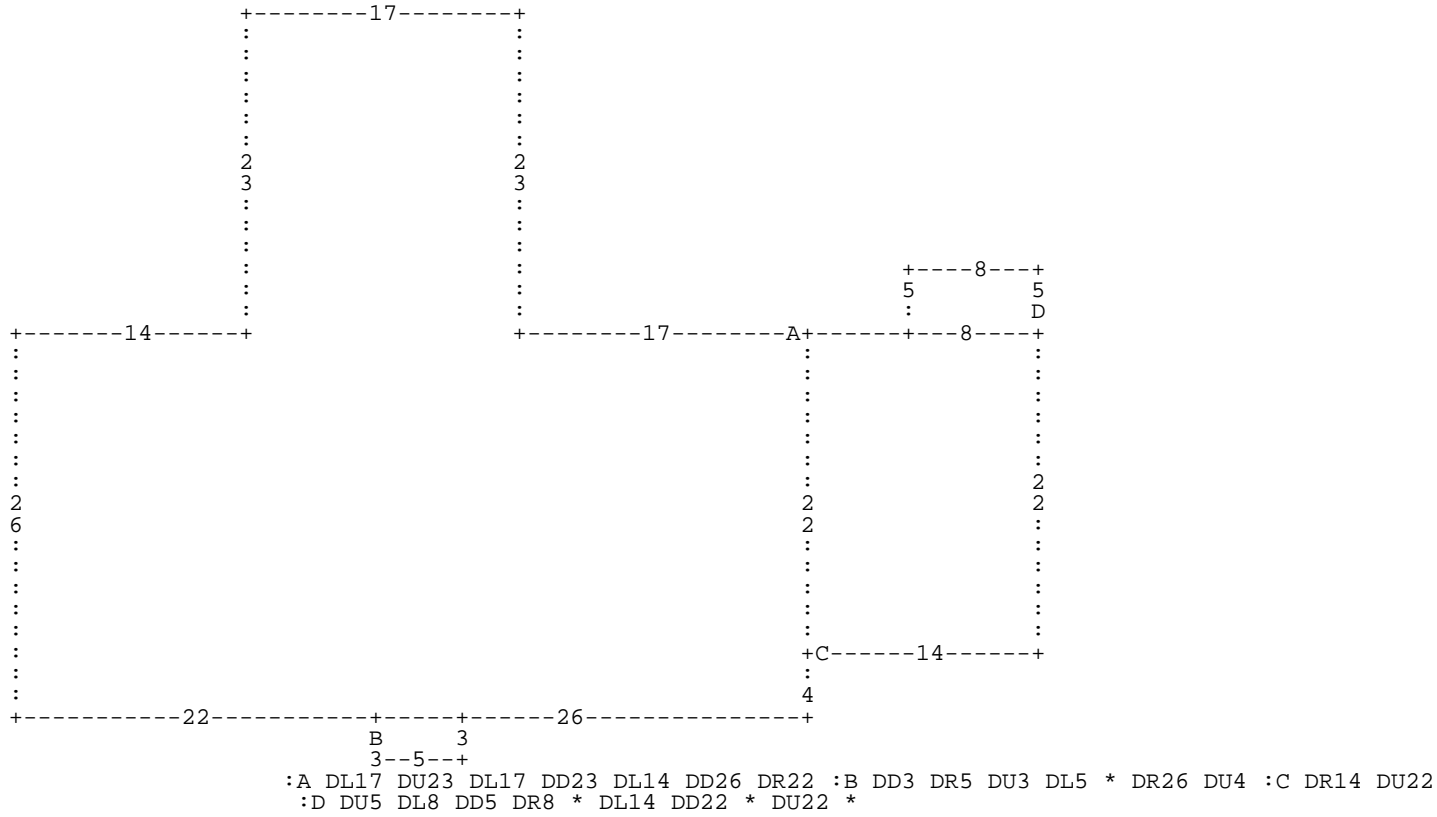

A= MA 111
 D= AC 1071

1,639.00 SFR-1.0 STY
 40.00 UTILITY STG-F

B= AC 1053

15.00 STOOP-MAS

C= AC 1031

308.00 CARPORT