

BARNHILL WILLIAM KENNETH  
 7151 HOLDENS CROSS RD  
 L1 1.030 AC

N2 FOUND YR 2024 **3771548483.000**  
 7151 HOLDENS CROSS RD  
 PIN: 3771 54 8483 000  
**DISTRICT:** 25 C/SW/BAKERTOWN SWAF

Wilson County

**ACCOUNT#:** 69933675  
**NBHD:** 8264 SARATOGA\_TWP  
 Plat Bk/Pg 30 91  
**EXCD:** 1.00  
 APPR: REV APPR DT: 8/11/2015  
 NOTICE: 82 3/08/2024

Bldg No. 1 Exempt Code  
 Imp Desc: DWA MH-DOUBLE WIDE W/ADDN EYB: 2007 7151 HOLDENS CROSS RD  
 Grade : C C GRADE AYB: 2001 Finished Area: 2,177.00  
 # of Units 5 Rms 3 Bedrms 2.0 Bathrms HBaths  
 Manufacturer: Serial#: Model:

**LAND VALUE** 20,288  
**MISC VALUE** 1,725  
**BLDG VALUE** 209,804  
**TOTAL VALUE** 231,817

TYPE/CODE/DESCRIPTION	PCT	%CMP	UNITS	RATE	STR#	STR%	SIZ%	HGT%	PER%	COST
AC 1051 PORCH-OPEN-FR	100		32	38.80			120.00			1,489
AC 1052 PORCH-OPEN-MAS	100		224	29.10			100.00			6,518
AC 1056 PORCH-ENCL-FR	100		200	58.20		100.00	100.00			11,640
MA 152 MFG-DOUBLE WIDE	100		1904	111.00	1.00		89.50			189,152
- AR 10 FORCED AIR HEAT W/ A100	100		1904	.00						0
- EW 02 VINYL SIDING	100		192	.00						0
- FC 48 VINYL/CARPET	100		1904	.00						0
- FN 03 CONT WALL-BRICK	100		192	.00						0
- FP 2 PREFAB	100		1	3500.00						3,500
- IF 30 DRYWALL/CUSTOM	100		1904	.00						0
- RC 02 COMPOSITION SHINGLE	100		1904	.00						0
- RT 03 DOUBLE PITCH ROOF	100		1904	.00						0
MA 191 SFR-ADDT FR	100		273	102.00	1.00		124.00			34,529
-----										
RCN...			PCT COMPLETE		100		x			246,828
QUAL..	C				100.00		x			246,828
DEPR..	RC				15.00		-	37,024		37,024 T
--ASV...										209,804

PROPERTY NOTES:	PERMIT NO	TYPE	DATE	BOOK	PAGE	DT	DATE	QS	SALES	PRICE
ADDED 8X12 STORAGE 3/19/14						@	8/20/2001	@		
PERMIT CODE: N MO/YR: 082001 NOTE: DWMH				AMOUNT	1616	846	WD	2/18/1997	X	
				AMOUNT						

MISC CODE	DESC	UNITS	RATE	AYB	EYB	DT	PCT	%CMP	ADD.DEPR	PCT	VALUE	EXMPT
81 1173	STG-FR 12 X 8	96.00	24.00	2013	2013	MAV	22.00	100			1,725	
							.00					
							.00					
							.00					

#	ZONE	TYPE/CODE	LAND QTY	LAND RATE	DPTH	DPT%	TOP%	LOC%	SIZ%	SHP%	OTH%	ADJ	FMV	EXMPT
1	AR	AC 5010	1.000	20,000.00		.00	.00	.00	100.00	.00	.00	.00	20,000	
2	AR	AC 0121	.030	4,000.00		.00	.00	.00	240.00	.00	.00	240.00	288	

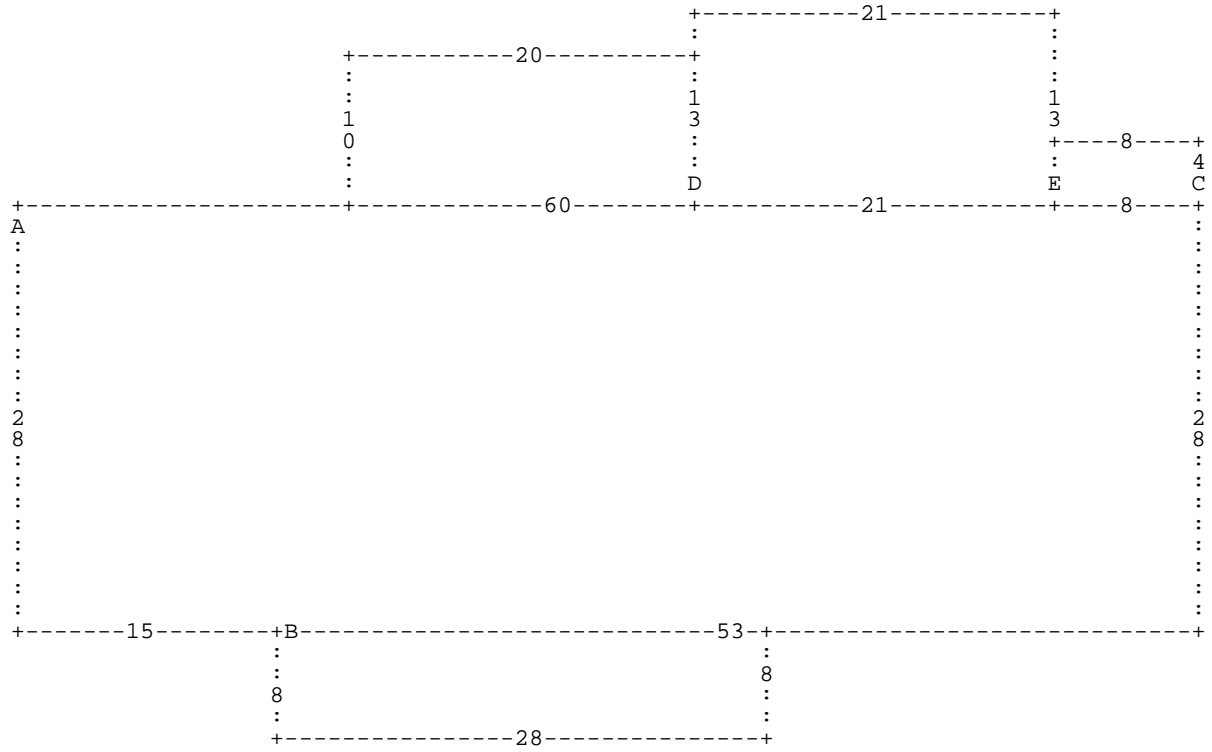

:A DD28 DR15 :B DR28 DD8 DL28 DU8 \* DR53 DU28 :C DU4 DL8 DD4 DR8 \* DL8 :E DU13 D  
 L21 DD13 :D DU10 DL20 DD10 DR20 \* DR21 \* DL60 \*

**A=** MA 152  
**D=** AC 1056

1,904.00 MFG-DOUBLE WI  
 200.00 PORCH-ENCL-FR

**B=** AC 1052  
**E=** MA 191

224.00 PORCH-OPEN-MA  
 273.00 SFR-ADDT FR

**C=** AC 1051

32.00 PORCH-OPEN-FR