

KEARNEY-HARRELL KATHERINE
 6461 GUM POND RD
 L2 1.81AC

N2 FOUND

Wilson County
 YR 2024 3760957069.000
 6461 GUM POND RD
 PIN: 3760 95 7069 000
 DISTRICT: 26 C/SW/SANOCA FD SWAF

ACCOUNT#: 1122467
 NBHD: 8264 SARATOGA_TWP
 Plat Bk/Pg 43 17
 EXCD: 1.00

PAGE 1
 DT: 1/09/2023
 NOTICE: 82 3/08/2024

Bldg No. 1
 Imp Desc: R1.5 SFR-UPTO 1.5 STY EYB: 2022 6461 GUM POND RD Exempt Code
 Grade : B-05 B-05 GRADE AYB: 2022 Finished Area: 3,050.00
 # of Units 5 Rms 3 Bedrms 2.0 Bathrms 1 HBaths

LAND VALUE 25,929
 MISC VALUE 0
 BLDG VALUE 431,672
 TOTAL VALUE 457,601

TYPE/CODE/DESCRIPTION	PCT	%CMP	UNITS	RATE	STR#	STR%	SIZ%	HGT%	PER%	COST
AC 1022 GARAGE-ATT-MAS	100		681	44.65		100.00	85.00			25,845
AC 1052 PORCH-OPEN-MAS	100		76	29.10		100.00	106.00			2,344
AC 1052 PORCH-OPEN-MAS	100		204	29.10		100.00	100.00			5,936
MA 112 SFR-1.5 STY	100		1883	116.00	1.62		88.50			193,308
MA 112 (UPPER FLOORS)	100		1167	116.00	1.62	100.00	88.50			119,804
- AR 10 FORCED AIR HEAT W/ A100			3050	.00						0
- BT HBT HALF BATH	0		1	3667.00						3,667
- EW 18 BRICK VENEER	100		214	35.00						7,490
- FC 20 HARDWOOD/CARPET	100		3050	2.00						6,100
- FN 06 SPREAD FOOTING	100		214	5.30-						1,134-
- IF 48 CUSTOM INTERIOR	100		1883	.00						0
- RC 07 WOOD SHAKES/3D-SHING100			1883	.00						0
- RT 03 DOUBLE PITCH ROOF	100		1883	.00						0
RCN...		PCT COMPLETE			100	x				363,360
QUAL..	B-05				120.00	x				436,032
DEPR.. RB					1.00	-		4,360		4,360 T
--ASV...										431,672

PROPERTY NOTES:
 HOME COMP 4'23

PERMIT NO	TYPE	DATE	BOOK	PAGE	DT	DATE	QS	SALES	PRICE
BP21000132N		10/07/2021	2899	315	DG	5/28/2021	E		
AMOUNT		299,171	2658	816	SPL	5/06/2021	#		
AMOUNT									

MISC CODE	DESC	UNITS	RATE	AYB	EYB	DT	PCT	%CMP	ADD.DEPR	PCT	VALUE	EXMPT
							.00					
							.00					
							.00					
							.00					

#	ZONE	TYPE/CODE	LAND	QTY	LAND RATE	DPTH	DPT%	TOP%	LOC%	SIZ%	SHP%	OTH%	ADJ	FMV	EXMPT
1	AR	AC 5010		1.000	20,000.00		.00	.00	.00	100.00	.00	.00	.00	20,000	
2	AR	AC 0121		.810	4,000.00		.00	.00	.00	183.00	.00	.00	183.00	5,929	

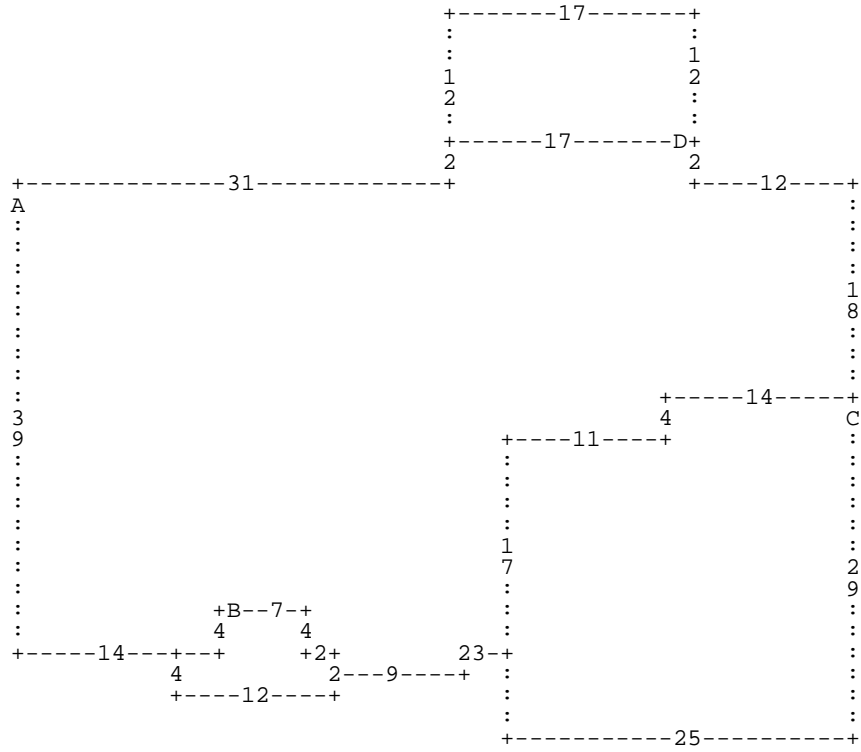

:A DD39 DR14 DU4 :B DR7 DD4 DR2 DD4 DL12 DU4 DR3 DU4 * DR7 DD4 DR2 DD2 DR9 DU2 D
R3 DU17 DR11 DU4 DR14 :C DD29 DL25 DU25 DR11 DU4 DR14 * DU18 DL12 DU2 :D DL17 DU
12 DR17 DD12 * DL17 DD2 DL31 *

A= MA 112
D= AC 1052

1,883.00 SFR-1.5 STY
204.00 PORCH-OPEN-MA

B= AC 1052

76.00 PORCH-OPEN-MA

C= AC 1022

681.00 GARAGE-ATT-MA