

Wilson County
 KATIE COBB HEIRS SOLAR FARM N2 FOUND YR 2024 3744186955.000
 6230 EAST LANGLEY RD 6230 EAST LANGLEY RD
 L3 .690 AC .690 AC PIN: 3744 18 6955 000
 DISTRICT: 7 C/CIEC/FRTO-ELM

ACCOUNT#: 1105781 PAGE 1
 NBHD: 8108 ELM_CITY-RA
 Plat Bk/Pg 41 237 APPR: GRW APPR DT: 2/06/2019
 EXCD: NOTICE: 82 3/08/2024

Bldg No. 1
 Imp Desc: R1.0 SFR-1.0 STY EYB: 1970 6230 EAST LANGLEY RD Exempt Code
 Grade : D+05 D+05 GRADE AYB: 1925 Finished Area: 1,144.00
 # of Units 3 Rms 2 Bedrms 1.0 Bathrms HBaths

LAND VALUE 17,940
 MISC VALUE 0
 BLDG VALUE 41,330
 TOTAL VALUE 59,270

TYPE/CODE/DESCRIPTION	PCT	%CMP	UNITS	RATE	STR#	STR%	SIZ%	HGT%	PER%	COST
AC 1051 PORCH-OPEN-FR	100		144	38.80			102.00			5,698
AC 1064 DECK-WOOD	100		36	24.95		100.00	120.00			1,077
MA 111 SFR-1.0 STY	100		1144	136.00	1.00		106.38			165,509
- AR N NO AC	100		1144	3.35-						3,832-
- AR 11 GAS FORCED HOT AIR	100		1144	.00						0
- BT BT FULL BATH	100		1-	5500.00						5,500-
- EW 20 ASBESTOS SIDING	100		148	21.40-						3,167-
- FC 10 SOFTWOOD	100		1144	4.35						4,976
- FN 02 CONT WALL-CONC BLOCK	100		148	.00						0
- IF 08 DRYWALL/PLASTER	100		1144	.00						0
- RC 04 METAL-CORRUGATED	100		1144	1.65						1,887
- RT 03 DOUBLE PITCH ROOF	100		1144	.00						0
RCN...			PCT COMPLETE		100	x				166,648
QUAL..	D+05				80.00	x				133,318
DEPR.. RD					69.00	-		91,988		91,988 T
--ASV...										41,330

PROPERTY NOTES:

PERMIT NO	TYPE	DATE	BOOK	PAGE	DT	DATE	QS	SALES	PRICE
			2673	838	SPL	11/01/2018	#		
AMOUNT									
AMOUNT									

MISC CODE	DESC	UNITS	RATE	AYB	EYB	DT	PCT	%CMP	ADD.DEPR	PCT	VALUE	EXMPT
							.00					
							.00					
							.00					
							.00					

#	ZONE	TYPE/CODE	LAND QTY	LAND RATE	DPTH	DPT%	TOP%	LOC%	SIZ%	SHP%	OTH%	ADJ	FMV	EXMPT
1	RA	AC 5010	.690	20,000.00		.00	.00	.00	130.00	.00	.00	130.00	17,940	

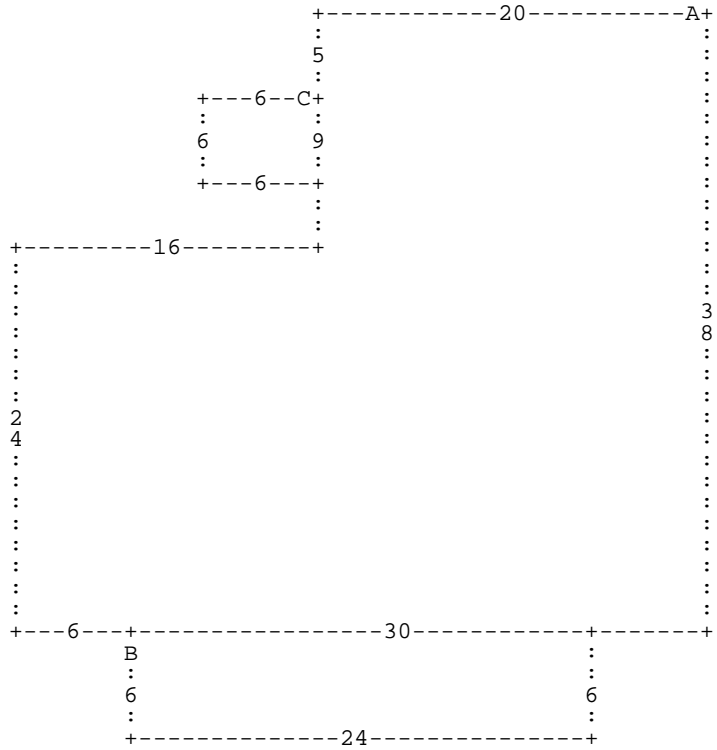

:A DL20 DD5 :C DL6 DD6 DR6 DU6 * DD9 DL16 DD24 DR6 :B DD6 DR24 DU6 DL24 * DR30 D
 U38 *

A= MA 111

1,144.00 SFR-1.0 STY

B= AC 1051

144.00 PORCH-OPEN-FR

C= AC 1064

36.00 DECK-WOOD