

JOYNER JUANITA G
 4043 WEAVER RD
 L2 3.16AC
 3.160 AC

Wilson County
 YR 2024 3742393647.000
 4043 WEAVER RD
 PIN: 3742 39 3647 000
 DISTRICT: 12 C/SW/EAST NASH SWAF

ACCOUNT#: 1124428
 NBHD: 8121 GARDNERS
 Plat Bk/Pg 43 298
 EXCD: 1.00
 APPR: GRW APPR DT: 3/14/2023
 NOTICE: 82 3/08/2024
 PAGE 1

Bldg No. 1
 Imp Desc: DW MH-DOUBLE WIDE EYB: 1998 4043 WEAVER RD Exempt Code
 Grade : C C GRADE AYB: 1988 Finished Area: 1,725.00
 # of Units 7 Rms 3 Bedrms 2.0 Bathrms HBaths
 Manufacturer: FUQUA HOMES Serial#: PHNC15373AB88 Model: PARKWAY NA2813

LAND VALUE 40,956
 MISC VALUE 5,505
 BLDG VALUE 112,441
 TOTAL VALUE 158,902

TYPE/CODE/DESCRIPTION	PCT	%CMP	UNITS	RATE	STR#	STR%	SIZ%	HGT%	PER%	COST
AC 1051 PORCH-OPEN-FR	100		84	38.80			106.00			3,454
AC 1051 PORCH-OPEN-FR	100		28	38.80		100.00	120.00			1,303
AC 1056 PORCH-ENCL-FR	100		224	58.20		100.00	100.00			13,036
AC 1064 DECK-WOOD	100		240	24.95			100.00			5,988
MA 152 MFG-DOUBLE WIDE	100		1725	111.00	1.00		94.50			180,943
- AR 10 FORCED AIR HEAT W/ A100			1725	.00						0
- EW 02 VINYL SIDING	100		196	.00						0
- FC 48 VINYL/CARPET	100		1725	.00						0
- FN 03 CONT WALL-BRICK	100		196	.00						0
- FP 2 PREFAB	100		1	3500.00						3,500
- IF 01 DRYWALL	100		1725	.00						0
- RC 02 COMPOSITION SHINGLE	100		1725	.00						0
- RT 03 DOUBLE PITCH ROOF	100		1725	.00						0

RCN...			PCT COMPLETE		100	x				208,224
QUAL..	C				100.00	x				208,224
DEPR.. MC					46.00	-		95,783		95,783 T
--ASV...										112,441

PROPERTY NOTES:

PERMIT NO	TYPE	DATE	BOOK	PAGE	DT	DATE	QS	SALES	PRICE
			2997	522	CMB	12/20/2022	Y		
AMOUNT			2997	522	IC	12/20/2022	Y		
AMOUNT			2937	487	QD	12/13/2021	E		
					@	10/25/1999	@		

MISC CODE	DESC	UNITS	RATE	AYB	EYB	DT	PCT	%CMP	ADD.DEPR	PCT	VALUE	EXMPT
81 1173	STG-FR 11 X 16	176.00	24.00	1960	1963	MFR	75.00	100			744	
82 1173	STG-FR 14 X 28	392.00	24.00	1960	1975	MAV	65.00	100			2,964	
83 1143	SHELTER-OPEN 14 X 14	196.00	10.50	1988	1988	MAV	65.00	100			721	
84 1143	SHELTER-OPEN 12 X 36	432.00	10.50	1988	1988	MFR	75.00	100			800	

#	ZONE	TYPE/CODE	LAND QTY	LAND RATE	DPTH	DPT%	TOP%	LOC%	SIZ%	SHP%	OTH%	ADJ	FMV	EXMPT
1	AR	AC 5010	1.000	24,000.00		.00	.00	.00	100.00	.00	.00	.00	24,000	
2	AR	AC 0121	2.160	5,000.00		.00	.00	.00	157.00	.00	.00	157.00	16,956	

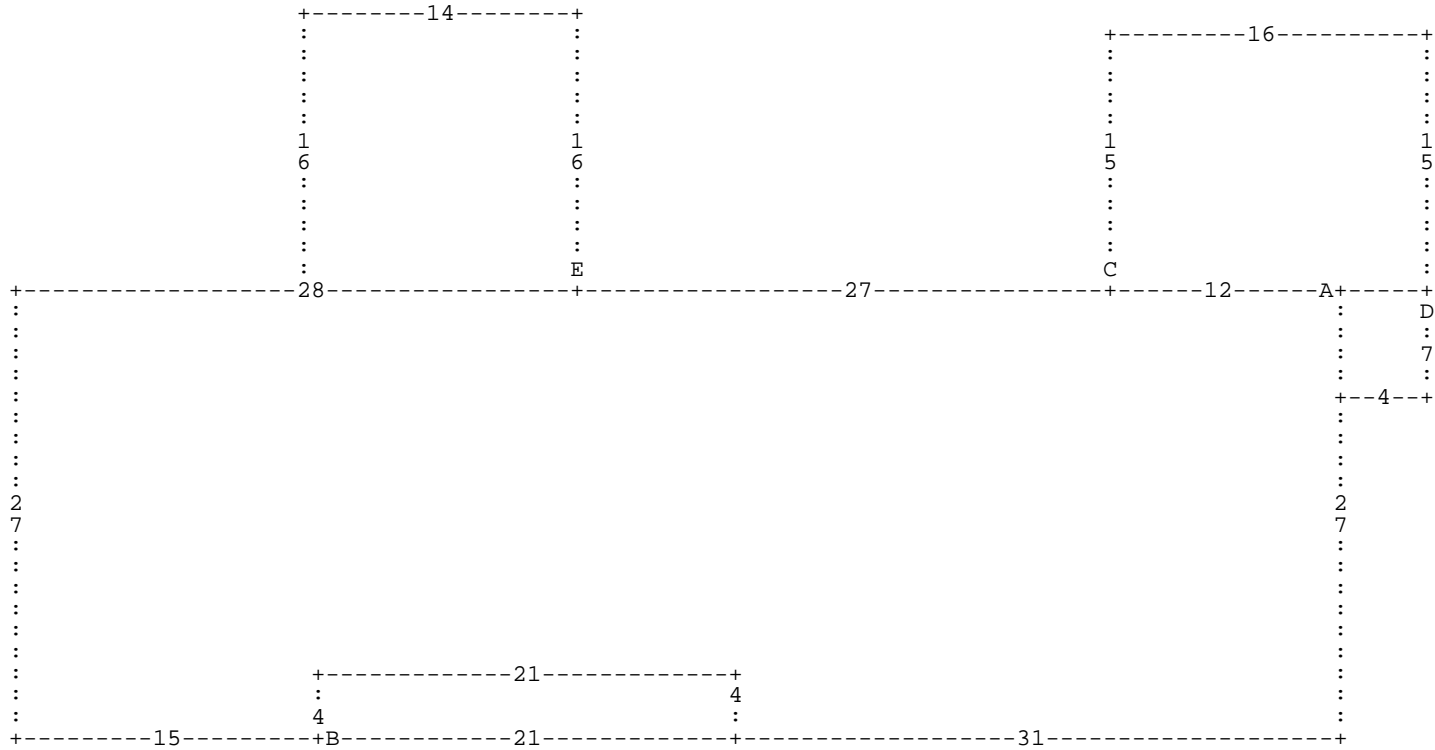

:A DL12 :C DU15 DR16 DD15 :D DD7 DL4 DU7 DR4 * DL16 * DL27 :E DU16 DL14 DD16 DR1
 4 * DL28 DD27 DR15 :B DR21 DU4 DL21 DD4 * DU4 DR21 DD4 DR31 DU27 *

A= MA 152
D= AC 1051

1,725.00 MFG-DOUBLE WI
 28.00 PORCH-OPEN-FR

B= AC 1051
E= AC 1056

84.00 PORCH-OPEN-FR
 224.00 PORCH-ENCL-FR

C= AC 1064

240.00 DECK-WOOD

JOYNER JUANITA G
 4043 WEAVER RD
 L2 3.160 AC 3.16AC

Wilson County
 YR 2024 3742393647.000
 4043 WEAVER RD
 PIN: 3742 39 3647 000
 DISTRICT: 12 C/SW/EAST NASH SWAF

ACCOUNT#: 1124428
 NBHD: 8121 GARDNERS
 Plat Bk/Pg 43 298
 EXCD: NOTICE: 82 3/08/2024
 APPR: GRW APPR DT: 3/14/2023
 PAGE 3

Bldg No. 1 Exempt Code
 Imp Desc: DW MH-DOUBLE WIDE EYB: 1998 4043 WEAVER RD
 Grade : C C GRADE AYB: 1988 Finished Area: 1,725.00
 # of Units 7 Rms 3 Bedrms 2.0 Bathrms HBaths

 TYPE/CODE/DESCRIPTION PCT %CMP UNITS RATE STR# STR% SIZ% HGT% PER% COST

PROPERTY NOTES:

PERMIT NO	TYPE	DATE	BOOK	PAGE	DT	DATE	QS	SALES	PRICE
			1681	15	WD	7/31/1998	X		69,000
AMOUNT			1673	24	WD	6/02/1998	E		
			94E	283	WI	6/01/1994	E		
AMOUNT			1338	573	WD	11/06/1987			2,000

MISC CODE	DESC	UNITS	RATE	AYB	EYB	DT	PCT	%CMP	ADD.DEPR	PCT	VALUE	EXMPT
85 1143	SHELTER-OPEN 10 X 14	140.00	10.50	1988	1988	MFR	75.00	100			276	
							.00					
							.00					
							.00					

#	ZONE	TYPE/CODE	LAND QTY	LAND RATE	DPTH	DPT%	TOP%	LOC%	SIZ%	SHP%	OTH%	ADJ	FMV	EXMPT
---	------	-----------	----------	-----------	------	------	------	------	------	------	------	-----	-----	-------

