

JBMP HOLDINGS LLC
 4453 TARTTS MILL RD
 STOTT LAND 33.15AC
 33.150 AC

Wilson County
 YR 2024 3741681213.000
 4453 TARTTS MILL RD
 PIN: 3741 68 1213 000
 DISTRICT: 12 C/SW/EAST NASH SWAF

ACCOUNT#: 1126387
 NBHD: 8121 GARDNERS
 Plat Bk/Pg 15 8
 1.00 EXCD: APPR: KRC APPR DT: 5/26/2022
 NOTICE: 82 3/08/2024

Bldg No. 1
 Imp Desc: R1.0 SFR-1.0 STY EYB: 2001 4453 TARTTS MILL RD Exempt Code
 Grade : C+05 C+05 GRADE AYB: 1996 Finished Area: 1,654.00
 # of Units 5 Rms 3 Bedrms 2.0 Bathrms HBaths

LAND VALUE 125,666
 MISC VALUE 3,038
 BLDG VALUE 201,387
 TOTAL VALUE 330,091

TYPE/CODE/DESCRIPTION	PCT	%CMP	UNITS	RATE	STR#	STR%	SIZ%	HGT%	PER%	COST
AC 1051 PORCH-OPEN-FR	100		114	38.80			104.00			4,600
AC 1058 PORCH-SCR-FR	100		144	48.50		100.00	110.00			7,682
AC 1064 DECK-WOOD	100		208	24.95		100.00	100.00			5,189
MA 111 SFR-1.0 STY	100		1654	136.00	1.00		99.06			222,828
- AR 10 FORCED AIR HEAT W/ A100			1654	.00						0
- EW 02 VINYL SIDING	100		200	.00						0
- FC 52 LAMINATE/CARPET	100		1654	1.50						2,481
- FN 03 CONT WALL-BRICK	100		200	.00						0
- IF 01 DRYWALL	100		1654	.00						0
- RC 02 COMPOSITION SHINGLE	100		1654	.00						0
- RT 03 DOUBLE PITCH ROOF	100		1654	.00						0

RCN...			PCT COMPLETE		100	x				242,780
QUAL..	C+05				105.00	x				254,919
DEPR.. RC					21.00	-		53,532		53,532 T
--ASV...										201,387

PROPERTY NOTES:
 '08 LISTING-TWO WDD; STG; WINDOWS & DOOR
 SIDING REPLACED, FLOOR REPAIRED INCREASED EYB
 CHANGED EW FROM HARDBOARD TO VINYL
 FIXED DECK,FC,IF PER AUDIT 4'23 WBOR LISTING

PERMIT NO	TYPE	DATE	BOOK	PAGE	DT	DATE	QS	SALES	PRICE
			2964	328	WD	5/20/2022			395,000
AMOUNT			2912	499	WD	8/09/2021	E		
AMOUNT			2014	CDTH	CDTH	7/03/2014	E		
					@	10/25/1999	@		

MISC CODE	DESC	UNITS	RATE	AYB	EYB	DT	PCT	%CMP	ADD.DEPR	PCT	VALUE	EXMPT
81 1173	STG-FR 12 X 17	204.00	24.00	2007	2007	MAV	34.00	100			3,038	
							.00					
							.00					
							.00					

#	ZONE	TYPE/CODE	LAND QTY	LAND RATE	DPTH	DPT%	TOP%	LOC%	SIZ%	SHP%	OTH%	ADJ	FMV	EXMPT
1	AR	AC 5010	2.000	24,000.00		.00	.00	.00	100.00	.00	.00	.00	48,000	
2	AR	AC 5111	5.990	4,200.00		.00	.00	.00	98.00	.00	.00	98.00	24,654	
3	AR	AC 6111	25.160	2,150.00		.00	.00	.00	98.00	.00	.00	98.00	53,012	

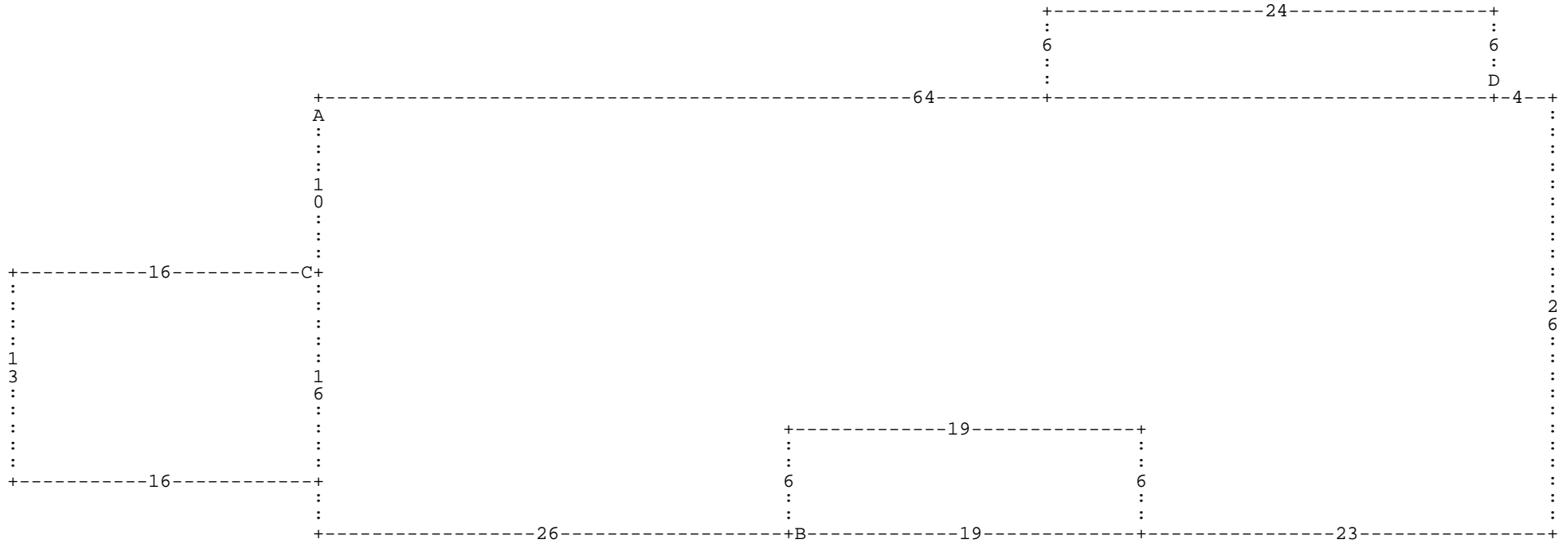

:A DD10 :C DL16 DD13 DR16 DU13 * DD16 DR26 :B DR19 DU6 DL19 DD6 * DU6 DR19 DD6 D
 R23 DU26 DL4 :D DU6 DL24 DD6 DR24 * DL64 *

A= MA 111
 D= AC 1058

1,654.00 SFR-1.0 STY
 144.00 PORCH-SCR-FR

B= AC 1051

114.00 PORCH-OPEN-FR

C= AC 1064

208.00 DECK-WOOD