

VIRGIL CORA LEE J (HEIRS)
 406 E WILSON ST
 L28 .114 AC 1.00LT

Wilson County
 YR 2024 3734894378.000
 406 E WILSON ST
 PIN: 3734 89 4378 000
 DISTRICT: 7 C/CIEC/FRTO-ELM

ACCOUNT#: 178853940
 NBHD: 8105 ELM_CITY_R-10
 Plat Bk/Pg 4 27 APPR: REV APPR DT: 4/06/2015
 EXCD: NOTICE: 82 3/08/2024

Bldg No. 1
 Imp Desc: R1.0 SFR-1.0 STY EYB: 1925 406 E WILSON ST Exempt Code
 Grade : C-10 C-10 GRADE AYB: 1925 Finished Area: 932.00
 # of Units 4 Rms 3 Bedrms 1.0 Bathrms HBaths

LAND VALUE 16,000
 MISC VALUE 1,915
 BLDG VALUE 36,834
 TOTAL VALUE 54,749

TYPE/CODE/DESCRIPTION	PCT	%CMP	UNITS	RATE	STR#	STR%	SIZ%	HGT%	PER%	COST
AC 1051 PORCH-OPEN-FR	100		156	38.80			102.00			6,173
AC 1051 PORCH-OPEN-FR	100		50	38.80			110.00			2,134
MA 111 SFR-1.0 STY	100		932	136.00	1.00		110.38			139,908
- AR 03 NO AC & FURNACE HEAT	100		932	6.75-						6,291-
- BT BT FULL BATH	100		1-	5500.00						5,500-
- EW 02 VINYL SIDING	100		136	.00						0
- FC 48 VINYL/CARPET	100		932	.00						0
- FN 02 CONT WALL-CONC BLOCK	100		136	.00						0
- IF 07 DRYWALL/PANELING	100		932	.00						0
- RC 02 COMPOSITION SHINGLE	100		932	.00						0
- RT 03 DOUBLE PITCH ROOF	100		932	.00						0

RCN...			PCT COMPLETE		100	x				136,424
QUAL..	C-10				90.00	x				122,781
DEPR.. RC					70.00	-		85,947		85,947 T
--ASV...										36,834

PROPERTY NOTES:	PERMIT NO	TYPE	DATE	BOOK	PAGE	DT	DATE	QS	SALES	PRICE
PERMIT CODE: R MO/YR: 071995 NOTE: 25000				1961	IOC	WD	10/25/1999	@		
	AMOUNT			323	392	WD	5/17/1961	X		
	AMOUNT						10/17/1946	X		

MISC CODE	DESC	UNITS	RATE	AYB	EYB	DT	PCT	%CMP	ADD.DEPR	PCT	VALUE	EXMPT
81	1173 STG-FR 14 X 16	224.00	24.00	1990	1990	MFR	75.00	100			947	
82	1173 STG-FR 10 X 12	120.00	24.00	1990	1990	MAV	65.00	100			968	
							.00					
							.00					

#	ZONE	TYPE/CODE	LAND QTY	LAND RATE	DPTH	DPT%	TOP%	LOC%	SIZ%	SHP%	OTH%	ADJ	FMV	EXMPT
1	R10	LT 0100	1.000	20,000.00		.00	.00	.00	80.00	.00	.00	80.00	16,000	

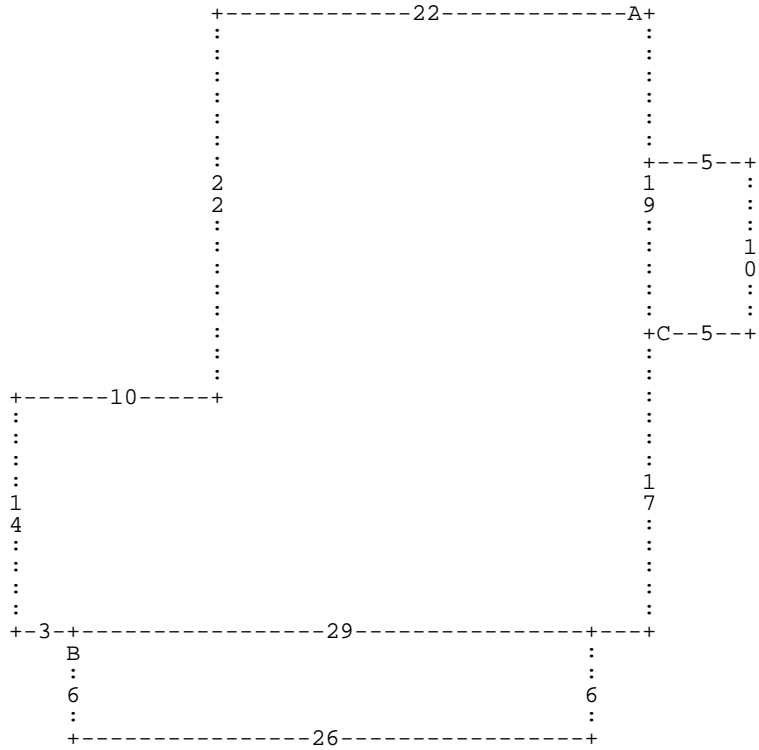

:A DL22 DD22 DL10 DD14 DR3 :B DD6 DR26 DU6 DL26 * DR29 DU17 :C DR5 DU10 DL5 DD10
 * DU19 *

A= MA 111

932.00 SFR-1.0 STY

B= AC 1051

156.00 PORCH-OPEN-FR

C= AC 1051

50.00 PORCH-OPEN-FR