

WARD CAROLYN JEAN  
205 EMMA ST  
.330 AC 1.00LT

Wilson County  
YR 2024 3734892149.000  
205 EMMA ST  
PIN: 3734 89 2149 000  
DISTRICT: 7 C/CIEC/FRTO-ELM

ACCOUNT#: 69950489  
NBHD: 8105 ELM\_CITY\_R-10  
Plat Bk/Pg  
EXCD: NOTICE: 82 3/08/2024  
APPR: REV APPR DT: 4/08/2015  
PAGE 1

Bldg No. 1  
Imp Desc: R1.0 SFR-1.0 STY  
Grade : C C GRADE  
# of Units 8 Rms 3 Bedrms 2.0 Bathrms HBaths  
EYB: 1990 205 EMMA ST  
AYB: 1976 Finished Area: 1,231.00  
Exempt Code  
LAND VALUE 20,000  
MISC VALUE 949  
BLDG VALUE 128,133  
TOTAL VALUE 149,082

TYPE/CODE/DESCRIPTION	PCT	%CMP	UNITS	RATE	STR#	STR%	SIZ%	HGT%	PER%	COST
AC 1031 CARPORT	100		192	27.90			100.00			5,356
AC 1051 PORCH-OPEN-FR	100		24	38.80			120.00			1,117
AC 1054 PORCH-SCR-MAS	100		288	45.80			97.00			12,794
AC 1071 UTILITY STG-FR	100		72	39.45			106.00			3,010
MA 111 SFR-1.0 STY	100		1231	136.00	1.00		104.75			175,368
- AR 10 FORCED AIR HEAT W/ A100	100		1231	.00						0
- EW 18 BRICK VENEER	100		164	35.00						5,740
- FC 06 CARPET	100		1231	.00						0
- FN 03 CONT WALL-BRICK	100		164	.00						0
- IF 01 DRYWALL	100		1231	.00						0
- RC 02 COMPOSITION SHINGLE	100		1231	.00						0
- RT 03 DOUBLE PITCH ROOF	100		1231	.00						0

RCN... PCT COMPLETE 100 x 203,385  
 QUAL.. C 100.00 x 203,385  
 DEPR.. RC 37.00 - 75,252 T  
 --ASV... 128,133

PROPERTY NOTES:  
ADDT & FBT N 08.  
PERMIT CODE: A MO/YR: 082006 NOTE: ADDT

PERMIT NO	TYPE	DATE	BOOK	PAGE	DT	DATE	QS	SALES	PRICE
BP00080128A		2/21/2008			@	10/25/1999	@		
AMOUNT		8,844	1532	396	WD	4/01/1994	U		
			1532	396	WD	4/01/1994	U		
AMOUNT			1171	9	WD	10/01/1979	X		31,500

MISC CODE	DESC	UNITS	RATE	AYB	EYB	DT	PCT	%CMP	ADD.DEPR	PCT	VALUE	EXMPT
81 1173	STORAGE 008 X 008	64.00	24.00	2006	2006	MAV	37.00	100			949	
							.00					
							.00					
							.00					

#	ZONE	TYPE/CODE	LAND QTY	LAND RATE	DPTH	DPT%	TOP%	LOC%	SIZ%	SHP%	OTH%	ADJ	FMV	EXMPT
1	R10	LT 0100	1.000	20,000.00		.00	.00	.00	100.00	.00	.00	.00	20,000	

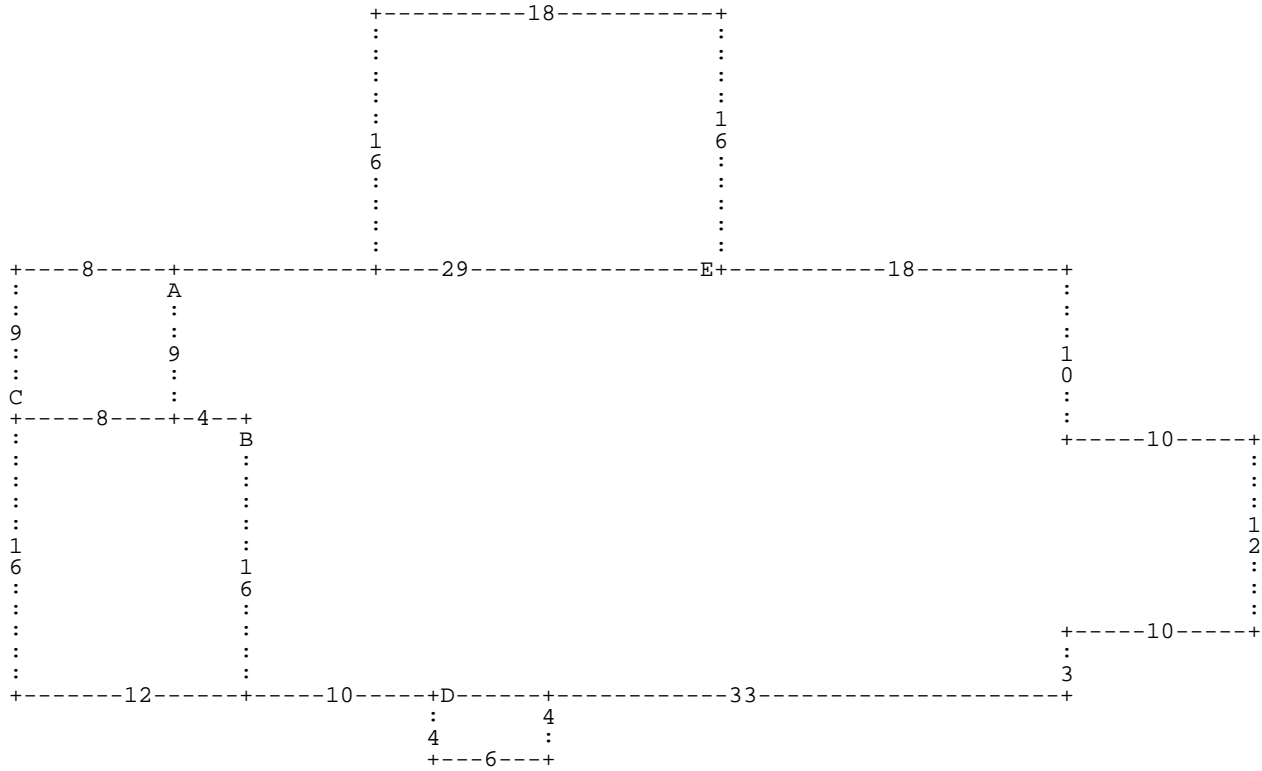

:A DD9 DR4 :B DD16 DL12 DU16 :C DU9 DR8 DD9 DL8 \* DR12 \* DD16 DR10 :D DR6 DD4 DL  
 6 DU4 \* DR33 DU3 DR10 DU12 DL10 DU10 DL18 :E DL18 DU16 DR18 DD16 \* DL29 \*

**A=** MA 111  
**D=** AC 1051

1,231.00 SFR-1.0 STY  
 24.00 PORCH-OPEN-FR

**B=** AC 1031  
**E=** AC 1054

192.00 CARPORT  
 288.00 PORCH-SCR-MAS

**C=** AC 1071

72.00 UTILITY STG-F