

JONES DOUGLAS JACKSON
 3700 VALLEYFIELD LN N
 L62S2 BUCKLIN SUB 1.00LT
 .400 AC

Wilson County
 N2 FOUND YR 2024 3724409668.000
 3700 VALLEYFIELD LN N
 PIN: 3724 40 9668 000
 DISTRICT: 31 C/CIWI-WILSON

ACCOUNT#: 1090872
 NBHD: 8421 BUCKLIN SUBD
 Plat Bk/Pg 36 139 APPR: KRC APPR DT: 6/27/2018
 EXCD: NOTICE: 82 3/08/2024

Bldg No. 1
 Imp Desc: R1.0 SFR-1.0 STY EYB: 2017 3700 VALLEYFIELD LN N Exempt Code
 Grade : C+05 C+05 GRADE AYB: 2017 Finished Area: 1,356.00
 # of Units 6 Rms 3 Bedrms 2.0 Bathrms HBaths

LAND VALUE 67,500
 MISC VALUE 5,559
 BLDG VALUE 195,698
 TOTAL VALUE 268,757

TYPE/CODE/DESCRIPTION	PCT	%CMP	UNITS	RATE	STR#	STR%	SIZ%	HGT%	PER%	COST
AC 1052 PORCH-OPEN-MAS	100		112	29.10		100.00	104.00			3,389
AC 1052 PORCH-OPEN-MAS	100		78	29.10		100.00	106.00			2,405
AC 1071 UTILITY STG-FR	100		44	39.45		100.00	88.00			1,527
MA 111 SFR-1.0 STY	100		1356	136.00	1.00		102.88			189,726
- AR 27 ELECTRIC HEAT PUMP	100		1356	.00						0
- EW 02 VINYL SIDING	100		162	.00						0
- FC 48 VINYL/CARPET	100		1356	.00						0
- FN 06 SPREAD FOOTING	100		162	5.30-						858-
- IF 48 CUSTOM INTERIOR	100		1356	.00						0
- RC 07 WOOD SHAKES/3D-SHING	100		1356	.00						0
- RT 03 DOUBLE PITCH ROOF	100		1356	.00						0

RCN...			PCT COMPLETE		100	x				196,189
QUAL..	C+05				105.00	x				205,997
DEPR.. RC					5.00	-		10,299		10,299 T
--ASV...										195,698

PROPERTY NOTES:
 2016 INFORMAL APPEAL
 ADDED STORAGE 4'19

PERMIT NO	TYPE	DATE	BOOK	PAGE	DT	DATE	QS	SALES	PRICE
BP17000393N		2/22/2017	2710	401	WD	8/08/2017		149,000	
AMOUNT	120,000		2689	816	WD	2/28/2017		20,000	
			2561	567	WD	1/10/2014	A	275,000	
AMOUNT			2456	873	WD	8/25/2011	A	335,000	

MISC CODE	DESC	UNITS	RATE	AYB	EYB	DT	PCT	%CMP	ADD.DEPR	PCT	VALUE	EXMPT
81 1173	STG-FR 10 X 28	280.00	24.00	2018	2018	MAV	12.00	100			5,559	
							.00					
							.00					
							.00					

#	ZONE	TYPE/CODE	LAND QTY	LAND RATE	DPTH	DPT%	TOP%	LOC%	SIZ%	SHP%	OTH%	ADJ	FMV	EXMPT
1	SR6	LT 0100	1.500	50,000.00		.00	.00	.00	90.00	.00	.00	90.00	67,500	

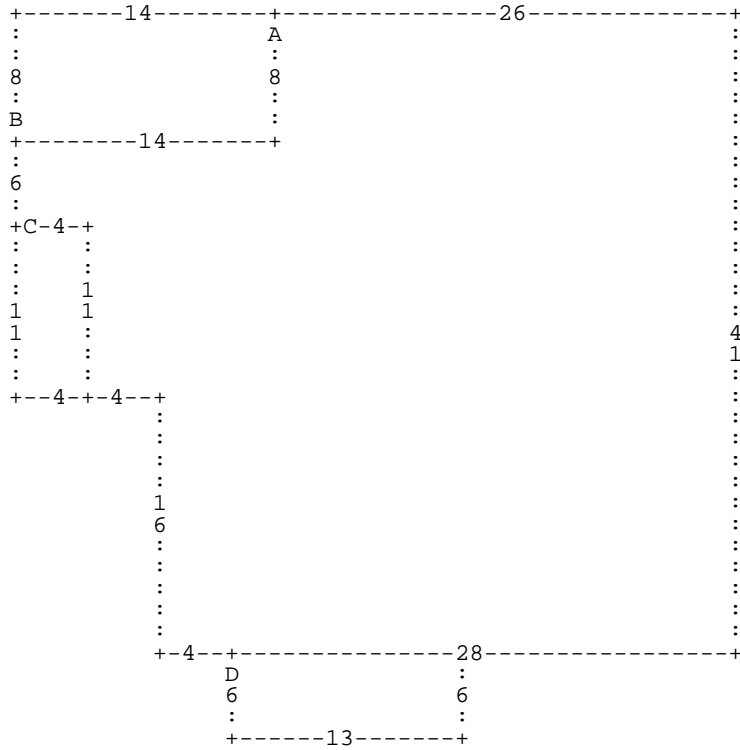

:A DD8 DL14 :B DU8 DR14 DD8 DL14 * DD6 :C DR4 DD11 DL4 DU11 * DR4 DD11 DR4 DD16
DR4 :D DD6 DR13 DU6 DL13 * DR28 DU41 DL26 *

A= MA 111
D= AC 1052

1,356.00 SFR-1.0 STY
78.00 PORCH-OPEN-MA

B= AC 1052

112.00 PORCH-OPEN-MA

C= AC 1071

44.00 UTILITY STG-F