

MELITON SANTOS MAXIMILIANO
 4710 WARD BLVD
 P121L122 1.00LT
 .312 AC

Wilson County
 YR 2024 3722706634.000
 4710 WARD BLVD
 PIN: 3722 70 6634 000
 DISTRICT: 31 C/CIWI-WILSON

ACCOUNT#: 1030153
 NBHD: 8251 REID_ST-ACADEMY_ST
 Plat Bk/Pg 5 10 APPR: REV APPR DT: 3/13/2015
 EXCD: NOTICE: 82 3/08/2024

Bldg No. 1
 Imp Desc: R1.0 SFR-1.0 STY EYB: 1973 4710 WARD BLVD Exempt Code
 Grade : C+05 C+05 GRADE AYB: 1963 Finished Area: 1,791.00
 # of Units 4 Rms 3 Bedrms 1.0 Bathrms 1 HBaths

LAND VALUE 20,250
 MISC VALUE 0
 BLDG VALUE 114,090
 TOTAL VALUE 134,340

TYPE/CODE/DESCRIPTION	PCT	%CMP	UNITS	RATE	STR#	STR%	SIZ%	HGT%	PER%	COST
AC 1031 CARPORT	100		225	27.90			100.00			6,277
AC 1053 STOOP-MAS	100		48	19.40			110.00			1,024
AC 1054 PORCH-SCR-MAS	100		166	45.80			102.00			7,754
AC 1071 UTILITY STG-FR	100		55	39.45		100.00	106.00			2,299
MA 111 SFR-1.0 STY	100		1791	136.00	1.00		97.75			238,095
- AR 27 ELECTRIC HEAT PUMP	100		1791	.00						0
- BT BT FULL BATH	100		1	5500.00						5,500
- BT HBT HALF BATH	100		1	3667.00						3,667
- EW 18 BRICK VENEER	100		200	35.00						7,000
- FC 03 HARDWOOD	100		1791	4.35						7,790
- FN 03 CONT WALL-BRICK	100		200	.00						0
- FP 3 1STY SNGL	100		2	5100.00						10,200
- IF 08 DRYWALL/PLASTER	100		1791	.00						0
- RC 02 COMPOSITION SHINGLE	100		1791	.00						0
- RT 03 DOUBLE PITCH ROOF	100		1791	.00						0

RCN...			PCT COMPLETE		100	x				278,606
QUAL..	C+05				105.00	x				292,537
DEPR..	RC				61.00	-		178,447		178,447 T
--ASV...										114,090

PROPERTY NOTES:	PERMIT NO	TYPE	DATE	BOOK	PAGE	DT	DATE	QS	SALES	PRICE
PERMIT CODE: N MO/YR: 072003 NOTE: NEW UNIT				2755	834	WD	8/29/2018	X	29,000	
PERMIT CODE: R MO/YR: 091996 NOTE: 2500				2748	681	STD	6/28/2018	P	18,000	
				2000E	398	WI	8/18/2000	E		
						@	10/25/1999	@		

MISC CODE	DESC	UNITS	RATE	AYB	EYB	DT	PCT	%CMP	ADD.DEPR	PCT	VALUE	EXMPT
							.00					
							.00					
							.00					
							.00					

#	ZONE	TYPE/CODE	LAND QTY	LAND RATE	DPTH	DPT%	TOP%	LOC%	SIZ%	SHP%	OTH%	ADJ	FMV	EXMPT
1	GR6	LT 0100	1.500	15,000.00	150	.00	.00	.00	90.00	.00	.00	90.00	20,250	

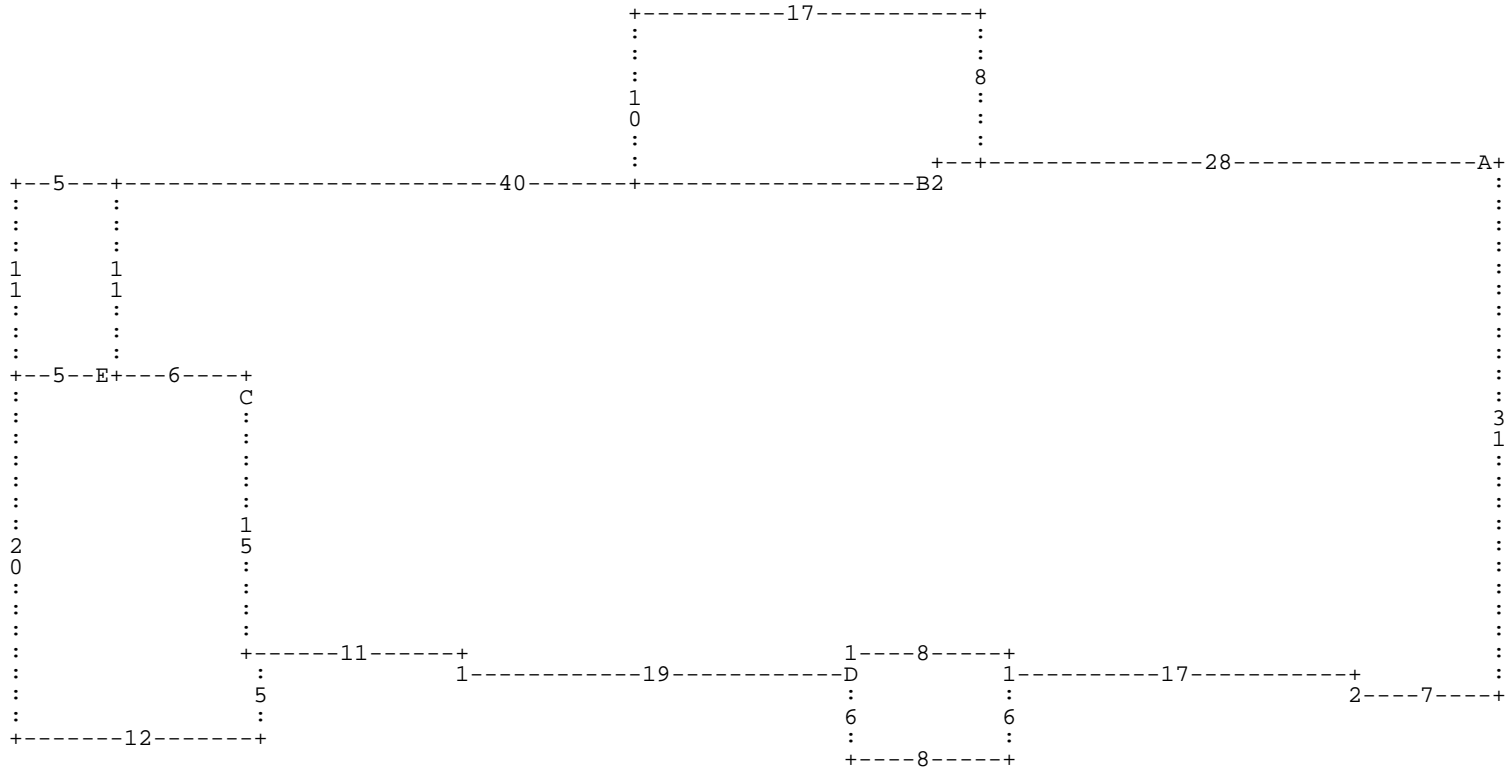

:A DL28 DD2 :B DL15 DU10 DR17 DD8 DL2 DD2 * DL40 DD11 :E DL5 DU11 DR5 DD11 * DR6
 :C DD15 DR1 DD5 DL12 DU20 DR11 * DD15 DR11 DD1 DR19 DU1 :D DD6 DR8 DU6 DL8 * DR
 8 DD1 DR17 DD2 DR7 DU31 *

A= MA 111 1,791.00 SFR-1.0 STY **B=** AC 1054 166.00 PORCH-SCR-MAS **C=** AC 1031 225.00 CARPORT
D= AC 1053 48.00 STOOP-MAS **E=** AC 1071 55.00 UTILITY STG-F