

MONTOYA LEONEL REYES  
 408 FLEMING ST NE  
 L7 AVALON PK ADDN 1.00LT  
 .366 AC

Wilson County  
 N2 FOUND YR 2024 3722469624.000  
 408 FLEMING ST NE  
 PIN: 3722 46 9624 000  
 DISTRICT: 31 C/CIWI-WILSON

ACCOUNT#: 1104361  
 NBHD: 8194 MONTCLAIR  
 Plat Bk/Pg 7 33  
 EXCD: NOTICE: 82 3/08/2024  
 APPR: REV APPR DT: 2/05/2015

Bldg No. 1  
 Imp Desc: R1.0 SFR-1.0 STY  
 Grade : C C GRADE  
 # of Units 4 Rms 3 Bedrms 1.0 Bathrms HBaths  
 EYB: 1991 408 FLEMING ST NE  
 AYB: 1958 Finished Area: 1,258.00  
 Exempt Code  
 LAND VALUE 18,000  
 MISC VALUE 0  
 BLDG VALUE 121,737  
 TOTAL VALUE 139,737

TYPE/CODE/DESCRIPTION	PCT	%CMP	UNITS	RATE	STR#	STR%	SIZ%	HGT%	PER%	COST
AC 1052 PORCH-OPEN-MAS	100		58	29.10			106.00			1,789
AC 1052 PORCH-OPEN-MAS	100		30	29.10			120.00			1,047
AC 1071 UTILITY STG-FR	100		42	39.45			110.00			1,822
MA 111 SFR-1.0 STY	100		1258	136.00	1.00		104.38			178,580
- AR 14 GAS PACK	100		1258	.00						0
- BT BT FULL BATH	100		1-	5500.00						5,500-
- EW 18 BRICK VENEER	100		156	35.00						5,460
- FC 49 HARDWOOD/VINYL	100		1258	3.25						4,088
- FN 03 CONT WALL-BRICK	100		156	.00						0
- IF 08 DRYWALL/PLASTER	100		1258	.00						0
- RC 02 COMPOSITION SHINGLE	100		1258	.00						0
- RT 03 DOUBLE PITCH ROOF	100		1258	.00						0
RCN...			PCT COMPLETE		100	x				187,286
QUAL..	C				100.00	x				187,287
DEPR..	RC				35.00	-		65,550		65,550 T
--ASV...										121,737

PROPERTY NOTES:

PERMIT NO	TYPE	DATE	BOOK	PAGE	DT	DATE	QS	SALES	PRICE
			2926	853	WD	10/15/2021			35,000
AMOUNT			2437	207	WD	2/14/2011	A		35,000
			2425	828	WD	11/03/2010			45,000
AMOUNT			2239	294	WD	3/28/2007			70,000

MISC CODE	DESC	UNITS	RATE	AYB	EYB	DT	PCT	%CMP	ADD.DEPR	PCT	VALUE	EXMPT
							.00					
							.00					
							.00					
							.00					

#	ZONE	TYPE/CODE	LAND	QTY	LAND RATE	DPTH	DPT%	TOP%	LOC%	SIZ%	SHP%	OTH%	ADJ	FMV	EXMPT
1	SR6	LT 0100		1.000	20,000.00	200	.00	.00	.00	90.00	.00	.00	90.00	18,000	

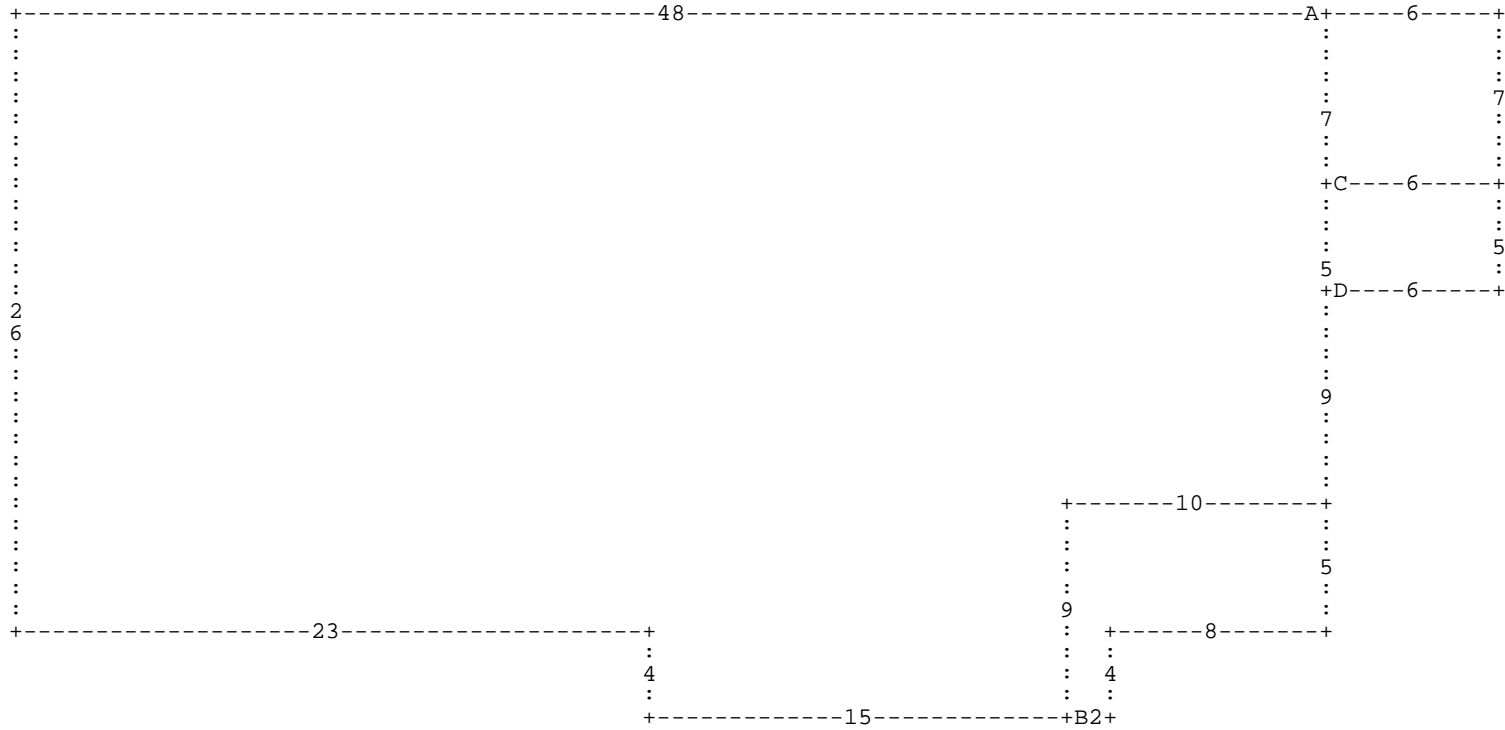

:A DL48 DD26 DR23 DD4 DR15 :B DR2 DU4 DR8 DU5 DL10 DD9 \* DU9 DR10 DU9 :D DR6 DU5  
 DL6 DD5 \* DU5 :C DR6 DU7 DL6 DD7 \* DU7 \*

A= MA 111  
 D= AC 1052

1,258.00 SFR-1.0 STY  
 30.00 PORCH-OPEN-MA

B= AC 1052

58.00 PORCH-OPEN-MA

C= AC 1071

42.00 UTILITY STG-F