

CAROLINA CAPITAL FUNDING LLC  
 213 CONE ST N  
 L2 .123 AC 1.00LT

Wilson County  
 YR 2024 3722152439.000  
 213 CONE ST N  
 PIN: 3722 15 2439 000  
 DISTRICT: 31 C/CIWI-WILSON

ACCOUNT#: 1110649  
 NBHD: 8374 WILSON\_CITY\_CENTRAL\_RA-6I  
 Plat Bk/Pg 2 250 APPR: REV APPR DT: 8/20/2014  
 EXCD: NOTICE: 82 3/08/2024

Bldg No. 1  
 Imp Desc: R1.0 SFR-1.0 STY EYB: 1975 213 CONE ST N Exempt Code LAND VALUE 29,750  
 Grade : C C GRADE AYB: 1950 Finished Area: 1,290.00 MISC VALUE 3,596  
 # of Units 3 Rms 2 Bedrms 1.0 Bathrms HBaths BLDG VALUE 83,282  
 TOTAL VALUE 116,628

TYPE/CODE/DESCRIPTION	PCT	%CMP	UNITS	RATE	STR#	STR%	SIZ%	HGT%	PER%	COST
AC 1052 PORCH-OPEN-MAS	100		24	29.10			120.00			838
AC 1056 PORCH-ENCL-FR	100		126	58.20	1.00	100.00	102.00			7,479
AC 1071 UTILITY STG-FR	100		108	39.45			104.00			4,431
MA 111 SFR-1.0 STY	100		1290	136.00	1.00		104.00			182,457
- AR 10 FORCED AIR HEAT W/ A100			1290	.00						0
- BT BT FULL BATH	100		1-	5500.00						5,500-
- EW 18 BRICK VENEER	100		164	35.00						5,740
- FC 20 HARDWOOD/CARPET	100		1290	2.00						2,580
- FN 03 CONT WALL-BRICK	100		164	.00						0
- FP 3 1STY SNGL	100		1	5100.00						5,100
- IF 01 DRYWALL	100		1290	.00						0
- RC 02 COMPOSITION SHINGLE	100		1290	.00						0
- RT 03 DOUBLE PITCH ROOF	100		1290	.00						0
RCN... PCT COMPLETE					100	x				203,125
QUAL.. C					100.00	x				203,125
DEPR.. RC					59.00	-		119,843		119,843 T
--ASV...										83,282

PROPERTY NOTES:

PERMIT NO	TYPE	DATE	BOOK	PAGE	DT	DATE	QS	SALES	PRICE
			2719	554	WD	10/20/2017	X		25,000
AMOUNT			2715	782	TD	9/21/2017	P		22,500
AMOUNT			2152	279	WD	1/11/2006	X		
					@	10/25/1999	@		

MISC CODE	DESC	UNITS	RATE	AYB	EYB	DT	PCT	%CMP	ADD.DEPR	PCT	VALUE	EXMPT
81 1131	CARPORT 020 X 020	400.00	26.75	1950	1975	MAV	65.00	100			3,596	
							.00					
							.00					
							.00					

#	ZONE	TYPE/CODE	LAND QTY	LAND RATE	DPTH	DPT%	TOP%	LOC%	SIZ%	SHP%	OTH%	ADJ	FMV	EXMPT
1	GR6	LT 0100	1.000	35,000.00	140	.00	.00	.00	85.00	.00	.00	85.00	29,750	

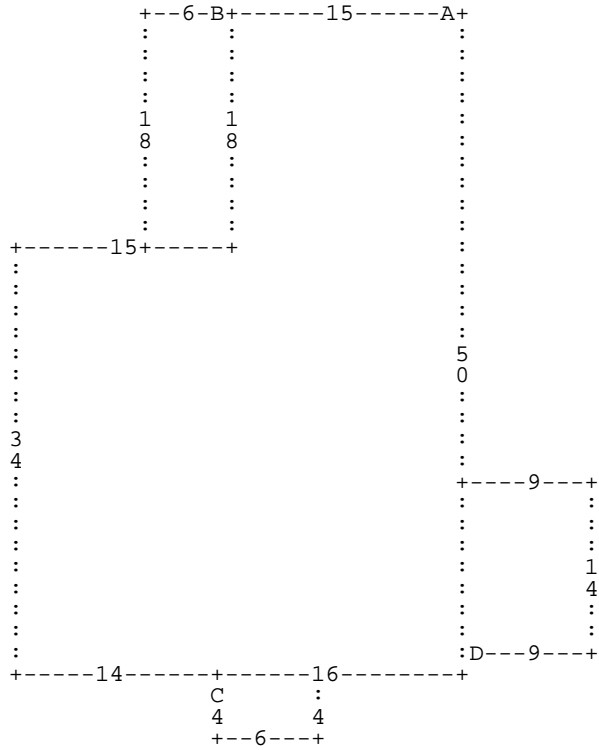

:A DL15 :B DL6 DD18 DR6 DU18 \* DD18 DL15 DD34 DR14 :C DD4 DR6 DU4 DL6 \* DR16 DU2  
 :D DR9 DU14 DL9 DD14 \* DU50 \*

A= MA 111  
 D= AC 1056

1,290.00 SFR-1.0 STY  
 126.00 PORCH-ENCL-FR

B= AC 1071

108.00 UTILITY STG-F

C= AC 1052

24.00 PORCH-OPEN-MA