

HOBBS RONNIE  
 1203 LINCOLN ST SE  
 BK-B L4 VICKSBURG MNR 1LT  
 .110 AC

Wilson County  
 YR 2024 3721652644.000  
 1203 LINCOLN ST SE  
 PIN: 3721 65 2644 000  
 DISTRICT: 31 C/CIWI-WILSON

ACCOUNT#: 1117310  
 NBHD: 8241 RAILROAD-WARD  
 Plat Bk/Pg 4 48  
 EXCD: NOTICE: 82 3/08/2024  
 APPR: REV APPR DT: 3/11/2015  
 PAGE 1

Bldg No. 1  
 Imp Desc: R1.0 SFR-1.0 STY  
 Grade : C C GRADE  
 # of Units 3 Rms 2 Bedrms 1.0 Bathrms HBaths

EYB: 1970 1203 LINCOLN ST SE  
 AYB: 1968 Finished Area: 983.00

Exempt Code  
 LAND VALUE 10,000  
 MISC VALUE 0  
 BLDG VALUE 52,844  
 TOTAL VALUE 62,844

TYPE/CODE/DESCRIPTION	PCT	%CMP	UNITS	RATE	STR#	STR%	SIZ%	HGT%	PER%	COST
AC 1053 STOOP-MAS	100		18	19.40			120.00			419
MA 111 SFR-1.0 STY	100		983	136.00	1.00		109.25			146,054
- AR N NO AC	100		983	3.35-						3,293-
- AR 07 ADEQUATE HEAT	100		983	.00						0
- BT BT FULL BATH	100		1-	5500.00						5,500-
- EW 18 BRICK VENEER	100		138	35.00						4,830
- FC 03 HARDWOOD	100		983	4.35						4,276
- FN 03 CONT WALL-BRICK	100		138	.00						0
- IF 08 DRYWALL/PLASTER	100		983	.00						0
- RC 02 COMPOSITION SHINGLE	100		983	.00						0
- RT 03 DOUBLE PITCH ROOF	100		983	.00						0
RCN...			PCT COMPLETE		100	x				146,786
QUAL..	C				100.00	x				146,786
DEPR.. RC					64.00	-		93,942		93,942 T
--ASV...										52,844

PROPERTY NOTES:

PERMIT NO	TYPE	DATE	BOOK	PAGE	DT	DATE	QS	SALES	PRICE
			2798	553	CD	8/27/2019	X		18,000
AMOUNT			2712	443	WD	8/25/2017	E		
AMOUNT			1018	384	@	10/25/1999	@		
					WD	4/03/1968	X		

MISC CODE	DESC	UNITS	RATE	AYB	EYB	DT	PCT	%CMP	ADD.DEPR	PCT	VALUE	EXMPT
							.00					
							.00					
							.00					
							.00					

#	ZONE	TYPE/CODE	LAND	QTY	LAND RATE	DPTH	DPT%	TOP%	LOC%	SIZ%	SHP%	OTH%	ADJ	FMV	EXMPT
1	GR6	LT 0100		1.000	10,000.00	100	.00	.00	.00	100.00	.00	.00	.00	10,000	

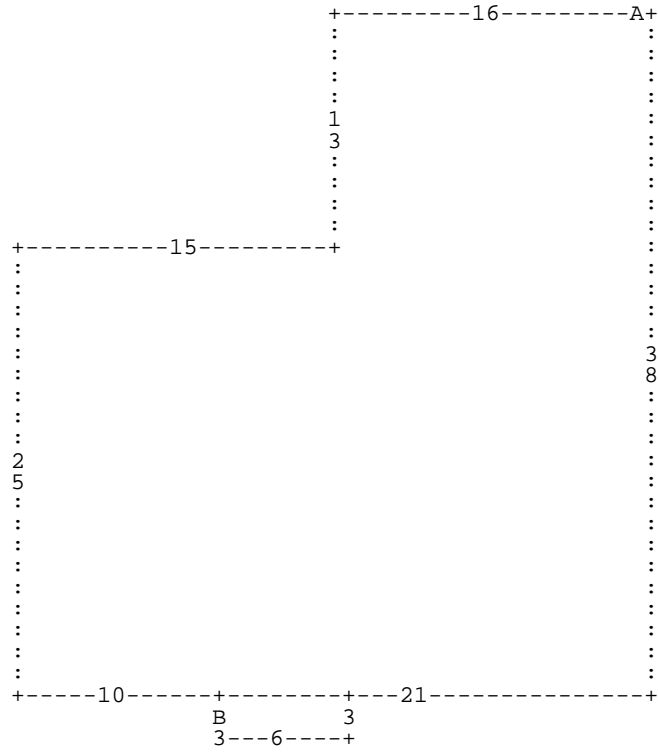

:A DL16 DD13 DL15 DD25 DR10 :B DD3 DR6 DU3 DL6 \* DR21 DU38 \*

A= MA 111

983.00 SFR-1.0 STY

B= AC 1053

18.00 STOOP-MAS