

CACERES RENTALS LLC
 602 GREEN ST E
 .201 AC 1.00LT

Wilson County
 YR 2024 3721592762.000
 602 GREEN ST E
 PIN: 3721 59 2762 000
 DISTRICT: 31 C/CIWI-WILSON

ACCOUNT#: 1121439
 NBHD: 8241 RAILROAD-WARD
 Plat Bk/Pg
 EXCD: NOTICE: 82 3/08/2024
 APPR: KRC APPR DT: 10/07/2021
 PAGE 1

Bldg No. 1
 Imp Desc: R2.0 SFR-UPTO 2.0 STY EYB: 1990 602 GREEN ST E Exempt Code
 Grade : C+05 C+05 GRADE AYB: 1935 Finished Area: 2,467.00
 # of Units 6 Rms 3 Bedrms 2.0 Bathrms HBaths
 LAND VALUE 10,000
 MISC VALUE 415
 BLDG VALUE 187,190
 TOTAL VALUE 197,605

TYPE/CODE/DESCRIPTION	PCT	%CMP	UNITS	RATE	STR#	STR%	SIZ%	HGT%	PER%	COST
AC 1053 STOOP-MAS	100		108	19.40			104.00			2,179
AC 1056 PORCH-ENCL-FR	100		105	58.20	1.00	100.00	104.00			6,355
MA 113 SFR-2.0 STY	100		1426	116.00	1.73		92.00			152,182
MA 113 (UPPER FLOORS)	100		1041	116.00	1.73	100.00	92.00			111,095
- AR 27 ELECTRIC HEAT PUMP	100		2467	.00						0
- EW 31 BRICK/VINYL COMBO	100		168	18.75						3,150
- FC 50 LAMINATE	100		2467	3.25						8,017
- FN 02 CONT WALL-CONC BLOCK	100		168	.00						0
- FP 1 NON-FUNCTIONAL	100		1	.00						0
- IF 08 DRYWALL/PLASTER	100		1426	.00						0
- RC 02 COMPOSITION SHINGLE	100		1426	.00						0
- RT 03 DOUBLE PITCH ROOF	100		1426	.00						0
RCN...			PCT COMPLETE		100	x				282,978
QUAL..	C+05				105.00	x				297,127
DEPR.. RC					37.00	-		109,937		109,937 T
--ASV...										187,190

PROPERTY NOTES:	PERMIT NO	TYPE	DATE	BOOK	PAGE	DT	DATE	QS	SALES	PRICE
HOME RENO'D 4'22 LAM FLRS,HEATPMP,RAISED GRADE,EYB 4'22				2873	1	WD	1/12/2021	X	75,000	
	AMOUNT			2855	335	WD	9/29/2020	X	37,000	
	AMOUNT			2793	600	WD	7/23/2019		30,000	
						@	10/25/1999	@		

MISC CODE	DESC	UNITS	RATE	AYB	EYB	DT	PCT	%CMP	ADD.DEPR	PCT	VALUE	EXMPT
81 1161	PATIO-CONC/MAS 14 X 20	280.00	7.60	1975	1975	MFR	75.00	100			415	
							.00					
							.00					
							.00					

#	ZONE	TYPE/CODE	LAND QTY	LAND RATE	DPTH	DPT%	TOP%	LOC%	SIZ%	SHP%	OTH%	ADJ	FMV	EXMPT
1	GR6	LT 0100	1.000	10,000.00	161	.00	.00	.00	100.00	.00	.00	.00	10,000	

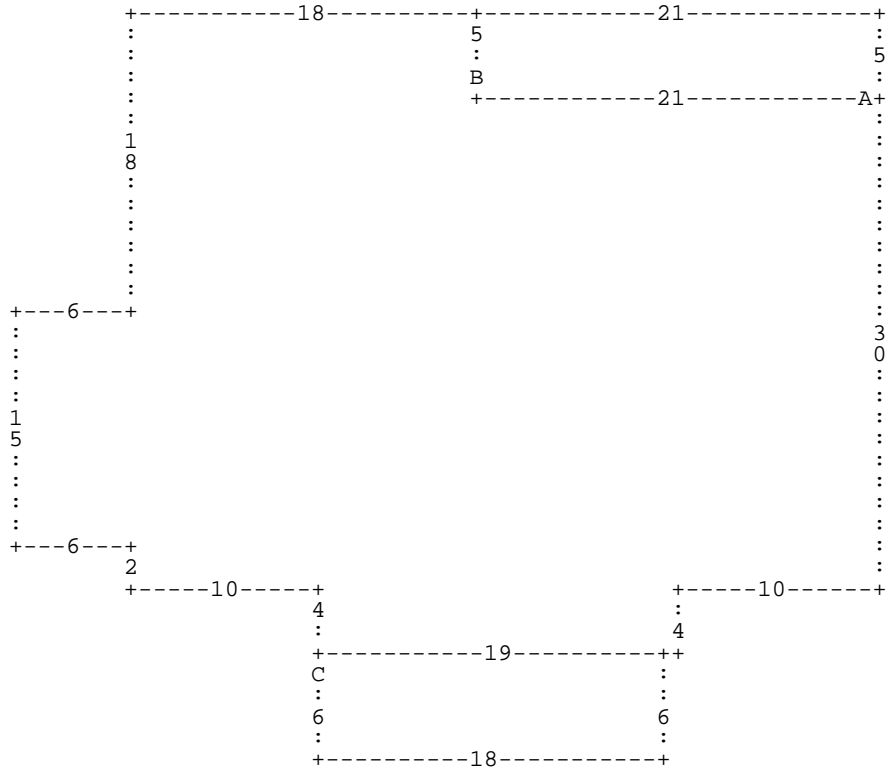

:A DL21 :B DU5 DR21 DD5 DL21 * DU5 DL18 DD18 DL6 DD15 DR6 DD2 DR10 DD4 :C DD6 DR
 18 DU6 DL18 * DR19 DU4 DR10 DU30 *

A= MA 113

1,426.00 SFR-2.0 STY

B= AC 1056

105.00 PORCH-ENCL-FR

C= AC 1053

108.00 STOOP-MAS