

MOORE BILLY GRAY (HEIRS)
 715 WOODROW ST S
 .142 AC 1.00LT

Wilson County
 N2 FOUND YR 2024 3721071271.000
 715 WOODROW ST S
 PIN: 3721 07 1271 000
 DISTRICT: 31 C/CIWI-WILSON

ACCOUNT#: 69932137
 NBHD: 8125 GOLDSBORO-SPRUCE_I-1
 Plat Bk/Pg EXCD: NOTICE: 82 3/08/2024
 APPR: RF APPR DT: 2/20/2018

Bldg No. 1
 Imp Desc: R1.0 SFR-1.0 STY EYB: 1940 715 WOODROW ST S Exempt Code LAND VALUE 3,717
 Grade : D-05 D-05 GRADE AYB: 1940 Finished Area: 1,273.00 MISC VALUE 0
 # of Units 1 4 Rms 3 Bedrms 1.0 Bathrms HBaths BLDG VALUE 14,303
 TOTAL VALUE 18,020

TYPE/CODE/DESCRIPTION	PCT	%CMP	UNITS	RATE	STR#	STR%	SIZ%	HGT%	PER%	COST
AC 1052 PORCH-OPEN-MAS	100		180	29.10			100.00			5,238
MA 111 SFR-1.0 STY	100		1273	136.00	1.00		104.38			180,709
- AR 03 NO AC & FURNACE HEAT	100		1273	6.75-						8,592-
- BT BT FULL BATH	100		1-	5500.00						5,500-
- EW 28 COMPOSITION WALL BOA	100		154	.00						0
- FC 54 CARPET/ASPHALT TILE	100		1273	1.25-						1,591-
- FN 02 CONT WALL-CONC BLOCK	100		154	.00						0
- IF 08 DRYWALL/PLASTER	100		1273	.00						0
- RC 02 COMPOSITION SHINGLE	100		1273	.00						0
- RT 03 DOUBLE PITCH ROOF	100		1273	.00						0
RCN...			PCT COMPLETE		100	x				170,264
QUAL..	D-05				70.00	x				119,184
DEPR.. RD					70.00	-		83,428		
ADDL.. AP			ADDT'L PHYSICAL DEPR		60.00	-		21,453		104,881 T
--ASV...										14,303

PROPERTY NOTES:
 RMVED OLD STGE BLD '05. 2012 INFO APPL. 2018 INFO APPL:
 ADDTNAL DEPR TO SFR.
 PERMIT CODE: R MO/YR: 051997 NOTE: 500

PERMIT NO	TYPE	DATE	BOOK	PAGE	DT	DATE	QS	SALES	PRICE
AMOUNT			1598	112	WD	8/07/1996	@		25,000
AMOUNT			339	266	WD	9/09/1947	X		

MISC CODE	DESC	UNITS	RATE	AYB	EYB	DT	PCT	%CMP	ADD.DEPR	PCT	VALUE	EXMPT
							.00					
							.00					
							.00					
							.00					

#	ZONE	TYPE/CODE	LAND QTY	LAND RATE	DPTH	DPT%	TOP%	LOC%	SIZ%	SHP%	OTH%	ADJ	FMV	EXMPT
1	NMX	SF 0600	6,195.000	.60	177	.00	.00	.00	100.00	.00	.00	.00	3,717	

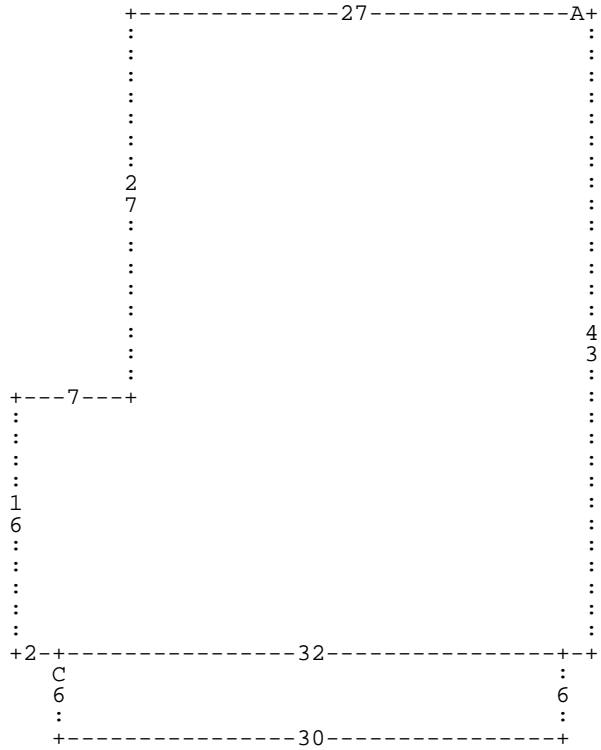

:A DL27 DD27 DL7 DD16 DR2 :C DD6 DR30 DU6 DL30 * DR32 DU43 *

A= MA 111

1,273.00 SFR-1.0 STY

C= AC 1052

180.00 PORCH-OPEN-MA