

DEBROW GENETHIA  
1207 MEADOW ST S  
.181 AC 1.00LT

Wilson County  
YR 2024 3721045764.000  
1207 MEADOW ST S  
PIN: 3721 04 5764 000  
DISTRICT: 31 C/CIWI-WILSON

ACCOUNT#: 1113805  
NBHD: 8126 GOLDSBORO-WARD\_EAST\_RA-6  
Plat Bk/Pg  
EXCD: NOTICE: 82 3/08/2024  
PAGE 1  
APPR: REV APPR DT: 1/13/2015

Bldg No. 1  
Imp Desc: R1.0A SFR-1.0 STY W/ADDN EYB: 1970 1207 MEADOW ST S Exempt Code  
Grade : C+05 C+05 GRADE AYB: 1954 Finished Area: 1,536.00  
# of Units 7 Rms 4 Bedrms 2.0 Bathrms HBaths  
LAND VALUE 15,000  
MISC VALUE 0  
BLDG VALUE 88,676  
TOTAL VALUE 103,676

| TYPE/CODE/DESCRIPTION           | PCT | %CMP | UNITS | RATE   | STR# | STR% | SIZ%   | HGT% | PER% | COST    |
|---------------------------------|-----|------|-------|--------|------|------|--------|------|------|---------|
| AC 1051 PORCH-OPEN-FR           | 100 |      | 176   | 38.80  |      |      | 102.00 |      |      | 6,965   |
| AC 1053 STOOP-MAS               | 100 |      | 20    | 19.40  |      |      | 120.00 |      |      | 465     |
| AC 1054 PORCH-SCR-MAS           | 100 |      | 96    | 45.80  |      |      | 104.00 |      |      | 4,572   |
| MA 111 SFR-1.0 STY              | 100 |      | 1248  | 136.00 | 1.00 |      | 104.75 |      |      | 177,790 |
| - AR 10 FORCED AIR HEAT W/ A100 |     |      | 1248  | .00    |      |      |        |      |      | 0       |
| - EW 18 BRICK VENEER            | 100 |      | 168   | 35.00  |      |      |        |      |      | 5,880   |
| - FC 20 HARDWOOD/CARPET         | 100 |      | 1248  | 2.00   |      |      |        |      |      | 2,496   |
| - FN 03 CONT WALL-BRICK         | 100 |      | 168   | .00    |      |      |        |      |      | 0       |
| - IF 01 DRYWALL                 | 100 |      | 1248  | .00    |      |      |        |      |      | 0       |
| - RC 02 COMPOSITION SHINGLE     | 100 |      | 1248  | .00    |      |      |        |      |      | 0       |
| - RT 04 HIP ROOF                | 100 |      | 1248  | .00    |      |      |        |      |      | 0       |
| MA 191 SFR-ADDT FR              | 100 |      | 288   | 102.00 | 1.00 |      | 124.00 |      |      | 36,426  |

RCN... PCT COMPLETE 100 x 234,594  
 QUAL.. C+05 105.00 x 246,323  
 DEPR.. RC 64.00 - 157,647 T 157,647  
 --ASV... 88,676

| PROPERTY NOTES:                 | PERMIT NO  | TYPE | DATE      | BOOK | PAGE | DT | DATE       | QS | SALES | PRICE  |
|---------------------------------|------------|------|-----------|------|------|----|------------|----|-------|--------|
| NVC REPLACEMENT PORTION OF ROOF | BP00090606 |      | 3/16/2009 | 2751 | 543  | WD | 7/26/2018  |    |       | 76,000 |
|                                 | AMOUNT     |      | 1,000     |      |      | @  | 10/25/1999 | @  |       |        |
|                                 | AMOUNT     |      |           | 1371 | 816  | WD | 4/28/1989  |    |       | 44,500 |
|                                 |            |      |           | 495  | 232  | WD | 3/05/1953  | X  |       | 2,200  |

| MISC CODE | DESC    | UNITS | RATE | AYB  | EYB  | DT  | PCT   | %CMP | ADD.DEPR | PCT | VALUE | EXMPT |
|-----------|---------|-------|------|------|------|-----|-------|------|----------|-----|-------|-------|
| 80 150    | STG-RTO | 1.00  |      | 2019 | 2019 | MAV | 10.00 | 100  |          |     |       |       |
|           |         |       |      |      |      |     | .00   |      |          |     |       |       |
|           |         |       |      |      |      |     | .00   |      |          |     |       |       |
|           |         |       |      |      |      |     | .00   |      |          |     |       |       |

| # | ZONE | TYPE/CODE | LAND QTY | LAND RATE | DPTH | DPT% | TOP% | LOC% | SIZ%   | SHP% | OTH% | ADJ | FMV    | EXMPT |
|---|------|-----------|----------|-----------|------|------|------|------|--------|------|------|-----|--------|-------|
| 1 | GR6  | LT 0100   | 1.000    | 15,000.00 | 120  | .00  | .00  | .00  | 100.00 | .00  | .00  | .00 | 15,000 |       |

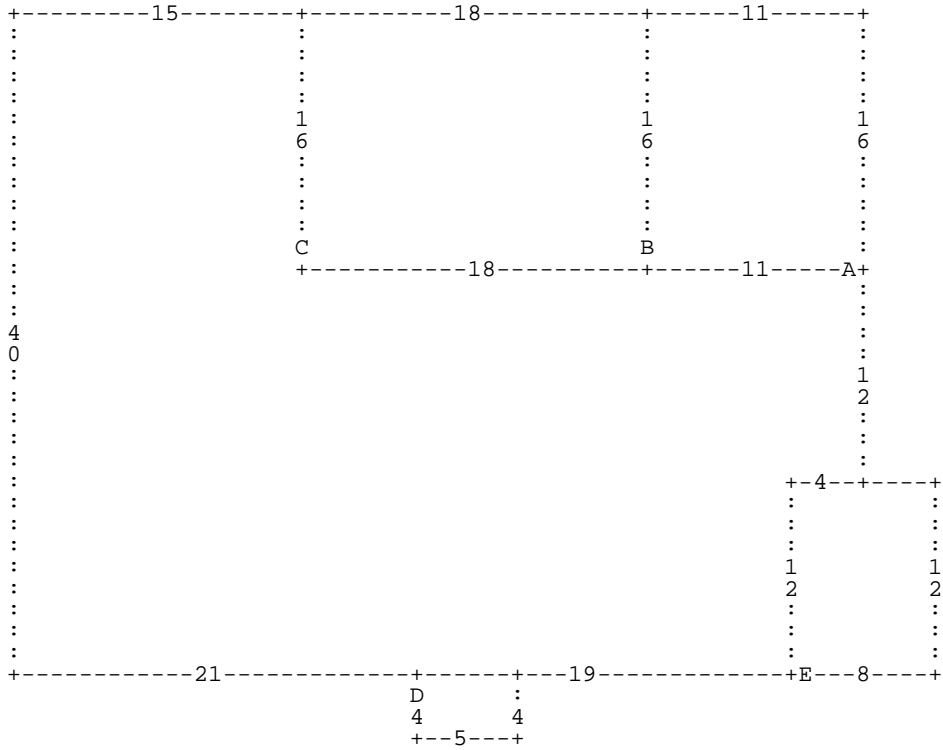

:A DL11 :B DU16 DR11 DD16 DL11 \* DL18 :C DU16 DR18 DD16 DL18 \* DU16 DL15 DD40 DR  
 21 :D DD4 DR5 DU4 DL5 \* DR19 :E DR8 DU12 DL8 DD12 \* DU12 DR4 DU12 \*

A= MA 111  
 D= AC 1053

1,248.00 SFR-1.0 STY  
 20.00 STOOP-MAS

B= AC 1051  
 E= AC 1054

176.00 PORCH-OPEN-FR  
 96.00 PORCH-SCR-MAS

C= MA 191

288.00 SFR-ADDT FR