

PARKER HORACE P
 4510 LAKE HILLS DR N
 L29S1 THE BLUFFS 1.00LT
 .400 AC

Wilson County
 YR 2024 3714932022.000
 4510 LAKE HILLS DR N
 PIN: 3714 93 2022 000
 DISTRICT: 31 C/CIWI-WILSON

ACCOUNT#: 1107737
 NBHD: 8316 THE BLUFFS-SOUTHWEST
 Plat Bk/Pg 33 53 APPR: REV APPR DT: 11/04/2014
 EXCD: NOTICE: 82 3/08/2024

Bldg No. 1
 Imp Desc: R1.5 SFR-UPTO 1.5 STY EYB: 2006 4510 LAKE HILLS DR N Exempt Code
 Grade : B-05 B-05 GRADE AYB: 2004 Finished Area: 2,637.00
 # of Units 7 Rms 4 Bedrms 3.0 Bathrms HBaths

LAND VALUE 60,000
 MISC VALUE 0
 BLDG VALUE 338,951
 TOTAL VALUE 398,951

TYPE/CODE/DESCRIPTION	PCT	%CMP	UNITS	RATE	STR#	STR%	SIZ%	HGT%	PER%	COST
AC 1021 GARAGE-ATT-FR	100		506	42.55			90.00			19,377
AC 1052 PORCH-OPEN-MAS	100		208	29.10			100.00			6,052
AC 1053 STOOP-MAS	100		348	19.40			97.00			6,548
MA 112 SFR-1.5 STY	100		1782	116.00	1.48		90.94			187,983
MA 112 (UPPER FLOORS)	100		855	116.00	1.48	100.00	90.94			90,193
- AR 10 FORCED AIR HEAT W/ A100			2637	.00						0
- BT BT FULL BATH	100		1	5500.00						5,500
- EW 31 BRICK/VINYL COMBO	100		214	18.75						4,012
- FC 20 HARDWOOD/CARPET	100		2637	2.00						5,274
- FN 02 CONT WALL-CONC BLOCK100			214	.00						0
- FP 2 PREFAB	100		1	3500.00						3,500
- IF 48 CUSTOM INTERIOR	100		1782	.00						0
- RC 02 COMPOSITION SHINGLE	100		1782	.00						0
- RT 03 DOUBLE PITCH ROOF	100		1782	.00						0

RCN...			PCT COMPLETE		100	x				328,439
QUAL..	B-05				120.00	x				394,128
DEPR.. RB					14.00	-		55,177		55,177 T
--ASV...										338,951

PROPERTY NOTES:	PERMIT NO	TYPE	DATE	BOOK	PAGE	DT	DATE	QS	SALES	PRICE
PERMIT CODE: N MO/YR: 102004 NOTE: 187830				2676	594	SWD	11/07/2016	I	195,000	
	AMOUNT			2655	385	STD	5/12/2016	P	294,500	
				2194	67	WD	8/11/2006		270,000	
	AMOUNT			2068	643	WD	11/08/2004		40,000	

MISC CODE	DESC	UNITS	RATE	AYB	EYB	DT	PCT	%CMP	ADD.DEPR	PCT	VALUE	EXMPT
							.00					
							.00					
							.00					
							.00					

#	ZONE	TYPE/CODE	LAND QTY	LAND RATE	DPTH	DPT%	TOP%	LOC%	SIZ%	SHP%	OTH%	ADJ	FMV	EXMPT
1	SR4	LT 0100	1.000	60,000.00		.00	.00	.00	100.00	.00	.00	.00	60,000	

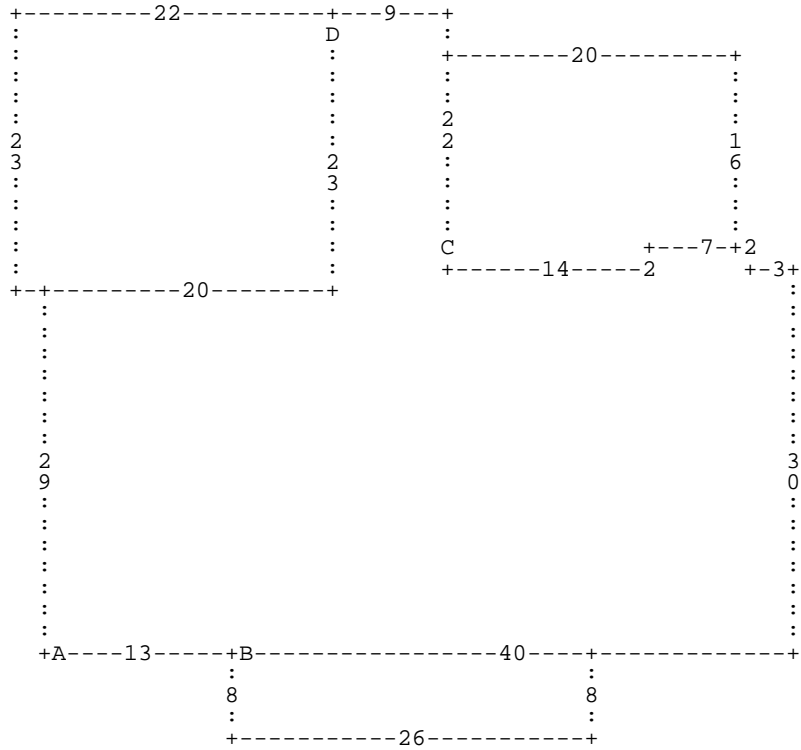

:A DR13 :B DR26 DD8 DL26 DU8 * DR40 DU30 DL3 DU2 DL7 DD2 DL14 :C DU18 DR20 DD16
 DL6 DD2 DL14 * DU22 DL9 :D DD23 DL22 DU23 DR22 * DD23 DL20 DD29 *

A= MA 112
 D= AC 1021

1,782.00 SFR-1.5 STY
 506.00 GARAGE-ATT-FR

B= AC 1052

208.00 PORCH-OPEN-MA

C= AC 1053

348.00 STOOP-MAS