

BURDICK CHRISTOPHER J
 3017 FIELDSTREAM DR N
 L16 FLDSTREAM FARM 1.00LT
 .270 AC

N2 FOUND YR 2024 **3713747911.000**
 3017 FIELDSTREAM DR N
 PIN: 3713 74 7911 000
DISTRICT: 31 C/CIWI-WILSON

Wilson County

ACCOUNT#: 1119484 **PAGE** 1
NBHD: 8113 FIELDSTREAM_FARM
 Plat Bk/Pg 17 45 **APPR:** KRC APPR DT: 4/25/2016
EXCD: NOTICE: 82 3/08/2024

Bldg No. 1
 Imp Desc: R1.5 SFR-UPTO 1.5 STY EYB: 2004 3017 FIELDSTREAM DR N Exempt Code **LAND VALUE** 45,000
 Grade : C C GRADE AYB: 1984 Finished Area: 1,963.00 **MISC VALUE** 0
 # of Units 4 Rms 2 Bedrms 2.0 Bathrms HBaths **BLDG VALUE** 191,689
TOTAL VALUE 236,689

TYPE/CODE/DESCRIPTION	PCT	%CMP	UNITS	RATE	STR#	STR%	SIZ%	HGT%	PER%	COST
AC 1053 STOOP-MAS	100		35	19.40			120.00			814
AC 1053 STOOP-MAS	100		20	19.40			120.00			465
AC 1064 DECK-WOOD	100		252	24.95			97.00			6,098
AC 1071 UTILITY STG-FR	100		54	39.45			106.00			2,258
MA 112 SFR-1.5 STY	100		1204	116.00	1.63		96.19			134,342
MA 112 (UPPER FLOORS)	100		759	116.00	1.63	100.00	96.19			84,689
- AR 10 FORCED AIR HEAT W/ A100			1963	.00						0
- EW 02 VINYL SIDING	100		142	.00						0
- FC 48 VINYL/CARPET	100		1963	.00						0
- FN 03 CONT WALL-BRICK	100		142	.00						0
- FP 3 1STY SNGL	100		1	5100.00						5,100
- IF 01 DRYWALL	100		1204	.00						0
- RC 02 COMPOSITION SHINGLE	100		1204	.00						0
- RT 03 DOUBLE PITCH ROOF	100		1204	.00						0

RCN...			PCT COMPLETE		100	x				233,766
QUAL..	C				100.00	x				233,766
DEPR.. RC					18.00	-		42,077		42,077 T
--ASV...										191,689

PROPERTY NOTES:	PERMIT NO	TYPE	DATE	BOOK	PAGE	DT	DATE	QS	SALES	PRICE
UAT 2 FUS 4 '09-GRW.	BP00081670R		6/26/2008	2835	715	WD	5/28/2020			160,000
CORRECTED SQFT PER WBOR LISTING	AMOUNT		6,000	2624	263	WD	8/11/2015			125,000
	AMOUNT			2144	686	WD	11/28/2005	X		94,500
						@	10/25/1999	@		

MISC CODE	DESC	UNITS	RATE	AYB	EYB	DT	PCT	%CMP	ADD.DEPR	PCT	VALUE	EXMPT
							.00					
							.00					
							.00					
							.00					

#	ZONE	TYPE/CODE	LAND QTY	LAND RATE	DPTH	DPT%	TOP%	LOC%	SIZ%	SHP%	OTH%	ADJ	FMV	EXMPT
1	SR6	LT 0100	1.000	45,000.00	139	.00	.00	.00	100.00	.00	.00	.00	45,000	

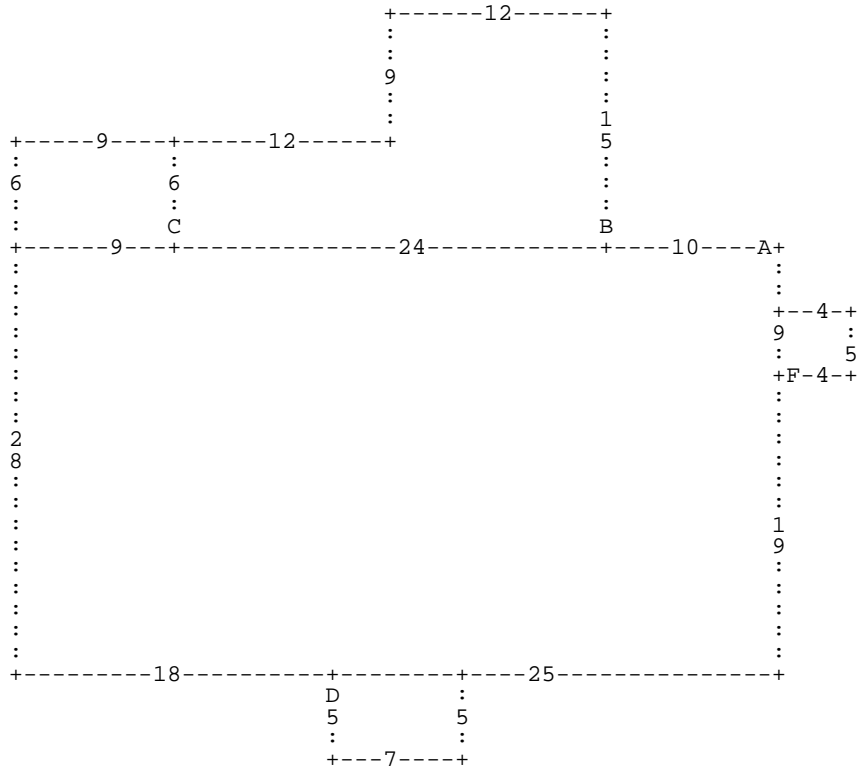

:A DL10 :B DU15 DL12 DD9 DL12 DD6 DR24 * DL24 :C DU6 DL9 DD6 DR9 * DL9 DD28 DR18
 :D DD5 DR7 DU5 DL7 * DR25 DU19 :F DR4 DU5 DL4 DD5 * DU9 *

A= MA 112
D= AC 1053

1,204.00 SFR-1.5 STY
 35.00 STOOP-MAS

B= AC 1064
F= AC 1053

252.00 DECK-WOOD
 20.00 STOOP-MAS

C= AC 1071

54.00 UTILITY STG-F