

HINNANT CAROLYN JOYNER
 2219 ARBOR RD N
 L32 SMITH PROP INC 1.00LT
 .337 AC

Wilson County
 YR 2024 3713709452.000
 2219 ARBOR RD N
 PIN: 3713 70 9452 000
 DISTRICT: 31 C/CIWI-WILSON

ACCOUNT#: 1009132
 NBHD: 8284 SMITH_PROPERTIES
 Plat Bk/Pg 13 62 APPR: REV APPR DT: 8/21/2014
 EXCD: NOTICE: 82 3/08/2024

Bldg No. 1
 Imp Desc: R1.0 SFR-1.0 STY EYB: 1980 2219 ARBOR RD N Exempt Code LAND VALUE 40,000
 Grade : C+10 C+10 GRADE AYB: 1975 Finished Area: 1,713.00 MISC VALUE 0
 # of Units 7 Rms 3 Bedrms 2.0 Bathrms HBaths BLDG VALUE 135,757
 TOTAL VALUE 175,757

TYPE/CODE/DESCRIPTION	PCT	%CMP	UNITS	RATE	STR#	STR%	SIZ%	HGT%	PER%	COST
AC 1031 CARPORT	100		247	27.90			100.00			6,891
AC 1052 PORCH-OPEN-MAS	100		156	29.10			102.00			4,630
AC 1054 PORCH-SCR-MAS	100		160	45.80			102.00			7,474
AC 1061 PATIO-CONC	100		144	7.50			64.00			691
AC 1064 DECK-WOOD	100		30	24.95			120.00			898
AC 1071 UTILITY STG-FR	100		112	39.45			104.00			4,595
AC 1071 UTILITY STG-FR	100		42	39.45			110.00			1,822
MA 111 SFR-1.0 STY	100		1713	136.00	1.00		98.50			229,473
- AR 10 FORCED AIR HEAT W/ A100	100		1713	.00						0
- EW 18 BRICK VENEER	100		192	35.00						6,720
- FC 48 VINYL/CARPET	100		1713	.00						0
- FN 03 CONT WALL-BRICK	100		192	.00						0
- FP 3 1STY SNGL	100		1	5100.00						5,100
- IF 30 DRYWALL/CUSTOM	100		1713	.00						0
- RC 02 COMPOSITION SHINGLE	100		1713	.00						0
- RT 03 DOUBLE PITCH ROOF	100		1713	.00						0

RCN... PCT COMPLETE 100 x 268,294
 QUAL.. C+10 110.00 x 295,123
 DEPR.. RC 54.00 - 159,366 T
 --ASV... 135,757

PROPERTY NOTES:

PERMIT NO	TYPE	DATE	BOOK	PAGE	DT	DATE	QS	SALES	PRICE
			2580	701	WD	7/17/2014			115,000
AMOUNT			2003E	244	WI	5/04/2003	E		
AMOUNT			1117	691	@	10/25/1999	@		
					WD	12/08/1975	X		46,500

MISC CODE	DESC	UNITS	RATE	AYB	EYB	DT	PCT	%CMP	ADD.DEPR	PCT	VALUE	EXMPT
							.00					
							.00					
							.00					
							.00					

#	ZONE	TYPE/CODE	LAND	QTY	LAND RATE	DPTH	DPT%	TOP%	LOC%	SIZ%	SHP%	OTH%	ADJ	FMV	EXMPT
1	SR4	LT 0100		1.000	40,000.00	150	.00	.00	.00	100.00	.00	.00	.00	40,000	

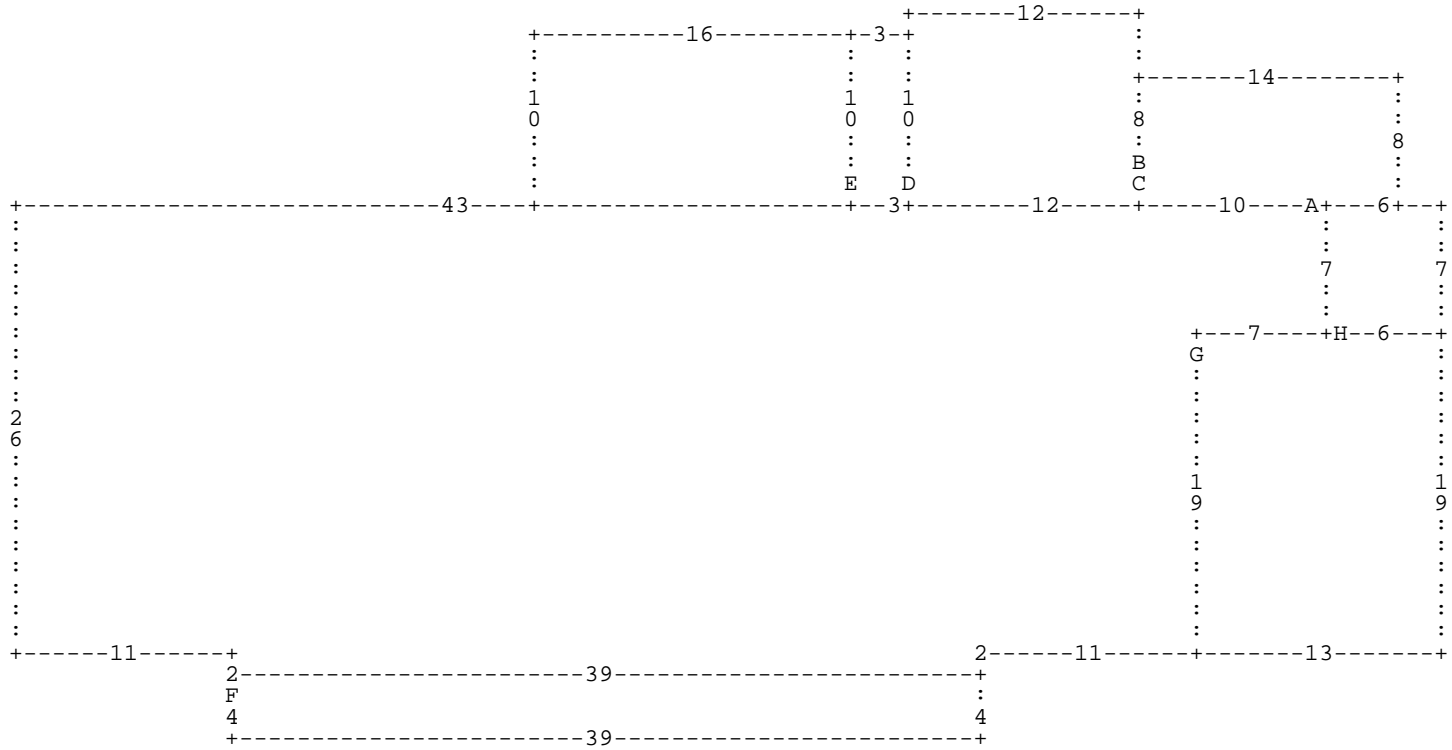

:A DL10 :B DU8 DR14 DD8 DL14 * :C DU12 DL12 DD12 DR12 * DL12 :D DU10 DL3 DD10 DR
 3 * DL3 :E DU10 DL16 DD10 DR16 * DL43 DD26 DR11 DD2 :F DD4 DR39 DU4 DL39 * DR39
 DU2 DR11 DU19 :G DD19 DR13 DU19 DL13 * DR7 :H DR6 DU7 DL6 DD7 * DU7 *

A= MA 111
D= AC 1064
G= AC 1031

1,713.00 SFR-1.0 STY
 30.00 DECK-WOOD
 247.00 CARPORT

B= AC 1071
E= AC 1054
H= AC 1071

112.00 UTILITY STG-F
 160.00 PORCH-SCR-MAS
 42.00 UTILITY STG-F

C= AC 1061
F= AC 1052

144.00 PATIO-CONC
 156.00 PORCH-OPEN-MA