

SUMMERLIN JAMES
 3401 GOLDFINCH LN NW
 L7S2 EAGLECHASE 1.00LT
 .299 AC

Wilson County
 YR 2024 3713445998.000
 3401 GOLDFINCH LN NW
 PIN: 3713 44 5998 000
 DISTRICT: 31 C/CIWI-WILSON

ACCOUNT#: 1104946
 NBHD: 8094 EAGLE_CHASE
 Plat Bk/Pg 23 250 APPR: REV APPR DT: 2/27/2015
 EXCD: NOTICE: 82 3/08/2024

Bldg No. 1
 Imp Desc: R1.0 SFR-1.0 STY EYB: 2004 3401 GOLDFINCH LN NW Exempt Code
 Grade : C+05 C+05 GRADE AYB: 1993 Finished Area: 1,278.00
 # of Units 5 Rms 3 Bedrms 2.0 Bathrms HBaths

LAND VALUE 35,000
 MISC VALUE 3,704
 BLDG VALUE 169,589
 TOTAL VALUE 208,293

TYPE/CODE/DESCRIPTION	PCT	%CMP	UNITS	RATE	STR#	STR%	SIZ%	HGT%	PER%	COST
AC 1031 CARPORT	100		420	27.90		100.00	94.00			11,014
AC 1052 PORCH-OPEN-MAS	100		20	29.10			120.00			698
AC 1071 UTILITY STG-FR	100		42	39.45			110.00			1,822
MA 111 SFR-1.0 STY	100		1278	136.00	1.00		104.00			180,760
- AR 27 ELECTRIC HEAT PUMP	100		1278	.00						0
- EW 02 VINYL SIDING	100		156	.00						0
- FC 48 VINYL/CARPET	100		1278	.00						0
- FN 06 SPREAD FOOTING	100		156	5.30-						826-
- FP 2 PREFAB	100		1	3500.00						3,500
- IF 01 DRYWALL	100		1278	.00						0
- RC 07 WOOD SHAKES/3D-SHING	100		1278	.00						0
- RT 03 DOUBLE PITCH ROOF	100		1278	.00						0
RCN...			PCT COMPLETE		100	x				196,968
QUAL..	C+05				105.00	x				206,815
DEPR.. RC					18.00	-		37,226		37,226 T
--ASV...										169,589

PROPERTY NOTES:
 STG '05
 PERMIT CODE: N MO/YR: 022004 NOTE: 5400

PERMIT NO	TYPE	DATE	BOOK	PAGE	DT	DATE	QS	SALES	PRICE
BP00082952A		11/21/2008	2620	412	SWD	7/10/2015	I	109,000	
AMOUNT		14,000	2607	302	STD	3/19/2015	P		
					@	10/25/1999	@		
AMOUNT			1532	785	WD	9/16/1994		82,500	

MISC CODE	DESC	UNITS	RATE	AYB	EYB	DT	PCT	%CMP	ADD.DEPR	PCT	VALUE	EXMPT
81 1173	STORAGE-FRAMED 12 X 24	288.00	24.00	2004	2004	MAV	43.00	100			3,704	
							.00					
							.00					
							.00					

#	ZONE	TYPE/CODE	LAND QTY	LAND RATE	DPTH	DPT%	TOP%	LOC%	SIZ%	SHP%	OTH%	ADJ	FMV	EXMPT
1	SR6	LT 0100	1.000	35,000.00	100	.00	.00	.00	100.00	.00	.00	.00	35,000	

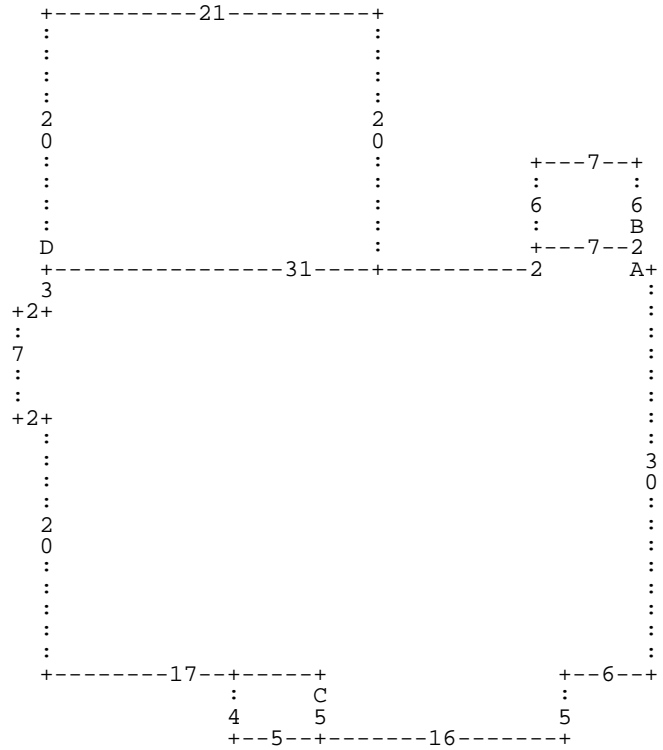

:A DL1 DU2 :B DU6 DL7 DD6 DR7 * DL7 DD2 DL31 :D DU20 DR21 DD20 DL21 * DD3 DL2 DD
7 DR2 DD20 DR17 :C DD4 DL5 DU4 DR5 * DD5 DR16 DU5 DR6 DU30 *

A= MA 111
D= AC 1031

1,278.00 SFR-1.0 STY
420.00 CARPORT

B= AC 1071

42.00 UTILITY STG-F

C= AC 1052

20.00 PORCH-OPEN-MA