

STRICKLAND TANYA M
 4102 LEXINGTON DR NW
 L56PH2S3 THE VILLAGE 1LT
 .220 AC

Wilson County
 N2 FOUND YR 2024 3713088701.000
 4102 LEXINGTON DR NW
 PIN: 3713 08 8701 000
 DISTRICT: 31 C/CIWI-WILSON

ACCOUNT#: 1131322
 NBHD: 8345 VILLAGE
 Plat Bk/Pg 29 174
 EXCD: NOTICE: 82 3/08/2024
 APPR: KRC APPR DT: 1/19/2021

Bldg No. 1 THE VILLAGE SUBD
 Imp Desc: R1.0 SFR-1.0 STY
 Grade : C+10 C+10 GRADE
 # of Units 5 Rms 3 Bedrms 2.0 Bathrms HBaths
 EYB: 2011 4102 LEXINGTON DR NW
 AYB: 2001 Finished Area: 1,406.00
 Exempt Code
 LAND VALUE 40,000
 MISC VALUE 0
 BLDG VALUE 225,073
 TOTAL VALUE 265,073

TYPE/CODE/DESCRIPTION	PCT	%CMP	UNITS	RATE	STR#	STR%	SIZ%	HGT%	PER%	COST
AC 1052 PORCH-OPEN-MAS	100		85	29.10			106.00			2,621
AC 1064 DECK-WOOD	100		144	24.95			102.00			3,664
AC 1071 UTILITY STG-FR	100		36	39.45			120.00			1,704
MA 111 SFR-1.0 STY	100		1406	136.00	1.00		102.19			195,403
- AR 10 FORCED AIR HEAT W/ A100			1406	.00						0
- EW 02 VINYL SIDING	100		168	.00						0
- FC 52 LAMINATE/CARPET	100		1406	1.50						2,109
- FN 03 CONT WALL-BRICK	100		168	.00						0
- FP 2 PREFAB	100		1	3500.00						3,500
- IF 30 DRYWALL/CUSTOM	100		1406	.00						0
- RC 02 COMPOSITION SHINGLE	100		1406	.00						0
- RT 03 DOUBLE PITCH ROOF	100		1406	.00						0

RCN...			PCT COMPLETE		100	x				209,001
QUAL..	C+10				110.00	x				229,901
DEPR..	RC				11.00	-		25,289		25,289 T
--ASV...	MKT 8345		VILLAGE		110.00	x				225,073

PROPERTY NOTES:
 FIXED AR,FC,IF,FN, PER AUDIT 4'21 WBOR LISTING 1/19/21
 PERMIT CODE: N MO/YR: 072001 NOTE: 66736

PERMIT NO	TYPE	DATE	BOOK	PAGE	DT	DATE	QS	SALES	PRICE
			3027	127	WD	8/03/2023		270,000	
AMOUNT			2873	87	WD	1/12/2021		182,000	
			2517	943	WD	1/31/2013		119,500	
AMOUNT			2129	633	WD	9/15/2005	X	124,000	

MISC CODE	DESC	UNITS	RATE	AYB	EYB	DT	PCT	%CMP	ADD.DEPR	PCT	VALUE	EXMPT
							.00					
							.00					
							.00					
							.00					

#	ZONE	TYPE/CODE	LAND QTY	LAND RATE	DPTH	DPT%	TOP%	LOC%	SIZ%	SHP%	OTH%	ADJ	FMV	EXMPT
1	SR6	LT 0100	1.000	40,000.00		.00	.00	.00	100.00	.00	.00	.00	40,000	

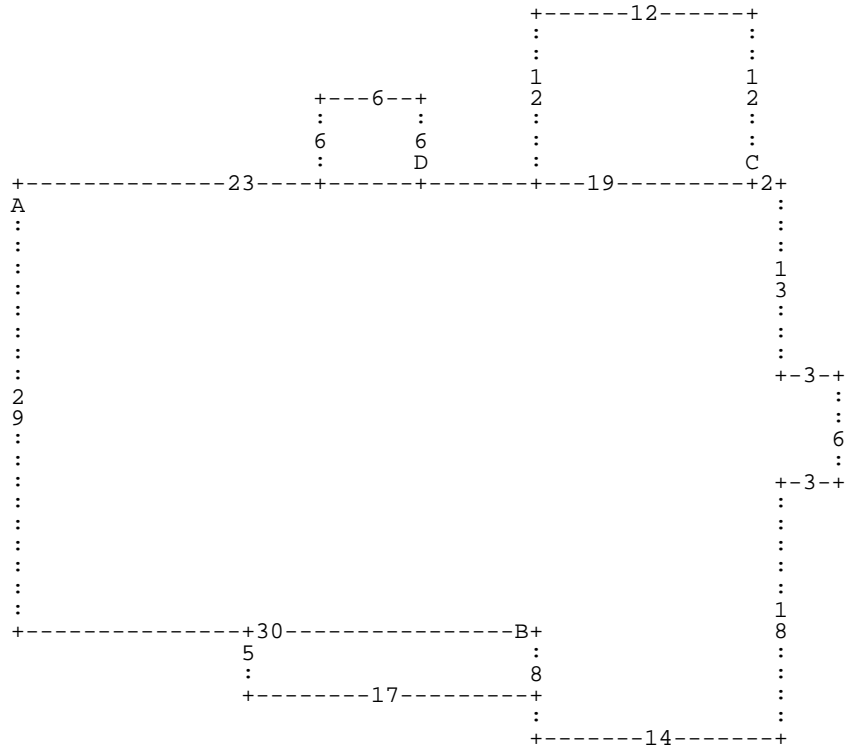

:A DD29 DR30 :B DL17 DD5 DR17 DU5 * DD8 DR14 DU18 DR3 DU6 DL3 DU13 DL2 :C DU12 D
L12 DD12 DR12 * DL19 :D DU6 DL6 DD6 DR6 * DL23 *

A= MA 111
D= AC 1071

1,406.00 SFR-1.0 STY
36.00 UTILITY STG-F

B= AC 1052

85.00 PORCH-OPEN-MA

C= AC 1064

144.00 DECK-WOOD