

FOSTER ALEXIS M  
 4324 NANTUCKET DR NW  
 L51APH1 THE VILLAGE 1LT  
 .220 AC

N2 FOUND YR 2024 3713088233.000  
 4324 NANTUCKET DR NW  
 PIN: 3713 08 8233 000  
**DISTRICT:** 31 C/CIWI-WILSON

Wilson County

**ACCOUNT#:** 1121606  
**NBHD:** 8345 VILLAGE  
 Plat Bk/Pg 27 130  
**EXCD:**

PAGE 1  
 APPR: REV APPR DT: 12/05/2014  
 NOTICE: 82 3/08/2024

Bldg No. 1  
 Imp Desc: R1.0 SFR-1.0 STY EYB: 2004 4324 NANTUCKET DR NW Exempt Code  
 Grade : C+05 C+05 GRADE AYB: 1999 Finished Area: 1,325.00  
 # of Units 5 Rms 3 Bedrms 2.0 Bathrms HBaths

**LAND VALUE** 40,000  
**MISC VALUE** 0  
**BLDG VALUE** 191,243  
**TOTAL VALUE** 231,243

TYPE/CODE/DESCRIPTION	PCT	%CMP	UNITS	RATE	STR#	STR%	SIZ%	HGT%	PER%	COST
AC 1052 PORCH-OPEN-MAS	100		24	29.10			120.00			838
AC 1064 DECK-WOOD	100		144	24.95			102.00			3,664
AC 1071 UTILITY STG-FR	100		30	39.45			120.00			1,420
MA 111 SFR-1.0 STY	100		1325	136.00	1.00		103.63			186,740
- AR 10 FORCED AIR HEAT W/ A100			1325	.00						0
- EW 02 VINYL SIDING	100		162	.00						0
- FC 03 HARDWOOD	100		1325	4.35						5,763
- FN 03 CONT WALL-BRICK	100		162	.00						0
- FP 2 PREFAB	100		1	3500.00						3,500
- IF 30 DRYWALL/CUSTOM	100		1325	.00						0
- RC 02 COMPOSITION SHINGLE	100		1325	.00						0
- RT 03 DOUBLE PITCH ROOF	100		1325	.00						0

RCN... PCT COMPLETE 100 x 201,925  
 QUAL.. C+05 105.00 x 212,021  
 DEPR.. RC 18.00 - 38,163 T  
 --ASV... MKT 8345 VILLAGE 110.00 x 191,243

PROPERTY NOTES:

PERMIT CODE: N MO/YR: 041999 NOTE: 62674

PERMIT NO	TYPE	DATE	BOOK	PAGE	DT	DATE	QS	SALES	PRICE
			2878	167	WD	2/09/2021		171,000	
AMOUNT			2309	729	WD	4/11/2008		128,000	
			2015	147	SWD	2/04/2004	I		
AMOUNT			2013	152	TD	1/20/2004	P		

MISC CODE	DESC	UNITS	RATE	AYB	EYB	DT	PCT	%CMP	ADD.DEPR	PCT	VALUE	EXMPT
							.00					
							.00					
							.00					
							.00					

#	ZONE	TYPE/CODE	LAND	QTY	LAND RATE	DPTH	DPT%	TOP%	LOC%	SIZ%	SHP%	OTH%	ADJ	FMV	EXMPT
1	SR6	LT 0100		1.000	40,000.00		.00	.00	.00	100.00	.00	.00	.00	40,000	

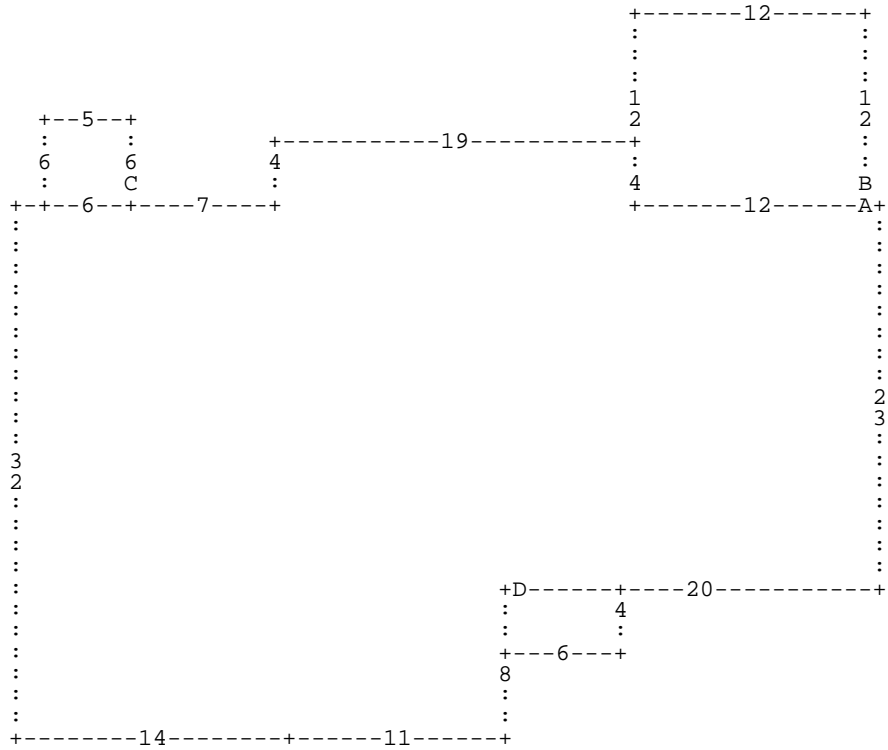

:A DL1 :B DU12 DL12 DD12 DR12 \* DL12 DU4 DL19 DD4 DL7 :C DU6 DL5 DD6 DR5 \* DL6 D  
 D32 DR14 DU1 DR11 DU8 :D DR6 DD4 DL6 DU4 \* DR20 DU23 \*

**A=** MA 111  
**D=** AC 1052

1,325.00 SFR-1.0 STY  
 24.00 PORCH-OPEN-MA

**B=** AC 1064

144.00 DECK-WOOD

**C=** AC 1071

30.00 UTILITY STG-F