

SHANEYFELT LESLEY GIBSON
 4610 STURBRIDGE DR NW
 L74PH3S3 THE VILLAGE 1LT
 .380 AC

Wilson County
 YR 2024 3713081653.000
 4610 STURBRIDGE DR NW
 PIN: 3713 08 1653 000
 DISTRICT: 31 C/CIWI-WILSON

ACCOUNT#: 1027958
 NBHD: 8345 VILLAGE
 Plat Bk/Pg 32 175
 EXCD: APPR: REV APPR DT: 12/08/2014
 NOTICE: 82 3/08/2024

Bldg No. 1
 Imp Desc: R1.0 SFR-1.0 STY EYB: 2010 4610 STURBRIDGE DR NW Exempt Code
 Grade : C+05 C+05 GRADE AYB: 2005 Finished Area: 1,418.00
 # of Units 5 Rms 3 Bedrms 2.0 Bathrms HBaths

LAND VALUE 40,000
 MISC VALUE 1,261
 BLDG VALUE 216,544
 TOTAL VALUE 257,805

TYPE/CODE/DESCRIPTION	PCT	%CMP	UNITS	RATE	STR#	STR%	SIZ%	HGT%	PER%	COST
AC 1052 PORCH-OPEN-MAS	100		114	29.10			104.00			3,450
AC 1064 DECK-WOOD	100		180	24.95			100.00			4,491
AC 1071 UTILITY STG-FR	100		36	39.45			120.00			1,704
MA 111 SFR-1.0 STY	100		1418	136.00	1.00		102.19			197,070
- AR 10 FORCED AIR HEAT W/ A100			1418	.00						0
- EW 02 VINYL SIDING	100		168	.00						0
- FC 20 HARDWOOD/CARPET	100		1418	2.00						2,836
- FN 02 CONT WALL-CONC BLOCK100			168	.00						0
- FP 2 PREFAB	100		1	3500.00						3,500
- IF 01 DRYWALL	100		1418	.00						0
- RC 07 WOOD SHAKES/3D-SHING100			1418	.00						0
- RT 03 DOUBLE PITCH ROOF	100		1418	.00						0
RCN...			PCT COMPLETE		100	x				213,051
QUAL..	C+05				105.00	x				223,703
DEPR..	RC				12.00	-		26,844		26,844 T
--ASV...	MKT 8345		VILLAGE		110.00	x				216,544

PROPERTY NOTES:	PERMIT NO	TYPE	DATE	BOOK	PAGE	DT	DATE	QS	SALES	PRICE
PERMIT CODE: N MO/YR: 082005 NOTE: 1380SF				2022	CDTH	CDTH	5/01/2022	E		
PERMIT CODE: MO/YR: NOTE: SFD				AMOUNT	2237	784	WD	3/20/2007		134,000
				AMOUNT	2146	409	WD	12/07/2005	X	128,500
					2100	667	WD	4/28/2005	A	383,000

MISC CODE	DESC	UNITS	RATE	AYB	EYB	DT	PCT	%CMP	ADD.DEPR	PCT	VALUE	EXMPT
81 1173	STG-FR 8 X 12	96.00	24.00	2004	2004	MAV	43.00	100			1,261	
							.00					
							.00					
							.00					

#	ZONE	TYPE/CODE	LAND QTY	LAND RATE	DPTH	DPT%	TOP%	LOC%	SIZ%	SHP%	OTH%	ADJ	FMV	EXMPT
1	SR6	LT 0100	1.000	40,000.00		.00	.00	.00	100.00	.00	.00	.00	40,000	

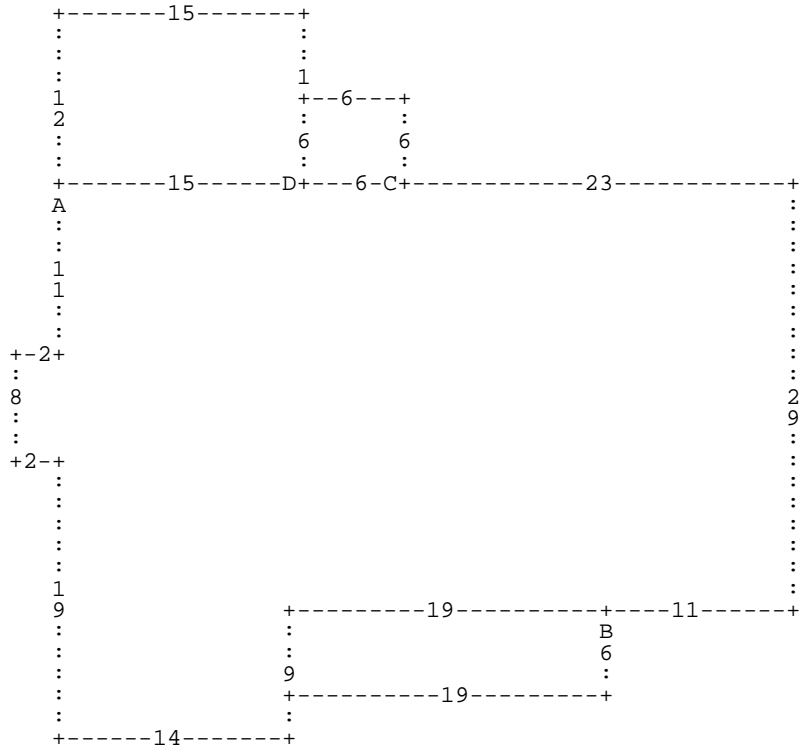

:A DD11 DL2 DD8 DR2 DD19 DR14 DU9 DR19 :B DD6 DL19 DU6 DR19 * DR11 DU29 DL23 :C
DL6 DU6 DR6 DD6 * DL6 :D DL15 DU12 DR15 DD12 * DL15 *

A= MA 111
D= AC 1064

1,418.00 SFR-1.0 STY
180.00 DECK-WOOD

B= AC 1052

114.00 PORCH-OPEN-MA

C= AC 1071

36.00 UTILITY STG-F