

ELLIS LINDA A
 3901 STARSHIP LN NW
 L16S5PH2 JETSTRM PK 1LT
 .200 AC

Wilson County
 YR 2024 3713058850.000
 3901 STARSHIP LN NW
 PIN: 3713 05 8850 000
 DISTRICT: 31 C/CIWI-WILSON

ACCOUNT#: 1112097
 NBHD: 8162 LANTERN_SQUARE
 Plat Bk/Pg 34 217 APPR: KRC APPR DT: 1/10/2018
 EXCD: NOTICE: 82 3/08/2024

Bldg No. 1
 Imp Desc: R1.0 SFR-1.0 STY EYB: 2017 3901 STARSHIP LN NW Exempt Code LAND VALUE 35,000
 Grade : C+05 C+05 GRADE AYB: 2017 Finished Area: 1,523.00 MISC VALUE 0
 # of Units 7 Rms 3 Bedrms 2.0 Bathrms HBaths BLDG VALUE 227,851
 TOTAL VALUE 262,851

TYPE/CODE/DESCRIPTION	PCT	%CMP	UNITS	RATE	STR#	STR%	SIZ%	HGT%	PER%	COST
AC 1021 GARAGE-ATT-FR	100		420	42.55		100.00	90.00			16,083
AC 1052 PORCH-OPEN-MAS	100		20	29.10		100.00	120.00			698
MA 111 SFR-1.0 STY	100		1523	136.00	1.00		100.94			209,074
- AR 27 ELECTRIC HEAT PUMP	100		1523	.00						0
- EW 02 VINYL SIDING	100		176	.00						0
- FC 48 VINYL/CARPET	100		1523	.00						0
- FN 06 SPREAD FOOTING	100		176	5.30-						932-
- FP 2 PREFAB	0		1	3500.00						3,500
- IF 01 DRYWALL	100		1523	.00						0
- RC 02 COMPOSITION SHINGLE	100		1523	.00						0
- RT 03 DOUBLE PITCH ROOF	100		1523	.00						0

RCN...			PCT COMPLETE		100	x				228,423
QUAL..		C+05			105.00	x				239,843
DEPR.. RC					5.00	-		11,992		11,992 T
--ASV...										227,851

PROPERTY NOTES:	PERMIT NO	TYPE	DATE	BOOK	PAGE	DT	DATE	QS	SALES	PRICE
COMP 4'18	BP17002082N		8/23/2017	2736	561	SWD	3/23/2018			160,000
	AMOUNT		79,700	2707	726	WD	7/19/2017	A		488,000
				2391	317	WD	12/21/2009	A		348,000
	AMOUNT			2294	567	WD	1/16/2008	A		385,500

MISC CODE	DESC	UNITS	RATE	AYB	EYB	DT	PCT	%CMP	ADD.DEPR	PCT	VALUE	EXMPT
							.00					
							.00					
							.00					
							.00					

#	ZONE	TYPE/CODE	LAND	QTY	LAND RATE	DPTH	DPT%	TOP%	LOC%	SIZ%	SHP%	OTH%	ADJ	FMV	EXMPT
1	GR6	LT 0100		1.000	35,000.00		.00	.00	.00	100.00	.00	.00	.00	35,000	

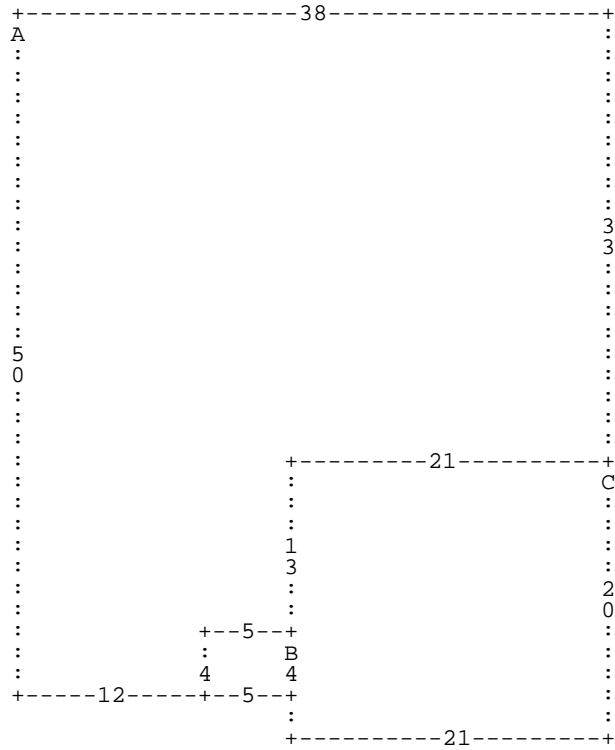

:A DD50 DR12 DU4 DR5 :B DD4 DL5 DU4 DR5 * DU13 DR21 :C DD20 DL21 DU20 DR21 * DU3
 3 DL38 *

A= MA 111

1,523.00 SFR-1.0 STY

B= AC 1052

20.00 PORCH-OPEN-MA

C= AC 1021

420.00 GARAGE-ATT-FR