

UPDEGRAVE ROBERT K
 302 RALEIGH ROAD PKWY W
 BK-A L6L7 WSTOVR 1.00LT
 .139 AC

Wilson County
 N2 FOUND YR 2024 3712938708.000
 302 RALEIGH ROAD PKWY W
 PIN: 3712 93 8708 000
 DISTRICT: 31 C/CIWI-WILSON

ACCOUNT#: 1113380
 NBHD: 8374 WILSON_CITY_CENTRAL_RA-6I
 Plat Bk/Pg 3 4 APPR: KRC APPR DT: 4/24/2023
 EXCD: NOTICE: 82 3/08/2024

Bldg No. 1
 Imp Desc: R1.0 SFR-1.0 STY EYB: 1990 302 RALEIGH ROAD PKWY W Exempt Code
 Grade : C+10 C+10 GRADE AYB: 1950 Finished Area: 1,280.00
 # of Units 10 Rms 3 Bedrms 2.0 Bathrms HBaths
 LAND VALUE 29,750
 MISC VALUE 2,212
 BLDG VALUE 141,149
 TOTAL VALUE 173,111

TYPE/CODE/DESCRIPTION	PCT	%CMP	UNITS	RATE	STR#	STR%	SIZ%	HGT%	PER%	COST
AC 1052 PORCH-OPEN-MAS	100		216	29.10			100.00			6,285
AC 1054 PORCH-SCR-MAS	100		40	45.80			110.00			2,015
MA 111 SFR-1.0 STY	100		1280	136.00	1.00		104.00			181,043
- AR 10 FORCED AIR HEAT W/ A100			1280	.00						0
- BT HBT HALF BATH	0		1	3667.00						3,667
- EW 01 WOOD FRAME	100		160	.00						0
- FC 03 HARDWOOD	100		1280	4.35						5,568
- FN 02 CONT WALL-CONC BLOCK100			160	.00						0
- FP 3 1STY SNGL	0		1	5100.00						5,100
- IF 08 DRYWALL/PLASTER	100		1280	.00						0
- RC 02 COMPOSITION SHINGLE	100		1280	.00						0
- RT 03 DOUBLE PITCH ROOF	100		1280	.00						0
RCN...			PCT COMPLETE		100	x				203,678
QUAL..	C+10				110.00	x				224,045
DEPR.. RC					37.00	-		82,896		82,896 T
--ASV...										141,149

PROPERTY NOTES:	PERMIT NO	TYPE	DATE	BOOK	PAGE	DT	DATE	QS	SALES	PRICE
UPDATED FP,FC,STORAGE,EYB PER AUDIT 4'24 WBOR LISTING				3006	792	WD	3/03/2023			175,000
	AMOUNT			2645	92	WD	2/12/2016			58,000
	AMOUNT			1676	646	@	10/25/1999 @			66,000
						WD	6/30/1998			

MISC CODE	DESC	UNITS	RATE	AYB	EYB	DT	PCT	%CMP	ADD.DEPR	PCT	VALUE	EXMPT
2 1173	STG-FR 10 X 10	100.00	24.00	2022	2022	MAV	4.00	100			2,212	
							.00					
							.00					
							.00					

#	ZONE	TYPE/CODE	LAND QTY	LAND RATE	DPTH	DPT%	TOP%	LOC%	SIZ%	SHP%	OTH%	ADJ	FMV	EXMPT
1	GR6	LT 0100	1.000	35,000.00	125	.00	.00	.00	85.00	.00	.00	85.00	29,750	

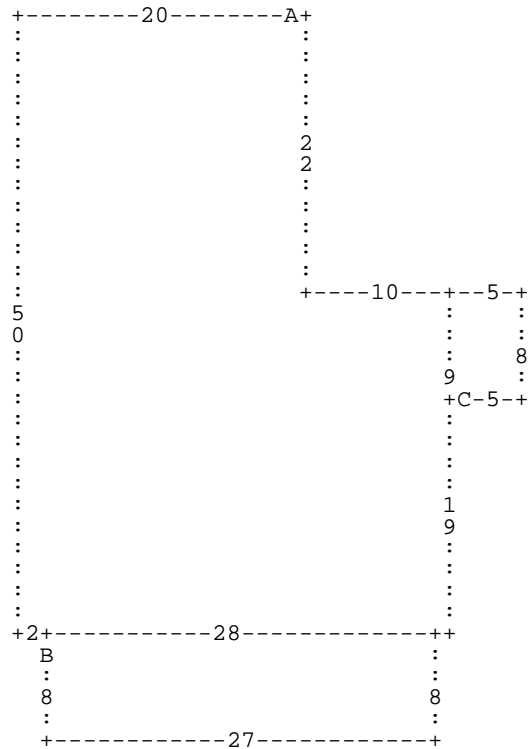

:A DL20 DD50 DR2 :B DD8 DR27 DU8 DL27 * DR28 DU19 :C DR5 DU8 DL5 DD8 * DU9 DL10
 DU22 *

A= MA 111 1,280.00 SFR-1.0 STY **B=** AC 1052 216.00 PORCH-OPEN-MA **C=** AC 1054 40.00 PORCH-SCR-MAS