

HASKINS MARSALIS  
 507 DEANS ST W  
 P15 WESTOVER SUB 1.00LT  
 .344 AC

Wilson County  
 N2 FOUND YR 2024 3712828450.000  
 507 DEANS ST W  
 PIN: 3712 82 8450 000  
 DISTRICT: 31 C/CIWI-WILSON

ACCOUNT#: 1127070  
 NBHD: 8137 HINES\_RA-8S  
 Plat Bk/Pg 4 78 APPR: KRC APPR DT: 1/06/2022  
 EXCD: NOTICE: 82 3/08/2024

Bldg No. 1  
 Imp Desc: R1.0A SFR-1.0 STY W/ADDN EYB: 2000 507 DEANS ST W Exempt Code  
 Grade : C+10 C+10 GRADE AYB: 1967 Finished Area: 1,908.00  
 # of Units 6 Rms 3 Bedrms 2.0 Bathrms HBaths

LAND VALUE 35,000  
 MISC VALUE 0  
 BLDG VALUE 231,690  
 TOTAL VALUE 266,690

TYPE/CODE/DESCRIPTION	PCT	%CMP	UNITS	RATE	STR#	STR%	SIZ%	HGT%	PER%	COST
AC 1053 STOOP-MAS	100		24	19.40			120.00			558
AC 1053 STOOP-MAS	100		60	19.40			106.00			1,233
MA 111 SFR-1.0 STY	100		1668	136.00	1.00		99.06			224,714
- AR 10 FORCED AIR HEAT W/ A100	100		1668	.00						0
- EW 18 BRICK VENEER	100		176	35.00						6,160
- FC 49 HARDWOOD/VINYL	100		1668	3.25						5,421
- FN 03 CONT WALL-BRICK	100		176	.00						0
- FP 3 1STY SNGL	100		1	5100.00						5,100
- IF 30 DRYWALL/CUSTOM	100		1668	.00						0
- RC 02 COMPOSITION SHINGLE	100		1668	.00						0
- RT 03 DOUBLE PITCH ROOF	100		1668	.00						0
MA 191 SFR-ADDT FR	100		240	102.00	1.00		124.00			30,355

RCN... PCT COMPLETE 100 x 273,541  
 QUAL.. C+10 110.00 x 300,895  
 DEPR.. RC 23.00 - 69,205 T  
 --ASV... 231,690

PROPERTY NOTES:	PERMIT NO	TYPE	DATE	BOOK	PAGE	DT	DATE	QS	SALES	PRICE
FIXED RMCNT,BATH PER AUDIT 4'22 WBOR LISTING				2962	50	WD	5/06/2022		249,500	
	AMOUNT			2940	489	WD	12/29/2021		125,000	
	AMOUNT			1400	35	@	10/25/1999	@		
						WD	6/29/1990	X	64,000	

MISC CODE	DESC	UNITS	RATE	AYB	EYB	DT	PCT	%CMP	ADD.DEPR	PCT	VALUE	EXMPT
							.00					
							.00					
							.00					
							.00					

#	ZONE	TYPE/CODE	LAND	QTY	LAND RATE	DPTH	DPT%	TOP%	LOC%	SIZ%	SHP%	OTH%	ADJ	FMV	EXMPT
1	SR6	LT 0100		1.000	35,000.00	150	.00	.00	.00	100.00	.00	.00	.00	35,000	

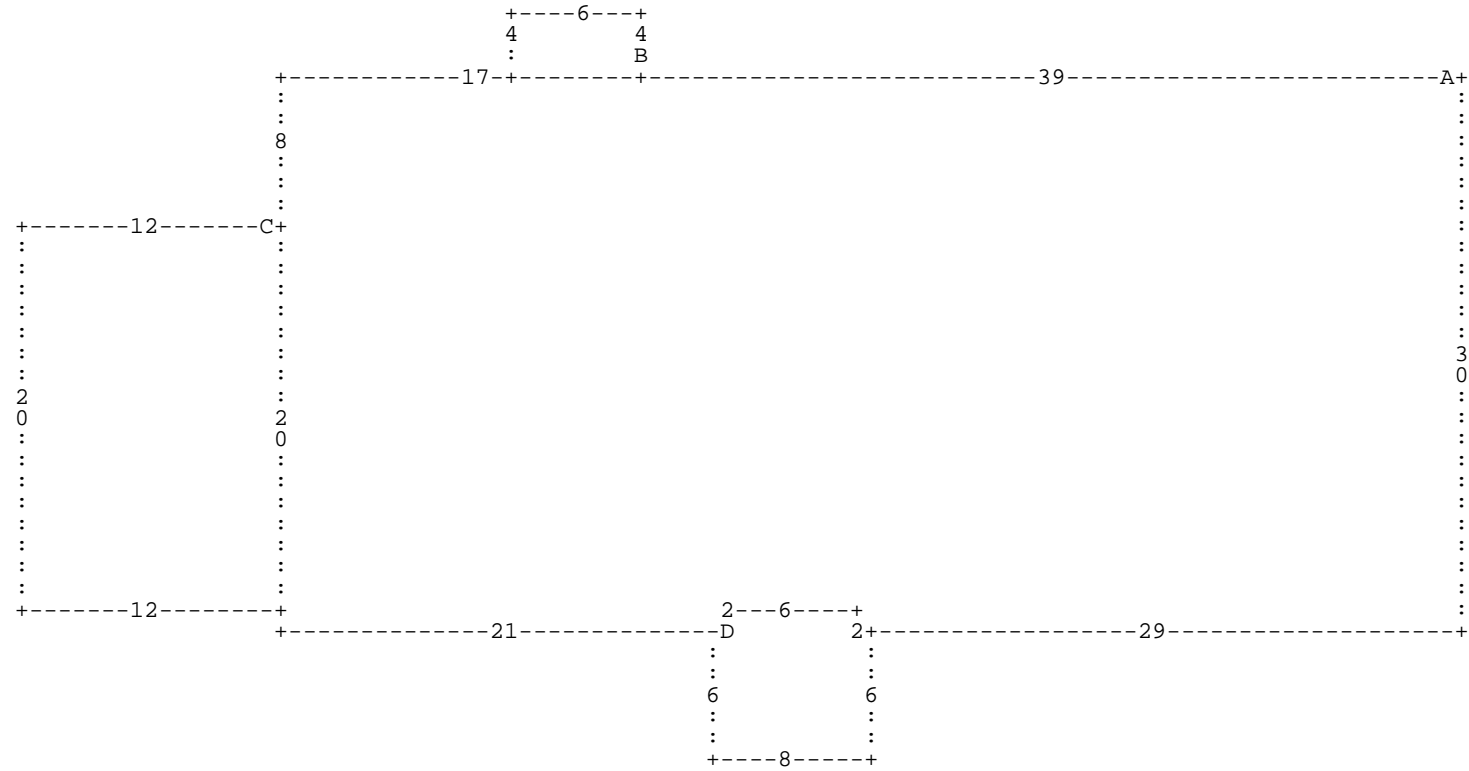

:A DL39 :B DU4 DL6 DD4 DR6 \* DL17 DD8 :C DL12 DD20 DR12 DU20 \* DD22 DR21 DU2 :D  
 DD2 DL1 DD6 DR8 DU6 DL1 DU2 DL6 \* DR6 DD2 DR29 DU30 \*

A= MA 111  
 D= AC 1053

1,668.00 SFR-1.0 STY  
 60.00 STOOP-MAS

B= AC 1053

24.00 STOOP-MAS

C= MA 191

240.00 SFR-ADDT FR