

WAINWRIGHT KEITH CARR
 507 CLYDE AVE NW
 L2&L5 ON PB 5-73 1.00LT
 .557 AC

N2 FOUND YR 2024 **3712768197.000**
 507 CLYDE AVE NW
 PIN: 3712 76 8197 000
DISTRICT: 31 C/CIWI-WILSON

Wilson County

ACCOUNT#: 1124348 **PAGE** 1
NBHD: 8152 KENAN_RA-12S
 Plat Bk/Pg 6 19 **APPR:** REV APPR DT: 7/08/2014
EXCD: NOTICE: 82 3/08/2024

Bldg No. 1
 Imp Desc: R1.0 SFR-1.0 STY EYB: 1991 507 CLYDE AVE NW Exempt Code **LAND VALUE** 60,000
 Grade : C+05 C+05 GRADE AYB: 1952 Finished Area: 1,782.00 **MISC VALUE** 1,044
 # of Units 5 Rms 3 Bedrms 2.0 Bathrms HBaths **BLDG VALUE** 178,863
TOTAL VALUE 239,907

TYPE/CODE/DESCRIPTION	PCT	%CMP	UNITS	RATE	STR#	STR%	SIZ%	HGT%	PER%	COST
AC 1053 STOOP-MAS	100		21	19.40			120.00			488
AC 1054 PORCH-SCR-MAS	100		190	45.80			100.00			8,702
AC 1061 PATIO-CONC	100		234	7.50			58.00			1,017
MA 111 SFR-1.0 STY	100		1782	136.00	1.00		97.75			236,899
- AR 27 ELECTRIC HEAT PUMP	100		1782	.00						0
- EW 18 BRICK VENEER	100		180	35.00						6,300
- FC 20 HARDWOOD/CARPET	100		1782	2.00						3,564
- FN 03 CONT WALL-BRICK	100		180	.00						0
- FP 3 1STY SNGL	100		1	5100.00						5,100
- IF 08 DRYWALL/PLASTER	100		1782	.00						0
- RC 02 COMPOSITION SHINGLE	100		1782	.00						0
- RT 03 DOUBLE PITCH ROOF	100		1782	.00						0

RCN... PCT COMPLETE 100 x 262,070
 QUAL.. C+05 105.00 x 275,173
 DEPR.. RC 35.00 - 96,310 T
 --ASV... 178,863

PROPERTY NOTES:

PERMIT CODE: A MO/YR: 022005 NOTE: ALT
 PERMIT CODE: N MO/YR: 012003 NOTE: HT PUMP

PERMIT NO	TYPE	DATE	BOOK	PAGE	DT	DATE	QS	SALES	PRICE
			2935	290	WD	12/01/2021			245,000
	AMOUNT		2712	793	WD	8/28/2017	E		
			2211	925	WD	11/09/2006			150,000
	AMOUNT		1903	470	WD	9/19/2002	X		137,500

MISC CODE	DESC	UNITS	RATE	AYB	EYB	DT	PCT	%CMP	ADD.DEPR	PCT	VALUE	EXMPT
81 1173	STORAGE 008 X 012	96.00	24.00	1970	1990	MAV	65.00	100			774	
82 1143	SHELTER-OPEN 6 X 12	72.00	10.50	1990	1990	MAV	65.00	100			270	
							.00					
							.00					

#	ZONE	TYPE/CODE	LAND QTY	LAND RATE	DPTH	DPT%	TOP%	LOC%	SIZ%	SHP%	OTH%	ADJ	FMV	EXMPT
1	SR4	LT 0100	2.000	40,000.00	275	.00	.00	.00	75.00	.00	.00	75.00	60,000	

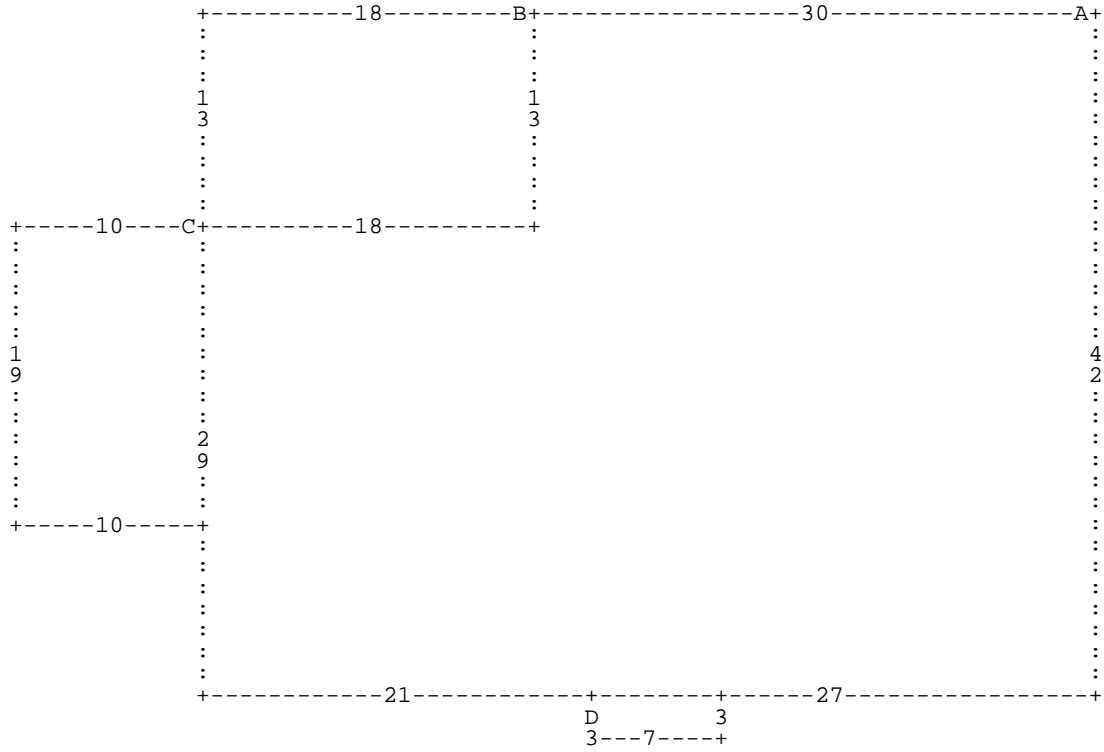

:A DL30 :B DL18 DD13 DR18 DU13 * DD13 DL18 :C DL10 DD19 DR10 DU19 * DD29 DR21 :D
 DD3 DR7 DU3 DL7 * DR27 DU42 *

A= MA 111
 D= AC 1053

1,782.00 SFR-1.0 STY
 21.00 STOOP-MAS

B= AC 1061

234.00 PATIO-CONC

C= AC 1054

190.00 PORCH-SCR-MAS