

ATKINSON GEORGE THOMAS
 1306 WOODSIDE DR W
 L53S1 WESTWOOD 1.00LT
 .497 AC

Wilson County
 N2 FOUND YR 2024 3712527911.000
 1306 WOODSIDE DR W
 PIN: 3712 52 7911 000
 DISTRICT: 31 C/CIWI-WILSON

ACCOUNT#: 70810200
 NBHD: 8365 WESTWOOD_WEST
 Plat Bk/Pg 7 72 APPR: KRC APPR DT: 1/02/2020
 EXCD: NOTICE: 82 3/08/2024

Bldg No. 1
 Imp Desc: R1.0 SFR-1.0 STY EYB: 1980 1306 WOODSIDE DR W Exempt Code
 Grade : C C GRADE AYB: 1960 Finished Area: 1,663.00
 # of Units 4 Rms 3 Bedrms 1.0 Bathrms 1 HBaths

LAND VALUE 37,050
 MISC VALUE 3,024
 BLDG VALUE 109,098
 TOTAL VALUE 149,172

| TYPE/CODE/DESCRIPTION | PCT | %CMP | UNITS | RATE | STR# | STR% | SIZ% | HGT% | PER% | COST |
|---------------------------------|-----|------|--------------|---------|--------|------|--------|---------|------|-----------|
| AC 1051 PORCH-OPEN-FR | 100 | | 80 | 38.80 | | | 106.00 | | | 3,290 |
| AC 1052 PORCH-OPEN-MAS | 100 | | 77 | 29.10 | | | 106.00 | | | 2,375 |
| AC 1053 STOOP-MAS | 100 | | 24 | 19.40 | | | 120.00 | | | 558 |
| MA 111 SFR-1.0 STY | 100 | | 1663 | 136.00 | 1.00 | | 99.06 | | | 224,041 |
| - AR 10 FORCED AIR HEAT W/ A100 | | | 1663 | .00 | | | | | | 0 |
| - BT BT FULL BATH | 100 | | 1- | 5500.00 | | | | | | 5,500- |
| - BT HBT HALF BATH | 100 | | 1 | 3667.00 | | | | | | 3,667 |
| - EW 03 BRICK/FRAME COMBO | 100 | | 194 | 18.75 | | | | | | 3,637 |
| - FC 48 VINYL/CARPET | 100 | | 1663 | .00 | | | | | | 0 |
| - FN 03 CONT WALL-BRICK | 100 | | 194 | .00 | | | | | | 0 |
| - FP 3 1STY SNGL | 100 | | 1 | 5100.00 | | | | | | 5,100 |
| - IF 08 DRYWALL/PLASTER | 100 | | 1663 | .00 | | | | | | 0 |
| - RC 02 COMPOSITION SHINGLE | 100 | | 1663 | .00 | | | | | | 0 |
| - RT 03 DOUBLE PITCH ROOF | 100 | | 1663 | .00 | | | | | | 0 |
| ----- | | | | | | | | | | |
| RCN... | | | PCT COMPLETE | | 100 | x | | | | 237,168 |
| QUAL.. | C | | | | 100.00 | x | | | | 237,168 |
| DEPR.. | RC | | | | 54.00 | - | | 128,070 | | 128,070 T |
| --ASV... | | | | | | | | | | 109,098 |

PROPERTY NOTES:
 HANDICAPPED RAMP NVC 4'18
 FIXED DECK,AR,FN,IF PER AUDIT 4'20 WBOR LISTING

| PERMIT NO | TYPE | DATE | BOOK | PAGE | DT | DATE | QS | SALES | PRICE |
|-------------|------|-----------|------|------|----|------------|----|-------|--------|
| BP17000874A | | 4/21/2017 | 2815 | 111 | WD | 12/20/2019 | | | 95,000 |
| AMOUNT | | 1,700 | 2385 | 714 | QD | 11/04/2009 | C | | |
| AMOUNT | | | 1872 | 661 | WD | 4/02/2002 | E | | |
| | | | | | @ | 10/25/1999 | @ | | |

| MISC CODE | DESC | UNITS | RATE | AYB | EYB | DT | PCT | %CMP | ADD.DEPR | PCT | VALUE | EXMPT |
|-----------|----------------|--------|-------|------|------|-----|-------|------|----------|-----|-------|-------|
| 81 1173 | STG-FR 20 X 20 | 400.00 | 24.00 | 1980 | 1980 | MAV | 65.00 | 100 | | | 3,024 | |
| | | | | | | | .00 | | | | | |
| | | | | | | | .00 | | | | | |
| | | | | | | | .00 | | | | | |

| # | ZONE | TYPE/CODE | LAND QTY | LAND RATE | DPTH | DPT% | TOP% | LOC% | SIZ% | SHP% | OTH% | ADJ | FMV | EXMPT |
|---|------|-----------|----------|-----------|------|------|------|------|-------|------|------|-------|--------|-------|
| 1 | SR4 | LT 0100 | 1.300 | 30,000.00 | 240 | .00 | .00 | .00 | 95.00 | .00 | .00 | 95.00 | 37,050 | |

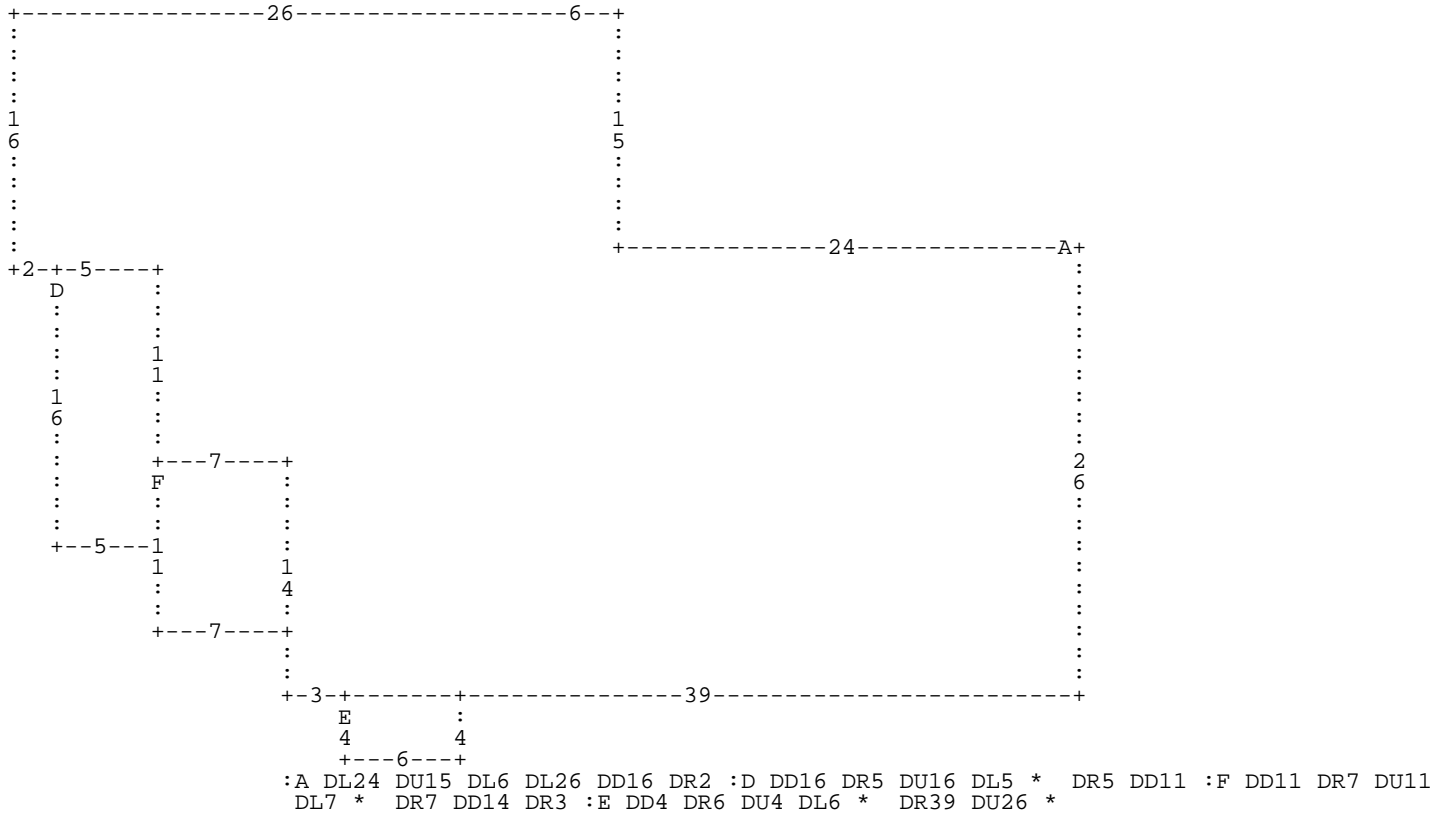

| | | | | | |
|-------------------|----------------------|-------------------|---------------------|-------------------|-----------------|
| A= MA 111 | 1,663.00 SFR-1.0 STY | D= AC 1051 | 80.00 PORCH-OPEN-FR | E= AC 1053 | 24.00 STOOP-MAS |
| F= AC 1052 | 77.00 PORCH-OPEN-MA | | | | |