

PEARSON QUEEN ESTHER
 509 SYCAMORE ST W
 L3S2 WESTWOOD 1.00LT
 .440 AC

Wilson County
 YR 2024 3712520022.000
 509 SYCAMORE ST W
 PIN: 3712 52 0022 000
 DISTRICT: 31 C/CIWI-WILSON

ACCOUNT#: 1127776
 NBHD: 8365 WESTWOOD_WEST
 Plat Bk/Pg 7 156
 EXCD: NOTICE: 82 3/08/2024
 APPR: KRC APPR DT: 8/08/2022
 PAGE 1

Bldg No. 1
 Imp Desc: R1.0 SFR-1.0 STY EYB: 1980 509 SYCAMORE ST W Exempt Code LAND VALUE 33,000
 Grade : C C GRADE AYB: 1959 Finished Area: 1,551.00 MISC VALUE 994
 # of Units 5 Rms 3 Bedrms 2.0 Bathrms HBaths BLDG VALUE 110,988
 TOTAL VALUE 144,982

TYPE/CODE/DESCRIPTION	PCT	%CMP	UNITS	RATE	STR#	STR%	SIZ%	HGT%	PER%	COST
AC 1031 CARPORT	100		252	27.90			97.00			6,819
AC 1052 PORCH-OPEN-MAS	100		20	29.10			120.00			698
AC 1053 STOOP-MAS	100		20	19.40			120.00			465
AC 1061 PATIO-CONC	100		358	7.50			55.00			1,476
AC 1071 UTILITY STG-FR	100		48	39.45			110.00			2,082
MA 111 SFR-1.0 STY	100		1551	136.00	1.00		100.31			211,588
- AR 10 FORCED AIR HEAT W/ A100	100		1551	.00						0
- EW 18 BRICK VENEER	100		180	35.00						6,300
- FC 03 HARDWOOD	100		1551	4.35						6,746
- FN 03 CONT WALL-BRICK	100		180	.00						0
- FP 3 1STY SNGL	100		1	5100.00						5,100
- IF 07 DRYWALL/PANELING	100		1551	.00						0
- RC 02 COMPOSITION SHINGLE	100		1551	.00						0
- RT 04 HIP ROOF	100		1551	.00						0

RCN...			PCT COMPLETE		100	x				241,274
QUAL..	C				100.00	x				241,275
DEPR..	RC				54.00	-		130,287		130,287 T
--ASV...										110,988

PROPERTY NOTES:	PERMIT NO	TYPE	DATE	BOOK	PAGE	DT	DATE	QS	SALES	PRICE
UPDATED PORCH,FC,IF PER AUDIT 4'23 WBOR LISTING				2975	766	SWD	7/29/2022			175,000
	AMOUNT			2018	CDTH	CDTH	1/01/2018	E		
	AMOUNT			1144	655	WD	9/29/1977	X		36,000

MISC CODE	DESC	UNITS	RATE	AYB	EYB	DT	PCT	%CMP	ADD.DEPR	PCT	VALUE	EXMPT
81 1173	STG-FR 8 X 8	64.00	24.00	2007	2007	MAV	34.00	100			994	
							.00					
							.00					
							.00					

#	ZONE	TYPE/CODE	LAND QTY	LAND RATE	DPH	DPT%	TOP%	LOC%	SIZ%	SHP%	OTH%	ADJ	FMV	EXMPT
1	SR4	LT 0100	1.100	30,000.00	199	.00	.00	.00	100.00	.00	.00	.00	33,000	

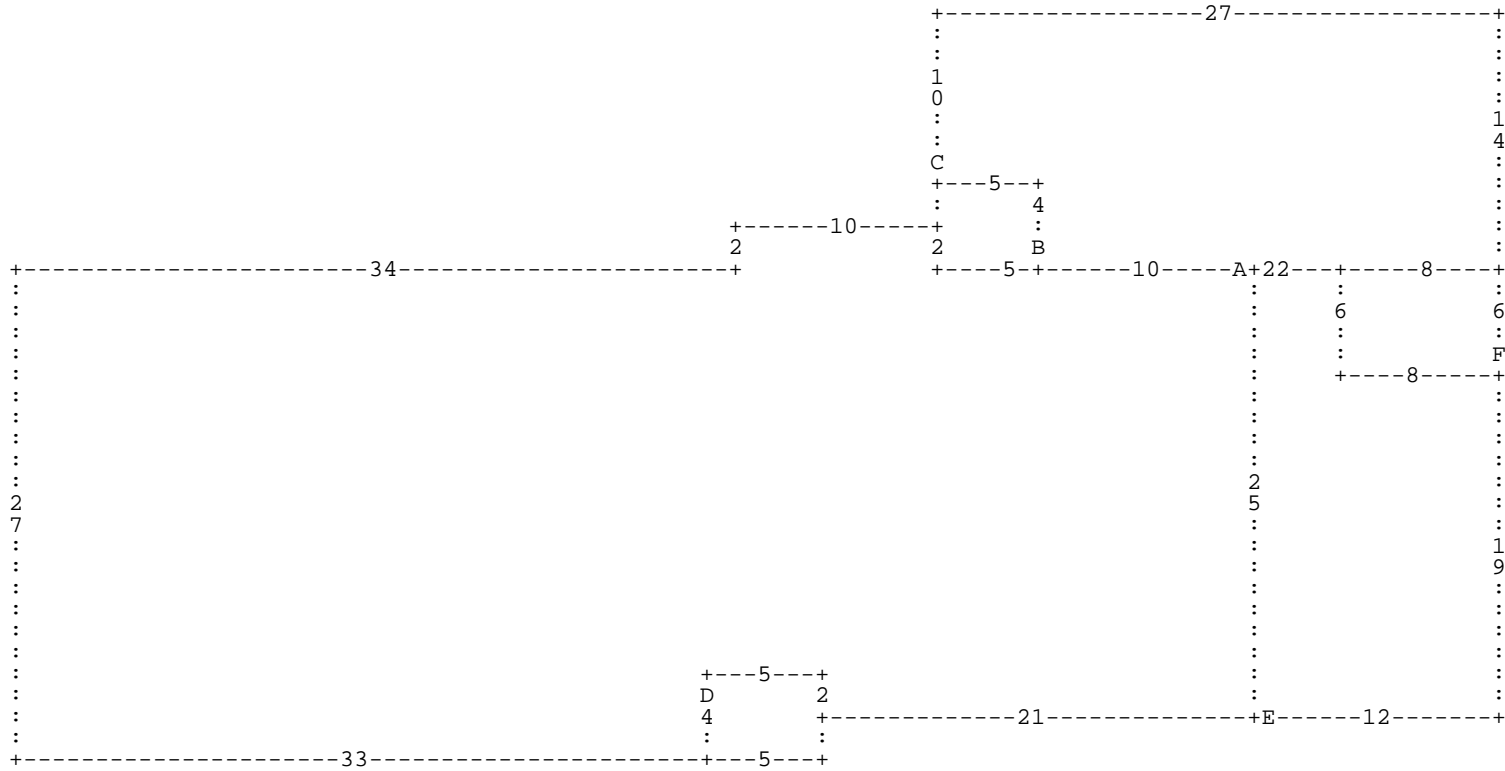

:A DL10 :B DU4 DL5 :C DU10 DR27 DD14 DL22 DU4 DL5 * DD4 DR5 * DL5 DU2 DL10 DD2 D
 L34 DD27 DR33 DU4 :D DD4 DR5 DU4 DL5 * DR5 DD2 DR21 :E DR12 DU19 :F DU6 DL8 DD6
 DR8 * DL8 DU6 DL4 DD25 * DU25 *

A= MA 111
D= AC 1052

1,551.00 SFR-1.0 STY
 20.00 PORCH-OPEN-MA

B= AC 1053
E= AC 1031

20.00 STOOP-MAS
 252.00 CARPORT

C= AC 1061
F= AC 1071

358.00 PATIO-CONC
 48.00 UTILITY STG-F