

SANCHEZ GABRIELA PEREZ
 1715 WESTWOOD AVE W
 L45S4 WESTWOOD 1.00LT
 .320 AC

Wilson County
 YR 2024 3712327444.000
 1715 WESTWOOD AVE W
 PIN: 3712 32 7444 000
 DISTRICT: 31 C/CIWI-WILSON

ACCOUNT#: 1107446
 NBHD: 8365 WESTWOOD_WEST
 Plat Bk/Pg 9 12 APPR: REV APPR DT: 12/11/2014
 EXCD: NOTICE: 82 3/08/2024

Bldg No. 1
 Imp Desc: R1.0 SFR-1.0 STY EYB: 1980 1715 WESTWOOD AVE W Exempt Code
 Grade : C C GRADE AYB: 1962 Finished Area: 1,587.00
 # of Units 5 Rms 3 Bedrms 2.0 Bathrms HBaths

LAND VALUE 30,000
 MISC VALUE 2,210
 BLDG VALUE 109,757
 TOTAL VALUE 141,967

TYPE/CODE/DESCRIPTION	PCT	%CMP	UNITS	RATE	STR#	STR%	SIZ%	HGT%	PER%	COST
AC 1031 CARPORT	100		261	27.90			97.00			7,063
AC 1052 PORCH-OPEN-MAS	100		24	29.10			120.00			838
AC 1061 PATIO-CONC	100		224	7.50			58.00			974
AC 1071 UTILITY STG-FR	100		63	39.45			106.00			2,634
MA 111 SFR-1.0 STY	100		1587	136.00	1.00		100.00			215,832
- AR 10 FORCED AIR HEAT W/ A100	100		1587	.00						0
- EW 18 BRICK VENEER	100		176	35.00						6,160
- FC 48 VINYL/CARPET	100		1587	.00						0
- FN 03 CONT WALL-BRICK	100		176	.00						0
- FP 3 1STY SNGL	100		1	5100.00						5,100
- IF 08 DRYWALL/PLASTER	100		1587	.00						0
- RC 02 COMPOSITION SHINGLE	100		1587	.00						0
- RT 03 DOUBLE PITCH ROOF	100		1587	.00						0
RCN...			PCT COMPLETE		100	x				238,601
QUAL..	C				100.00	x				238,601
DEPR.. RC					54.00	-		128,844		128,844
--ASV...										109,757

PROPERTY NOTES:	PERMIT NO	TYPE	DATE	BOOK	PAGE	DT	DATE	QS	SALES	PRICE
PERMIT CODE: N MO/YR: 092002 NOTE: NEW UNIT				2659	736	WD	6/16/2016			82,000
	AMOUNT			995	445	WD	10/25/1999	@		
	AMOUNT					WD	10/13/1967	X		5,500

MISC CODE	DESC	UNITS	RATE	AYB	EYB	DT	PCT	%CMP	ADD.DEPR	PCT	VALUE	EXMPT
81	1173 STG-FR 9 X 16	144.00	24.00	1970	1975	MAV	65.00	100			1,161	
82	1173 STG-FR 10 X 13	130.00	24.00	1980	1980	MAV	65.00	100			1,049	
							.00					
							.00					

#	ZONE	TYPE/CODE	LAND QTY	LAND RATE	DPTH	DPT%	TOP%	LOC%	SIZ%	SHP%	OTH%	ADJ	FMV	EXMPT
1	SR4	LT 0100	1.000	30,000.00	151	.00	.00	.00	100.00	.00	.00	.00	30,000	

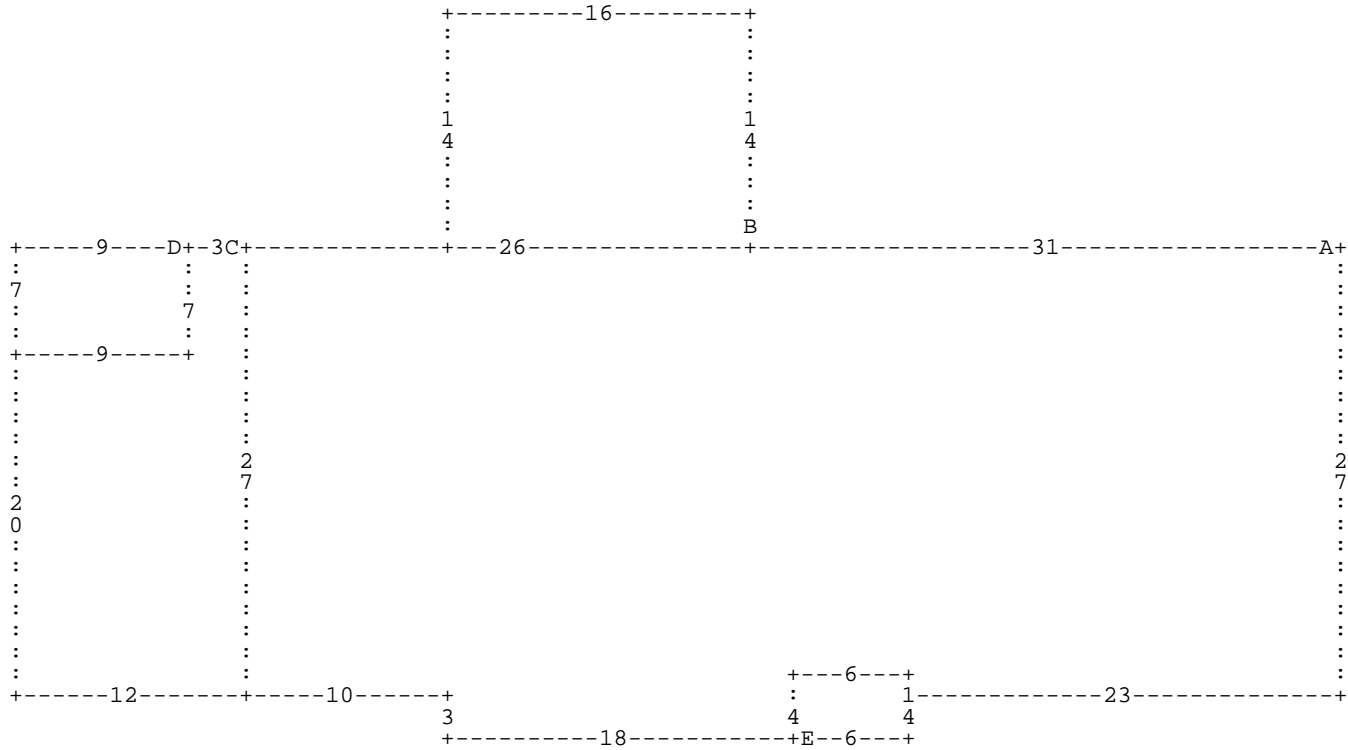

:A DL31 :B DU14 DL16 DD14 DR16 * DL26 :C DL3 :D DL9 DD7 DR9 DU7 * DD7 DL9 DD20 D
 R12 DU27 * DD27 DR10 DD3 DR18 :E DR6 DU4 DL6 DD4 * DU4 DR6 DD1 DR23 DU27 *

A= MA 111
D= AC 1071

1,587.00 SFR-1.0 STY
 63.00 UTILITY STG-F

B= AC 1061
E= AC 1052

224.00 PATIO-CONC
 24.00 PORCH-OPEN-MA

C= AC 1031

261.00 CARPORT