

MOORE ERVIN J
 1719 WESTWOOD AVE W
 L43S4 WESTWOOD 1.00LT
 .337 AC

Wilson County
 YR 2024 3712325457.000
 1719 WESTWOOD AVE W
 PIN: 3712 32 5457 000
 DISTRICT: 31 C/CIWI-WILSON

ACCOUNT#: 1107459
 NBHD: 8365 WESTWOOD_WEST
 Plat Bk/Pg 9 12 APPR: REV APPR DT: 12/11/2014
 EXCD: NOTICE: 82 3/08/2024

Bldg No. 1
 Imp Desc: R1.0 SFR-1.0 STY EYB: 1980 1719 WESTWOOD AVE W Exempt Code
 Grade : C C GRADE AYB: 1975 Finished Area: 1,605.00
 # of Units 5 Rms 3 Bedrms 2.0 Bathrms HBaths

LAND VALUE 30,000
 MISC VALUE 13,238
 BLDG VALUE 117,821
 TOTAL VALUE 161,059

TYPE/CODE/DESCRIPTION	PCT	%CMP	UNITS	RATE	STR#	STR%	SIZ%	HGT%	PER%	COST
AC 1031 CARPORT	100		294	27.90			97.00			7,956
AC 1051 PORCH-OPEN-FR	100		210	38.80		100.00	100.00			8,148
AC 1052 PORCH-OPEN-MAS	100		100	29.10			104.00			3,026
AC 1071 UTILITY STG-FR	100		126	39.45			102.00			5,070
MA 111 SFR-1.0 STY	100		1605	136.00	1.00		99.69			217,602
- AR 10 FORCED AIR HEAT W/ A100	100		1605	.00						0
- EW 18 BRICK VENEER	100		172	35.00						6,020
- FC 20 HARDWOOD/CARPET	100		1605	2.00						3,210
- FN 03 CONT WALL-BRICK	100		172	.00						0
- FP 3 1STY SNGL	100		1	5100.00						5,100
- IF 08 DRYWALL/PLASTER	100		1605	.00						0
- RC 02 COMPOSITION SHINGLE	100		1605	.00						0
- RT 03 DOUBLE PITCH ROOF	100		1605	.00						0
RCN... PCT COMPLETE					100	x				256,132
QUAL.. C					100.00	x				256,132
DEPR.. RC					54.00	-		138,311		138,311 T
--ASV...										117,821

PROPERTY NOTES:

PERMIT NO	TYPE	DATE	BOOK	PAGE	DT	DATE	QS	SALES	PRICE
			2660	318	WD	6/22/2016			100,000
AMOUNT			2003E	212	WI	4/09/2003	E		
					@	10/25/1999	@		
AMOUNT			1099	20	WD	5/07/1974	X		37,500

MISC CODE	DESC	UNITS	RATE	AYB	EYB	DT	PCT	%CMP	ADD.DEPR	PCT	VALUE	EXMPT
81 1121	GARAGE 024 X 034	816.00	51.50	1980	1980	MAV	65.00	100			13,238	
							.00					
							.00					
							.00					

#	ZONE	TYPE/CODE	LAND QTY	LAND RATE	DPTH	DPT%	TOP%	LOC%	SIZ%	SHR%	OTH%	ADJ	FMV	EXMPT
1	SR4	LT 0100	1.000	30,000.00	151	.00	.00	.00	100.00	.00	.00	.00	30,000	

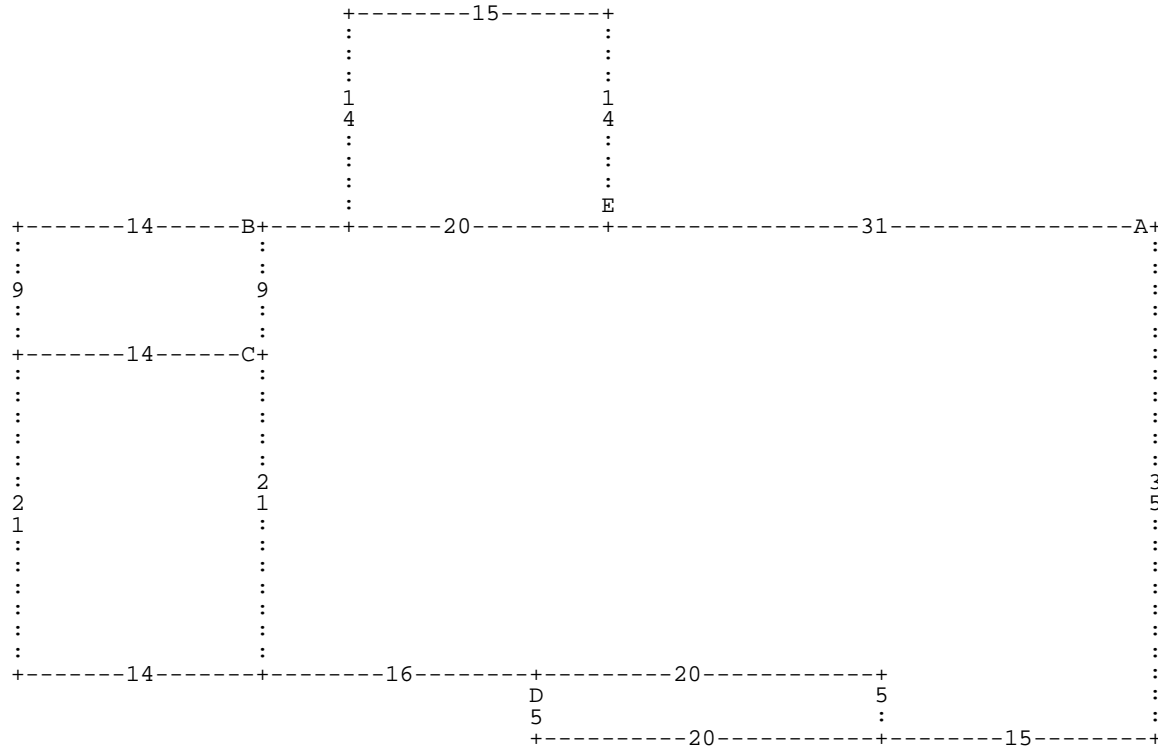

:A DL31 :E DU14 DL15 DD14 DR15 * DL20 :B DL14 DD9 DR14 DU9 * DD9 :C DL14 DD21 DR
 14 DU21 * DD21 DR16 :D DD5 DR20 DU5 DL20 * DR20 DD5 DR15 DU35 *

A= MA 111
D= AC 1052

1,605.00 SFR-1.0 STY
 100.00 PORCH-OPEN-MA

B= AC 1071
E= AC 1051

126.00 UTILITY STG-F
 210.00 PORCH-OPEN-FR

C= AC 1031

294.00 CARPORT