

COVINGTON LARRY
 1724 MEADOWBROOK LN W
 L49S4 WESTWOOD 1.00LT
 .342 AC

Wilson County
 YR 2024 3712325341.000
 1724 MEADOWBROOK LN W
 PIN: 3712 32 5341 000
 DISTRICT: 31 C/CIWI-WILSON

ACCOUNT#: 1108948
 NBHD: 8365 WESTWOOD_WEST
 Plat Bk/Pg 9 12 APPR: KRC APPR DT: 9/06/2017
 EXCD: NOTICE: 82 3/08/2024

Bldg No. 1
 Imp Desc: R1.0 SFR-1.0 STY EYB: 1980 1724 MEADOWBROOK LN W Exempt Code
 Grade : C+05 C+05 GRADE AYB: 1963 Finished Area: 1,454.00
 # of Units 5 Rms 3 Bedrms 2.0 Bathrms HBaths

LAND VALUE 30,000
 MISC VALUE 7,210
 BLDG VALUE 114,098
 TOTAL VALUE 151,308

TYPE/CODE/DESCRIPTION	PCT	%CMP	UNITS	RATE	STR#	STR%	SIZ%	HGT%	PER%	COST
AC 1031 CARPORT	100		286	27.90			97.00			7,740
AC 1051 PORCH-OPEN-FR	100		240	38.80			100.00			9,312
AC 1053 STOOP-MAS	100		24	19.40			120.00			558
MA 111 SFR-1.0 STY	100		1454	136.00	1.00		101.56			200,827
- AR 27 ELECTRIC HEAT PUMP	100		1454	.00						0
- EW 18 BRICK VENEER	100		178	35.00						6,230
- FC 19 HARDWOOD/TILE	100		1454	7.95						11,559
- FN 03 CONT WALL-BRICK	100		178	.00						0
- IF 01 DRYWALL	100		1454	.00						0
- RC 02 COMPOSITION SHINGLE	100		1454	.00						0
- RT 03 DOUBLE PITCH ROOF	100		1454	.00						0

RCN...			PCT COMPLETE		100		x			236,226
QUAL..		C+05			105.00		x			248,038
DEPR.. RC					54.00		-	133,940		133,940 T
--ASV...										114,098

PROPERTY NOTES:	PERMIT NO	TYPE	DATE	BOOK	PAGE	DT	DATE	QS	SALES	PRICE
CORRECTED FLR AND IF PER WBOR LISTING				2696	486	WD	4/20/2017			112,000
	AMOUNT			2434	231	WD	1/13/2011			110,500
				2380	786	WD	9/21/2009			95,000
	AMOUNT			2345	214	WD	12/29/2008			110,000

MISC CODE	DESC	UNITS	RATE	AYB	EYB	DT	PCT	%CMP	ADD.DEPR	PCT	VALUE	EXMPT
81 1121	GARAGE 020 X 020	400.00	51.50	1980	1980	MAV	65.00	100			7,210	
							.00					
							.00					
							.00					

#	ZONE	TYPE/CODE	LAND QTY	LAND RATE	DPTH	DPT%	TOP%	LOC%	SIZ%	SHP%	OTH%	ADJ	FMV	EXMPT
1	SR4	LT 0100	1.000	30,000.00		.00	.00	.00	100.00	.00	.00	.00	30,000	

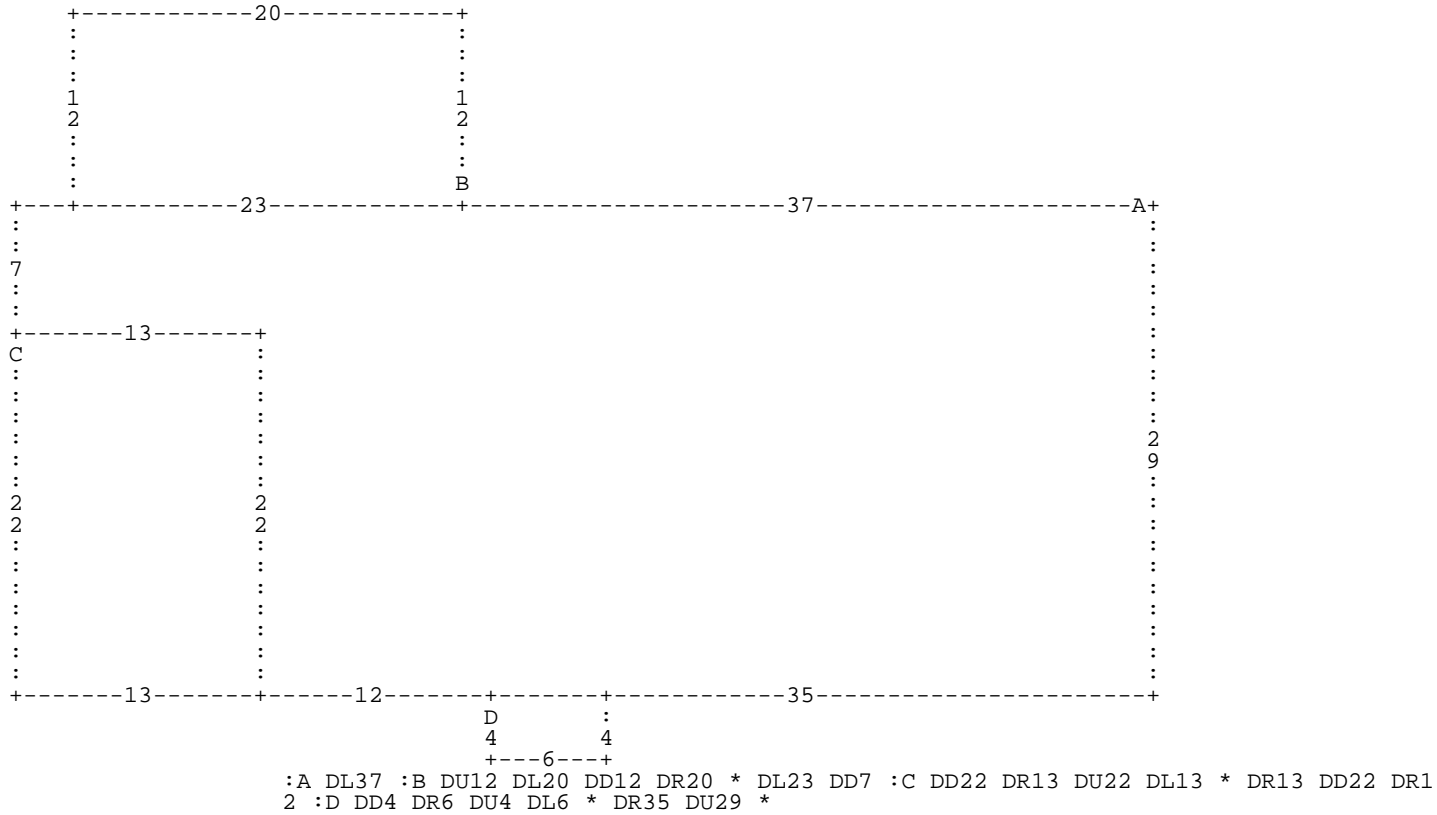

A= MA 111
D= AC 1053

1,454.00 SFR-1.0 STY
24.00 STOOP-MAS

B= AC 1051

240.00 PORCH-OPEN-FR

C= AC 1031

286.00 CARPORT