

HORNE KENNETH RAY SR
 605 GLENDALE DR W
 L16S4 WESTWOOD 1.00LT
 .316 AC

Wilson County
 YR 2024 3712229828.000
 605 GLENDALE DR W
 PIN: 3712 22 9828 000
 DISTRICT: 31 C/CIWI-WILSON

ACCOUNT#: 69922537
 NBHD: 8365 WESTWOOD_WEST
 Plat Bk/Pg 9 12
 EXCD: NOTICE: 82 3/08/2024
 APPR: REV APPR DT: 12/12/2014
 PAGE 1

Bldg No. 1
 Imp Desc: R1.0 SFR-1.0 STY
 Grade : C C GRADE
 # of Units 5 Rms 3 Bedrms 2.0 Bathrms HBaths
 EYB: 1980 605 GLENDALE DR W
 AYB: 1963 Finished Area: 1,558.00
 Exempt Code
 LAND VALUE 30,000
 MISC VALUE 10,383
 BLDG VALUE 107,179
 TOTAL VALUE 147,562

TYPE/CODE/DESCRIPTION	PCT	%CMP	UNITS	RATE	STR#	STR%	SIZ%	HGT%	PER%	COST
AC 1053 STOOP-MAS	100		24	19.40			100.00			465
AC 1056 PORCH-ENCL-FR	100		240	58.20	1.00	100.00	100.00			13,968
MA 111 SFR-1.0 STY	100		1558	136.00	1.00		100.31			212,543
- AR 10 FORCED AIR HEAT W/ A100	100		1558	.00						0
- EW 18 BRICK VENEER	100		172	35.00						6,020
- FC 48 VINYL/CARPET	100		1558	.00						0
- FN 03 CONT WALL-BRICK	100		172	.00						0
- IF 01 DRYWALL	100		1558	.00						0
- RC 02 COMPOSITION SHINGLE	100		1558	.00						0
- RT 03 DOUBLE PITCH ROOF	100		1558	.00						0
RCN...			PCT COMPLETE		100	x				232,996
QUAL..		C			100.00	x				232,996
DEPR.. RC					54.00	-		125,817		125,817 T
--ASV...										107,179

PROPERTY NOTES:

PERMIT NO	TYPE	DATE	BOOK	PAGE	DT	DATE	QS	SALES	PRICE
			2677	67	WD	11/10/2016			100,000
AMOUNT			2007	CDTH	CDTH	10/23/2007	E		
					@	10/25/1999	@		
AMOUNT			801	70	WD	10/09/1962	X		15,000

MISC CODE	DESC	UNITS	RATE	AYB	EYB	DT	PCT	%CMP	ADD.DEPR	PCT	VALUE	EXMPT
81 1121	GAR-DET-FR 24 X 24	576.00	51.50	1990	1990	MAV	65.00	100			10,383	
							.00					
							.00					
							.00					

#	ZONE	TYPE/CODE	LAND	QTY	LAND RATE	DPTH	DPT%	TOP%	LOC%	SIZ%	SHP%	OTH%	ADJ	FMV	EXMPT
1	SR4	LT 0100		1.000	30,000.00	150	.00	.00	.00	100.00	.00	.00	.00	30,000	

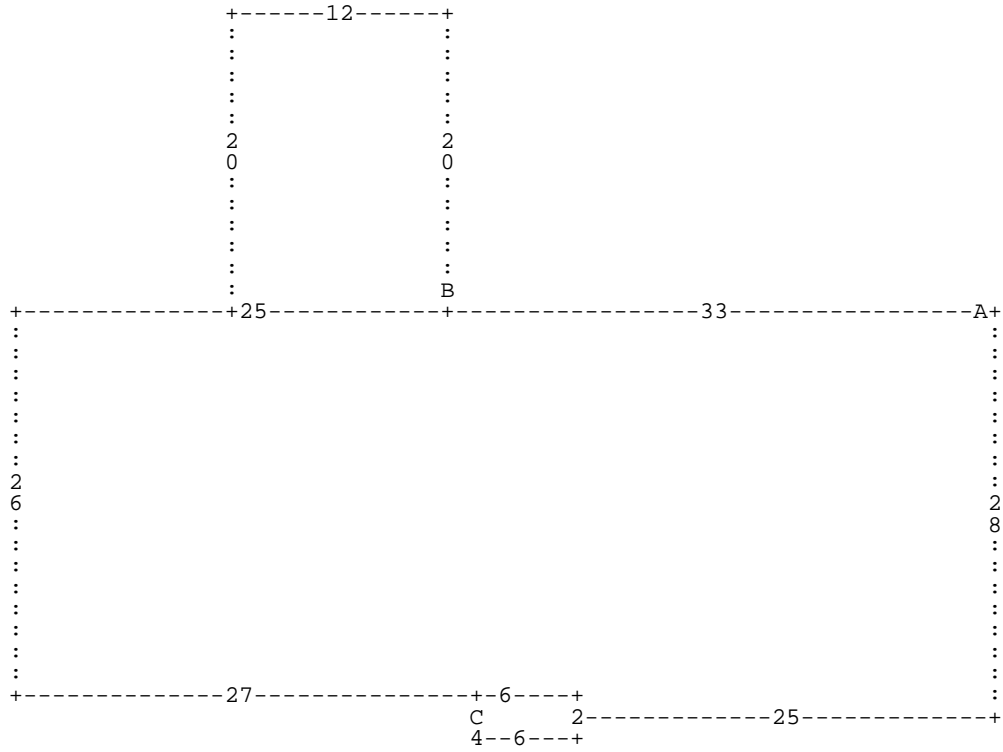

:A DL33 :B DU20 DL12 DD20 DR12 * DL25 DD33 DR27 :C DD4 DR6 DU4 DL6 * DR6 DD2 DR2
 5 DU28 *

A= MA 111

1,558.00 SFR-1.0 STY

B= AC 1056

240.00 PORCH-ENCL-FR

C= AC 1053

24.00 STOOP-MAS