

WARD ROBERT ANDREA
 2208 WOODCROFT DR W
 L97S9 WESTWD VILL 1.00LT
 .240 AC

Wilson County
 N2 FOUND YR 2024 3712226202.000
 2208 WOODCROFT DR W
 PIN: 3712 22 6202 000
 DISTRICT: 31 C/CIWI-WILSON

ACCOUNT#: 1129239
 NBHD: 8364 WESTWOOD_VILLAGE
 Plat Bk/Pg 25 137 APPR: REV APPR DT: 12/30/2014
 EXCD: NOTICE: 82 3/08/2024

Bldg No. 1
 Imp Desc: R1.0 SFR-1.0 STY EYB: 2005 2208 WOODCROFT DR W Exempt Code
 Grade : C+05 C+05 GRADE AYB: 1996 Finished Area: 1,543.00
 # of Units 5 Rms 3 Bedrms 2.0 Bathrms HBaths

LAND VALUE 35,000
 MISC VALUE 2,653
 BLDG VALUE 200,660
 TOTAL VALUE 238,313

TYPE/CODE/DESCRIPTION	PCT	%CMP	UNITS	RATE	STR#	STR%	SIZ%	HGT%	PER%	COST
AC 1051 PORCH-OPEN-FR	100		160	38.80			102.00			6,332
AC 1051 PORCH-OPEN-FR	100		100	38.80			104.00			4,035
AC 1071 UTILITY STG-FR	100		49	39.45			110.00			2,126
MA 111 SFR-1.0 STY	100		1543	136.00	1.00		100.63			211,168
- AR 27 ELECTRIC HEAT PUMP	100		1543	.00						0
- EW 02 VINYL SIDING	100		188	.00						0
- FC 20 HARDWOOD/CARPET	100		1543	2.00						3,086
- FN 02 CONT WALL-CONC BLOCK	100		188	.00						0
- FP 2 PREFAB	100		1	3500.00						3,500
- IF 30 DRYWALL/CUSTOM	100		1543	.00						0
- RC 07 WOOD SHAKES/3D-SHING	100		1543	.00						0
- RT 03 DOUBLE PITCH ROOF	100		1543	.00						0
RCN...			PCT COMPLETE		100	x				230,247
QUAL..	C+05				105.00	x				241,759
DEPR..	RC				17.00	-		41,099		41,099 T
--ASV...										200,660

PROPERTY NOTES:	PERMIT NO	TYPE	DATE	BOOK	PAGE	DT	DATE	QS	SALES	PRICE
PERMIT CODE: A MO/YR: 062002 NOTE: 5000				2997	51	WD	12/16/2022			230,000
PERMIT CODE: N MO/YR: 091996 NOTE: 62674				AMOUNT	1765	95	WD			105,000
				AMOUNT	1612	517	WD	10/25/1999 @		99,000
							1/08/1997			

MISC CODE	DESC	UNITS	RATE	AYB	EYB	DT	PCT	%CMP	ADD.DEPR	PCT	VALUE	EXMPT
81	1173 STORAGE 012 X 016	192.00	24.00	1996	1996	MAV	65.00	100			1,516	
82	1143 SHELTER 016 X 016	256.00	10.50	2000	2000	MAV	55.00	100			1,137	
							.00					
							.00					

#	ZONE	TYPE/CODE	LAND QTY	LAND RATE	DPTH	DPT%	TOP%	LOC%	SIZ%	SHP%	OTH%	ADJ	FMV	EXMPT
1	SR6	LT 0100	1.000	35,000.00	140	.00	.00	.00	100.00	.00	.00	.00	35,000	

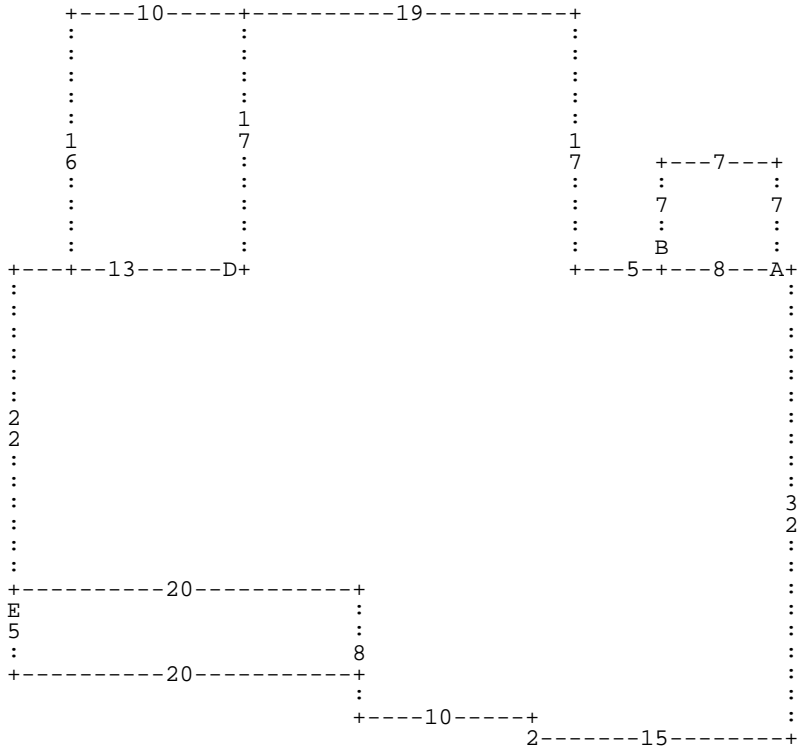

:A DL8 :B DU7 DR7 DD7 DL7 * DL5 DU17 DL19 DD17 :D DL10 DU16 DR10 DD16 * DL13 DD2
 2 :E DD5 DR20 DU5 DL20 * DR20 DD8 DR10 DD2 DR15 DU32 *

A= MA 111 1,543.00 SFR-1.0 STY **B=** AC 1071 49.00 UTILITY STG-F **D=** AC 1051 160.00 PORCH-OPEN-FR
E= AC 1051 100.00 PORCH-OPEN-FR