

LIN QIN
 1812 OAKDALE DR W
 L70S5 WESTWOOD 1.00LT
 .291 AC

N2 FOUND YR 2024 **3712214508.000**
 1812 OAKDALE DR W
 PIN: 3712 21 4508 000
DISTRICT: 31 C/CIWI-WILSON

Wilson County

ACCOUNT#: 1128948
NBHD: 8363 WESTWOOD_EAST
 Plat Bk/Pg 10 79 APPR: KRC APPR DT: 11/02/2022
EXCD: NOTICE: 82 3/08/2024

Bldg No. 1
 Imp Desc: R1.0 SFR-1.0 STY EYB: 1990 1812 OAKDALE DR W Exempt Code
 Grade : C C GRADE AYB: 1966 Finished Area: 1,453.00
 # of Units 5 Rms 3 Bedrms 1.0 Bathrms 1 HBaths

LAND VALUE 35,000
MISC VALUE 3,940
BLDG VALUE 150,905
TOTAL VALUE 189,845

TYPE/CODE/DESCRIPTION	PCT	%CMP	UNITS	RATE	STR#	STR%	SIZ%	HGT%	PER%	COST
AC 1031 CARPORT	100		252	27.90			97.00			6,819
AC 1051 PORCH-OPEN-FR	100		294	38.80			97.00			11,064
AC 1071 UTILITY STG-FR	100		96	39.45			104.00			3,938
MA 111 SFR-1.0 STY	100		1453	136.00	1.00		101.56			200,689
- AR 10 FORCED AIR HEAT W/ A100			1453	.00						0
- EW 18 BRICK VENEER	100		160	35.00						5,600
- FC 03 HARDWOOD	100		1453	4.35						6,320
- FN 03 CONT WALL-BRICK	100		160	.00						0
- FP 3 1STY SNGL	100		1	5100.00						5,100
- IF 01 DRYWALL	100		1453	.00						0
- RC 02 COMPOSITION SHINGLE	100		1453	.00						0
- RT 03 DOUBLE PITCH ROOF	100		1453	.00						0

RCN... PCT COMPLETE 100 x 239,530
 QUAL.. C 100.00 x 239,531
 DEPR.. RC 37.00 - 88,626 T
 --ASV... 150,905

PROPERTY NOTES:	PERMIT NO	TYPE	DATE	BOOK	PAGE	DT	DATE	QS	SALES	PRICE
FIX SFR/FOP & OB (FOOTPRINT) 4 '11-GRW				2991	25	WD	10/28/2022			174,000
UPDATED 2 FULL BATHS 4'23 PER AUDIT WBOR LISTING	AMOUNT			2022	CDTH	CDTH	8/12/2022	E		
PERMIT CODE: A MO/YR: 051994 NOTE: 1100	AMOUNT			2742	684	WD	5/11/2018			100,000
						@	10/25/1999	@		

MISC CODE	DESC	UNITS	RATE	AYB	EYB	DT	PCT	%CMP	ADD.DEPR	PCT	VALUE	EXMPT
81 1121	GAR-DET FRAME 12 X 34	408.00	51.50	1985	1985	MFR	75.00	100			3,940	
							.00					
							.00					
							.00					

#	ZONE	TYPE/CODE	LAND QTY	LAND RATE	DPH	DPT%	TOP%	LOC%	SIZ%	SHP%	OTH%	ADJ	FMV	EXMPT
1	SR4	LT 0100	1.000	35,000.00	150	.00	.00	.00	100.00	.00	.00	.00	35,000	

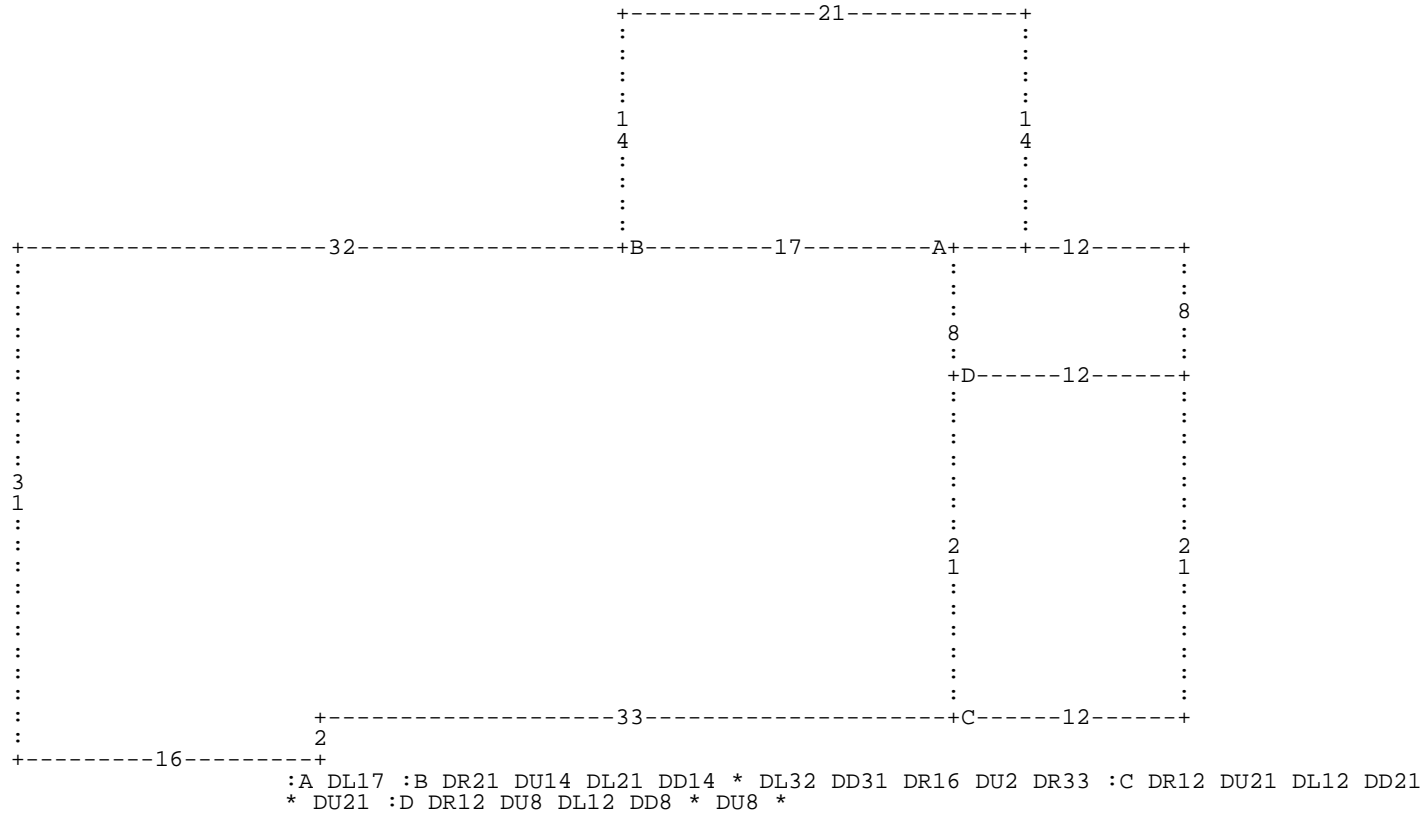

A= MA 111
D= AC 1071

1,453.00 SFR-1.0 STY
96.00 UTILITY STG-F

B= AC 1051

294.00 PORCH-OPEN-FR

C= AC 1031

252.00 CARPORT