

RAY JEAN D
 400 PINECREST DR W
 L10S5 WESTWOOD 1.00LT
 .463 AC

Wilson County
 YR 2024 3712208545.000
 400 PINECREST DR W
 PIN: 3712 20 8545 000
 DISTRICT: 31 C/CIWI-WILSON

ACCOUNT#: 1120019
 NBHD: 8363 WESTWOOD_EAST
 Plat Bk/Pg 10 79 APPR: KRC APPR DT: 8/04/2020
 EXCD: NOTICE: 82 3/08/2024

Bldg No. 1
 Imp Desc: R1.0 SFR-1.0 STY EYB: 1990 400 PINECREST DR W Exempt Code
 Grade : C C GRADE AYB: 1976 Finished Area: 1,710.00
 # of Units 5 Rms 3 Bedrms 2.0 Bathrms HBaths

LAND VALUE 35,000
 MISC VALUE 0
 BLDG VALUE 162,615
 TOTAL VALUE 197,615

TYPE/CODE/DESCRIPTION	PCT	%CMP	UNITS	RATE	STR#	STR%	SIZ%	HGT%	PER%	COST
AC 1031 CARPORT	100		486	27.90			90.00			12,203
AC 1051 PORCH-OPEN-FR	100		144	38.80			102.00			5,698
AC 2071 UTILITY STG-FR	100		144	28.50			64.00			2,626
MA 111 SFR-1.0 STY	100		1710	136.00	1.00		98.50			229,071
- AR 10 FORCED AIR HEAT W/ A100			1710	.00						0
- EW 17 ALUMINUM SIDING	100		174	.00						0
- FC 20 HARDWOOD/CARPET	100		1710	2.00						3,420
- FN 02 CONT WALL-CONC BLOCK100			174	.00						0
- FP 3 1STY SNGL	100		1	5100.00						5,100
- IF 01 DRYWALL	100		1710	.00						0
- RC 02 COMPOSITION SHINGLE	100		1710	.00						0
- RT 03 DOUBLE PITCH ROOF	100		1710	.00						0
RCN...			PCT COMPLETE		100	x				258,118
QUAL..	C				100.00	x				258,118
DEPR..	RC				37.00	-		95,503		95,503 T
--ASV...										162,615

PROPERTY NOTES:	PERMIT NO	TYPE	DATE	BOOK	PAGE	DT	DATE	QS	SALES	PRICE
PER AUDIT FIXED PORCH TO UTILITY,PORCH,FC,AR				2844	491	WD	7/24/2020			155,000
RAISED EYB ON INT RENO, 4'21 WBOR LISTING				AMOUNT	2842	903	WD	7/14/2020	C	
				2664	200	WD	7/28/2016			130,000
				AMOUNT	2651	291	WD	7/28/2016		55,000

MISC CODE	DESC	UNITS	RATE	AYB	EYB	DT	PCT	%CMP	ADD.DEPR	PCT	VALUE	EXMPT
							.00					
							.00					
							.00					
							.00					

#	ZONE	TYPE/CODE	LAND QTY	LAND RATE	DPTH	DPT%	TOP%	LOC%	SIZ%	SHP%	OTH%	ADJ	FMV	EXMPT
1	SR4	LT 0100	1.000	35,000.00	200	.00	.00	.00	100.00	.00	.00	.00	35,000	

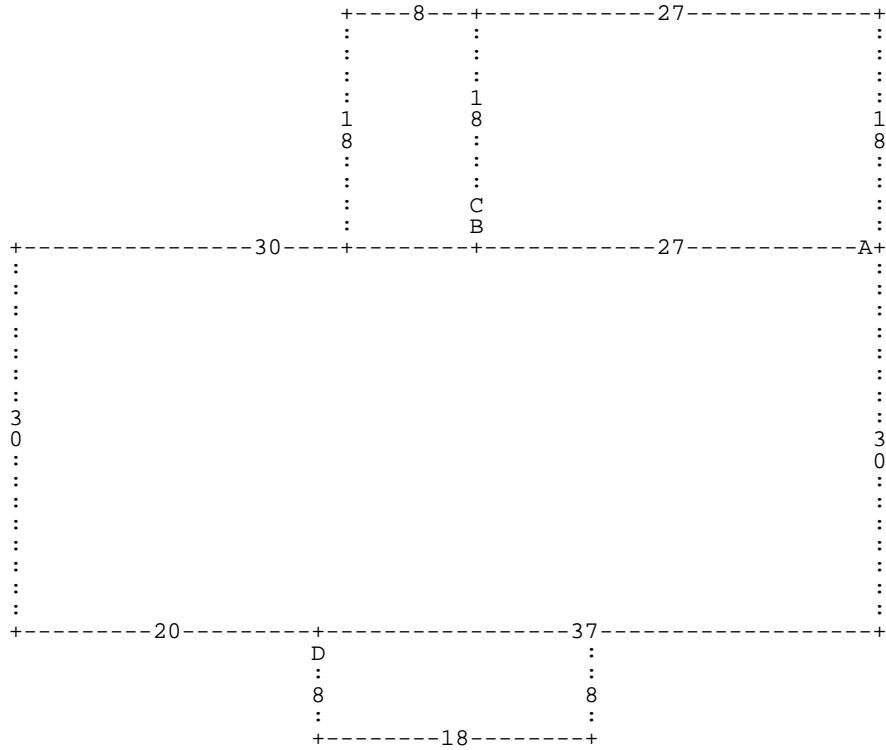

:A DL27 :B DU18 DR27 DD18 DL27 * :C DU18 DL8 DD18 DR8 * DL30 DD30 DR20 :D DD8 DR
 18 DU8 DL18 * DR37 DU30 *

A= MA 111
D= AC 1051

1,710.00 SFR-1.0 STY
 144.00 PORCH-OPEN-FR

B= AC 1031

486.00 CARPORT

C= AC 2071

144.00 UTILITY STG-F