

RICHARDSON ROY JUNIOR
 1904 CRESCENT DR W
 L79S5 WESTWOOD 1.00LT
 .486 AC

Wilson County
 YR 2024 3712115574.000
 1904 CRESCENT DR W
 PIN: 3712 11 5574 000
 DISTRICT: 31 C/CIWI-WILSON

ACCOUNT#: 1128386
 NBHD: 8363 WESTWOOD_EAST
 Plat Bk/Pg 10 79 APPR: KRC APPR DT: 12/12/2022
 EXCD: NOTICE: 82 3/08/2024

Bldg No. 1
 Imp Desc: R1.0 SFR-1.0 STY EYB: 1995 1904 CRESCENT DR W Exempt Code
 Grade : C C GRADE AYB: 1966 Finished Area: 1,740.00
 # of Units 5 Rms 3 Bedrms 2.0 Bathrms HBaths

LAND VALUE 35,000
 MISC VALUE 4,967
 BLDG VALUE 186,010
 TOTAL VALUE 225,977

TYPE/CODE/DESCRIPTION	PCT	%CMP	UNITS	RATE	STR#	STR%	SIZ%	HGT%	PER%	COST
AC 1031 CARPORT	100		266	27.90			97.00			7,198
AC 1052 PORCH-OPEN-MAS	100		36	29.10			120.00			1,257
AC 1061 PATIO-CONC	100		900	7.50			55.00			3,712
AC 1072 UTILITY STG-MAS	100		117	41.40			64.00			3,100
MA 111 SFR-1.0 STY	100		1740	136.00	1.00		98.25			232,498
- AR 10 FORCED AIR HEAT W/ A100	100		1740	.00						0
- EW 18 BRICK VENEER	100		186	35.00						6,510
- FC 52 LAMINATE/CARPET	100		1740	1.50						2,610
- FN 03 CONT WALL-BRICK	100		186	.00						0
- FP 3 1STY SNGL	100		1	5100.00						5,100
- IF 01 DRYWALL	100		1740	.00						0
- RC 02 COMPOSITION SHINGLE	100		1740	.00						0
- RT 03 DOUBLE PITCH ROOF	100		1740	.00						0
RCN... PCT COMPLETE					100	x				261,985
QUAL.. C					100.00	x				261,985
DEPR.. RC					29.00	-		75,975		75,975 T
--ASV...										186,010

PROPERTY NOTES:	PERMIT NO	TYPE	DATE	BOOK	PAGE	DT	DATE	QS	SALES	PRICE
UPDATED UTIL,FC,STORAGE,PER AUDIT 4'23 WBOR LISTING				2984	618	WD	9/20/2022			208,000
	AMOUNT			1590	917	WD	10/25/1999 @			87,000
	AMOUNT			1546	106	WD	5/31/1996 U			
							1/01/1995 U			

MISC CODE	DESC	UNITS	RATE	AYB	EYB	DT	PCT	%CMP	ADD.DEPR	PCT	VALUE	EXMPT
2 1173	STG-FR 16 X 16	256.00	24.00	2017	2017	MAV	14.00	100			4,967	
							.00					
							.00					
							.00					

#	ZONE	TYPE/CODE	LAND QTY	LAND RATE	DPTH	DPT%	TOP%	LOC%	SIZ%	SHP%	OTH%	ADJ	FMV	EXMPT
1	SR4	LT 0100	1.000	35,000.00	141	.00	.00	.00	100.00	.00	.00	.00	35,000	

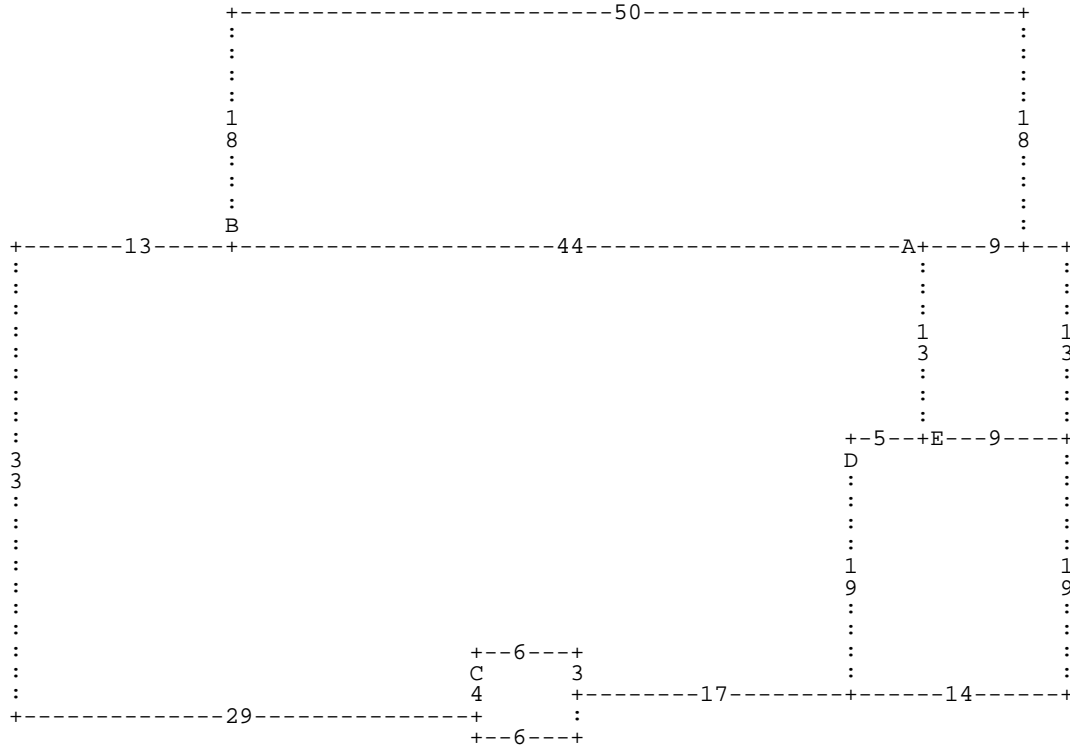

:A DL44 :B DU18 DR50 DD18 DL50 * DL13 DD33 DR29 DU4 :C DD6 DR6 DU6 DL6 * DR6 DD3
 DR17 DU19 :D DD19 DR14 DU19 DL14 * DR5 :E DR9 DU13 DL9 DD13 * DU13 *

A= MA 111
D= AC 1031

1,740.00 SFR-1.0 STY
 266.00 CARPORT

B= AC 1061
E= AC 1072

900.00 PATIO-CONC
 117.00 UTILITY STG-M

C= AC 1052

36.00 PORCH-OPEN-MA