

VANDEMARK CRAIG
 1901 DELWOOD DR W
 P21P22S5 WESTWOOD 1.00LT
 .310 AC

Wilson County
 N2 FOUND YR 2024 3712107622.000
 1901 DELWOOD DR W
 PIN: 3712 10 7622 000
 DISTRICT: 31 C/CIWI-WILSON

ACCOUNT#: 1105050
 NBHD: 8363 WESTWOOD_EAST
 Plat Bk/Pg 10 79 APPR: JHB APPR DT: 9/08/2015
 EXCD: NOTICE: 82 3/08/2024

Bldg No. 1
 Imp Desc: R1.0 SFR-1.0 STY EYB: 1980 1901 DELWOOD DR W Exempt Code
 Grade : C C GRADE AYB: 1967 Finished Area: 1,397.00
 # of Units 5 Rms 3 Bedrms 2.0 Bathrms HBaths

LAND VALUE 35,000
 MISC VALUE 4,313
 BLDG VALUE 103,516
 TOTAL VALUE 142,829

TYPE/CODE/DESCRIPTION	PCT	%CMP	UNITS	RATE	STR#	STR%	SIZ%	HGT%	PER%	COST
AC 1031 CARPORT	100		252	27.90			97.00			6,819
AC 1051 PORCH-OPEN-FR	100		100	38.80			104.00			4,035
AC 1064 DECK-WOOD	100		168	24.95			102.00			4,275
AC 1071 UTILITY STG-FR	100		80	39.45			106.00			3,345
MA 111 SFR-1.0 STY	100		1397	136.00	1.00		102.50			194,741
- AR 10 FORCED AIR HEAT W/ A100	100		1397	.00						0
- EW 18 BRICK VENEER	100		164	35.00						5,740
- FC 03 HARDWOOD	100		1397	4.35						6,076
- FN 03 CONT WALL-BRICK	100		164	.00						0
- IF 01 DRYWALL	100		1397	.00						0
- RC 02 COMPOSITION SHINGLE	100		1397	.00						0
- RT 04 HIP ROOF	100		1397	.00						0

RCN... PCT COMPLETE 100 x 225,031
 QUAL.. C 100.00 x 225,032
 DEPR.. RC 54.00 - 121,516 121,516 T
 --ASV... 103,516

PROPERTY NOTES:

ADDED LEONARD STORAGE BUILDING/09/08/2015/JHB

PERMIT NO	TYPE	DATE	BOOK	PAGE	DT	DATE	QS	SALES	PRICE
BP001518000		8/03/2015	2623	357	WD	8/03/2015			91,500
AMOUNT		3,600	2159	478	WD	2/24/2006	X		97,000
AMOUNT			1990	476	WD	9/30/2003	E		
					@	10/25/1999	@		

MISC CODE	DESC	UNITS	RATE	AYB	EYB	DT	PCT	%CMP	ADD.DEPR	PCT	VALUE	EXMPT
81 1133	CARPORT 012 X 020	240.00	5.80	2000	2000	MAV	55.00	100			614	
82 1173	STG-FR 10 X 16	160.00	24.00	2015	2015	MGD	18.00	100			3,699	
							.00					
							.00					

#	ZONE	TYPE/CODE	LAND QTY	LAND RATE	DPH	DPT%	TOP%	LOC%	SIZ%	SHP%	OTH%	ADJ	FMV	EXMPT
1	SR4	LT 0100	1.000	35,000.00	150	.00	.00	.00	100.00	.00	.00	.00	35,000	

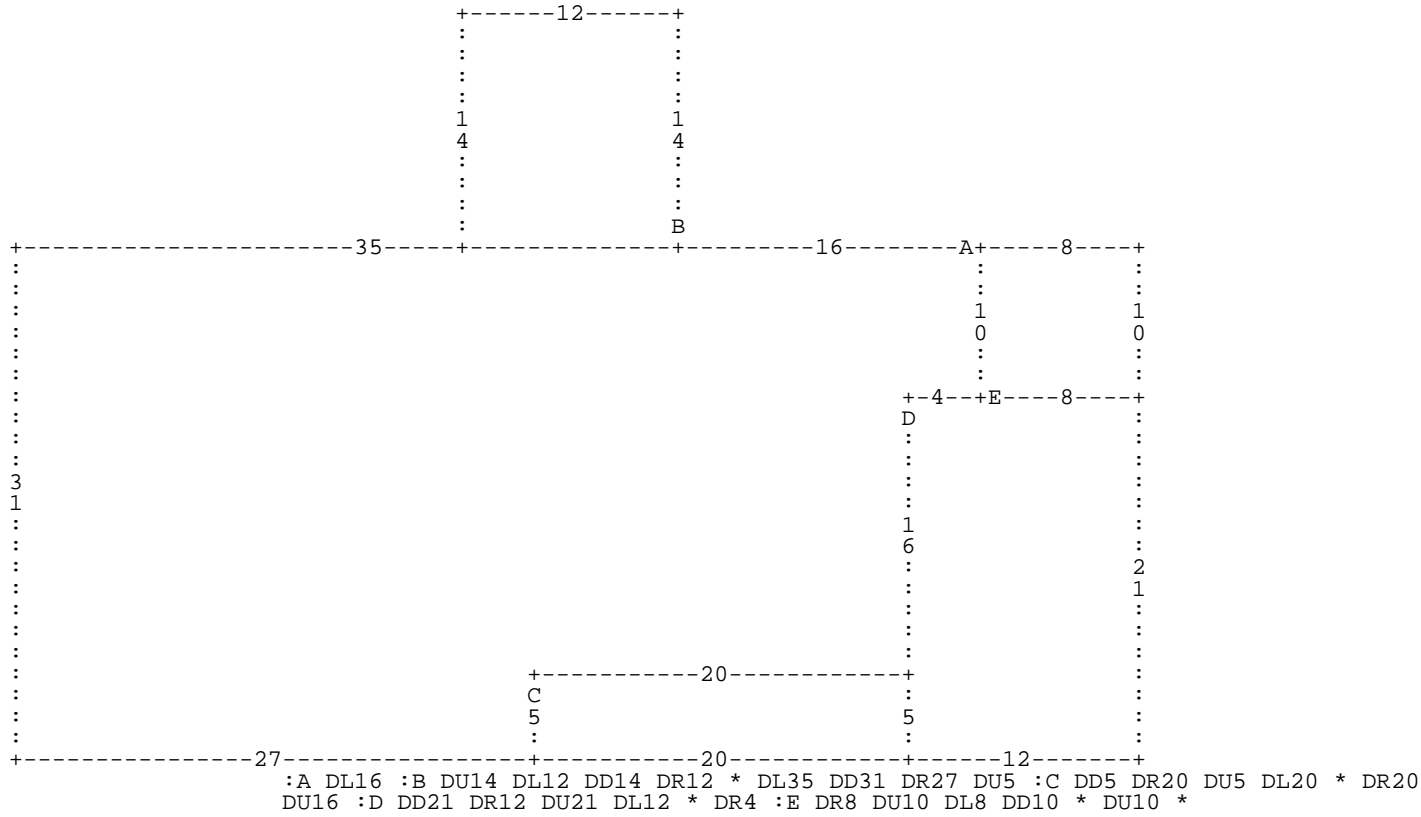

A= MA 111	1,397.00 SFR-1.0 STY	B= AC 1064	168.00 DECK-WOOD	C= AC 1051	100.00 PORCH-OPEN-FR
D= AC 1031	252.00 CARPORT	E= AC 1071	80.00 UTILITY STG-F		