

JONES DONALD GLENN JR
 1204 DOGWOOD LN NW
 L28S1 FRST HILLS 1.00LT
 .466 AC

N2 FOUND YR 2024 **3712098487.000**
 1204 DOGWOOD LN NW
 PIN: 3712 09 8487 000
DISTRICT: 31 C/CIWI-WILSON

Wilson County

ACCOUNT#: 1103421
NBHD: 8099 EDGEWOOD
 Plat Bk/Pg 8 64
EXCD: APPR: REV APPR DT: 1/27/2015
 NOTICE: 82 3/08/2024

Bldg No. 1
 Imp Desc: R1.0 SFR-1.0 STY EYB: 1970 1204 DOGWOOD LN NW Exempt Code
 Grade : C+05 C+05 GRADE AYB: 1960 Finished Area: 1,622.00
 # of Units 6 Rms 3 Bedrms 1.0 Bathrms 1 HBaths

LAND VALUE 40,000
MISC VALUE 9,077
BLDG VALUE 93,628
TOTAL VALUE 142,705

TYPE/CODE/DESCRIPTION	PCT	%CMP	UNITS	RATE	STR#	STR%	SIZ%	HGT%	PER%	COST
AC 1031 CARPORT	100		264	27.90			97.00			7,144
AC 1053 STOOP-MAS	100		24	19.40			120.00			558
AC 1054 PORCH-SCR-MAS	100		244	45.80			100.00			11,175
AC 1071 UTILITY STG-FR	100		110	39.45			104.00			4,513
MA 111 SFR-1.0 STY	100		1622	136.00	1.00		99.69			219,907
- AR 10 FORCED AIR HEAT W/ A100	100		1622	.00						0
- BT BT FULL BATH	100		1-	5500.00						5,500-
- BT HBT HALF BATH	100		1	3667.00						3,667
- EW 18 BRICK VENEER	100		178	35.00						6,230
- FC 48 VINYL/CARPET	100		1622	.00						0
- FN 03 CONT WALL-BRICK	100		178	.00						0
- IF 01 DRYWALL	100		1622	.00						0
- RC 02 COMPOSITION SHINGLE	100		1622	.00						0
- RT 03 DOUBLE PITCH ROOF	100		1622	.00						0

RCN...			PCT COMPLETE		100	x				247,694
QUAL..	C+05				105.00	x				260,078
DEPR.. RC					64.00	-		166,450		166,450 T
--ASV...										93,628

PROPERTY NOTES:	PERMIT NO	TYPE	DATE	BOOK	PAGE	DT	DATE	QS	SALES	PRICE
PERMIT CODE: N MO/YR: 082003 NOTE: 12000				2586	888	ESTD	9/04/2014			99,000
	AMOUNT			799	79	@	10/25/1999	@		
	AMOUNT					WD	8/15/1962	X		12,000

MISC CODE	DESC	UNITS	RATE	AYB	EYB	DT	PCT	%CMP	ADD.DEPR	PCT	VALUE	EXMPT
81 1121	GARAGE 016 X 020	320.00	51.50	2003	2003	MAV	46.00	100			9,077	
							.00					
							.00					
							.00					

#	ZONE	TYPE/CODE	LAND QTY	LAND RATE	DPH	DPT%	TOP%	LOC%	SIZ%	SHP%	OTH%	ADJ	FMV	EXMPT
1	SR4	LT 0100	1.000	40,000.00	186	.00	.00	.00	100.00	.00	.00	.00	40,000	

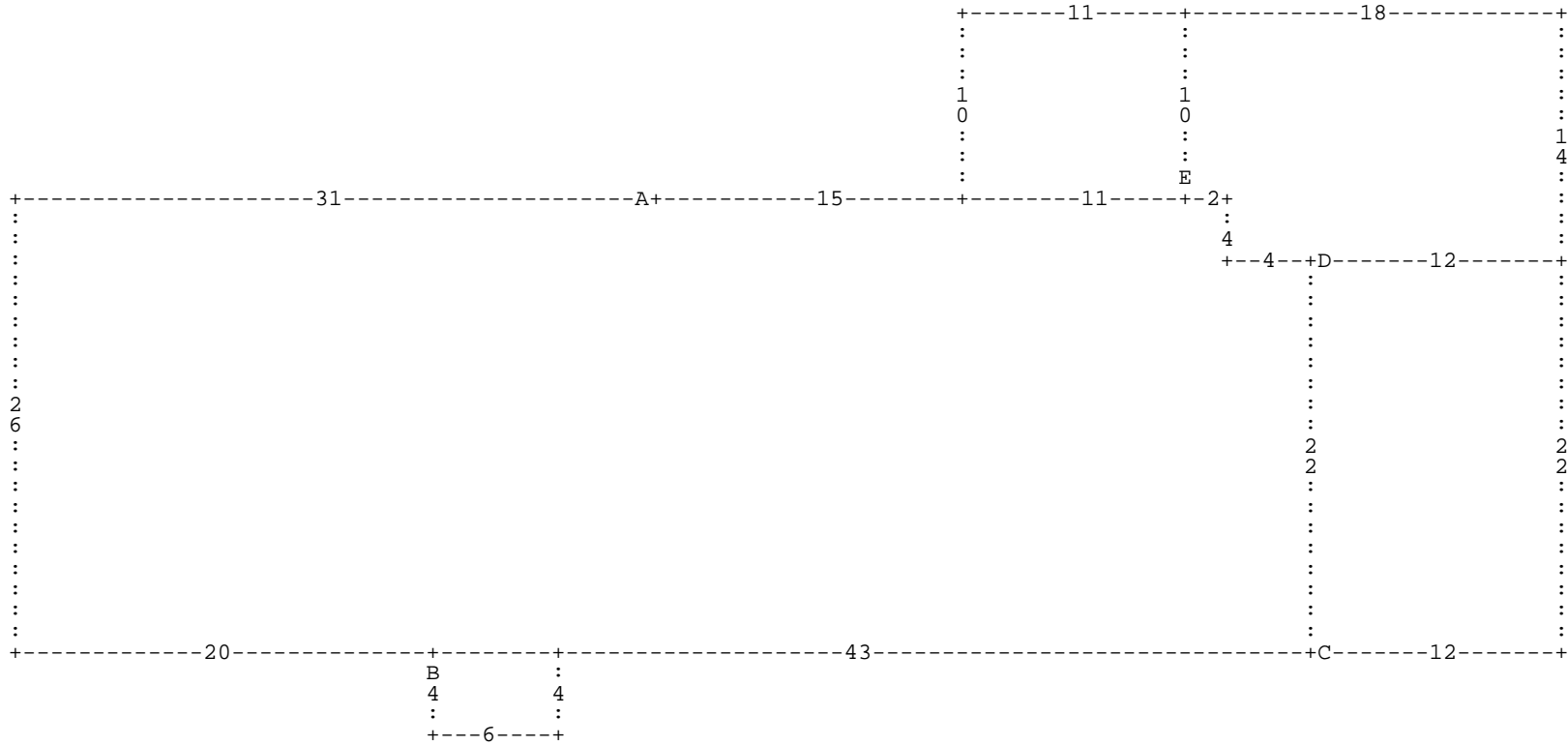

:A DL31 DD26 DR20 :B DD4 DR6 DU4 DL6 * DR43 :C DR12 DU22 DL12 DD22 * DU22 :D DR1
 2 DU14 DL18 DD10 DR2 DD4 DR4 * DL4 DU4 DL2 :E DU10 DL11 DD10 DR11 * DL11 DL15 *

A= MA 111
D= AC 1054

1,622.00 SFR-1.0 STY
 244.00 PORCH-SCR-MAS

B= AC 1053
E= AC 1071

24.00 STOOP-MAS
 110.00 UTILITY STG-F

C= AC 1031

264.00 CARPORT