

MORA BRYAN  
 2601 HIGHFIELD DR W  
 L196S2 WESTHAVEN 1.00LT  
 .350 AC

Wilson County  
 YR 2024 3712005926.000  
 2601 HIGHFIELD DR W  
 PIN: 3712 00 5926 000  
 DISTRICT: 31 C/CIWI-WILSON

ACCOUNT#: 1122996  
 NBHD: 8362 WESTHAVEN  
 Plat Bk/Pg 36 21  
 EXCD: NOTICE: 82 3/08/2024  
 APPR: KRC APPR DT: 3/07/2022  
 PAGE 1

Bldg No. 1  
 Imp Desc: R1.5 SFR-UPTO 1.5 STY EYB: 2012 2601 HIGHFIELD DR W Exempt Code  
 Grade : C+10 C+10 GRADE AYB: 2012 Finished Area: 1,605.00  
 # of Units 7 Rms 3 Bedrms 2.0 Bathrms HBaths  
 LAND VALUE 45,000  
 MISC VALUE 0  
 BLDG VALUE 213,571  
 TOTAL VALUE 258,571

TYPE/CODE/DESCRIPTION	PCT	%CMP	UNITS	RATE	STR#	STR%	SIZ%	HGT%	PER%	COST
AC 1052 PORCH-OPEN-MAS	100		126	29.10		100.00	102.00			3,739
AC 1052 PORCH-OPEN-MAS	100		20	29.10		100.00	120.00			698
AC 1064 DECK-WOOD	100		192	24.95		100.00	100.00			4,790
AC 1071 UTILITY STG-FR	100		60	39.45		100.00	106.00			2,509
MA 112 SFR-1.5 STY	100		1605	116.00	1.00		99.69			185,602
- AR 10 FORCED AIR HEAT W/ A100			1605	.00						0
- AT UAT UNF ATTIC	37		593	27.00			99.69			15,961
- EW 02 VINYL SIDING	100		190	.00						0
- FC 52 LAMINATE/CARPET	100		1605	1.50						2,407
- FN 03 CONT WALL-BRICK	100		190	.00						0
- IF 01 DRYWALL	100		1605	.00						0
- RC 07 WOOD SHAKES/3D-SHING	100		1605	.00						0
- RT 03 DOUBLE PITCH ROOF	100		1605	.00						0
RCN...			PCT COMPLETE		100	x				215,706
QUAL..	C+10				110.00	x				237,301
DEPR.. RC					10.00	-		23,730		23,730 T
--ASV...										213,571

PROPERTY NOTES:	PERMIT NO	TYPE	DATE	BOOK	PAGE	DT	DATE	QS	SALES	PRICE
COMPLETE 09132013	BP01202168N		9/18/2012	2950	746	WD	2/28/2022			253,500
FIXED PORCH,STOOP,FC PER AUDIT 4'22 WBOR LISTING	AMOUNT	135,000		2558	735	WD	12/13/2013			164,000
	AMOUNT			2499	283	WD	9/06/2012			24,000
				2481	207	WD	3/30/2012			24,000

MISC CODE	DESC	UNITS	RATE	AYB	EYB	DT	PCT	%CMP	ADD.DEPR	PCT	VALUE	EXMPT
							.00					
							.00					
							.00					
							.00					

#	ZONE	TYPE/CODE	LAND QTY	LAND RATE	DPTH	DPT%	TOP%	LOC%	SIZ%	SHP%	OTH%	ADJ	FMV	EXMPT
1	SR6	LT 0100	1.000	45,000.00		.00	.00	.00	100.00	.00	.00	.00	45,000	

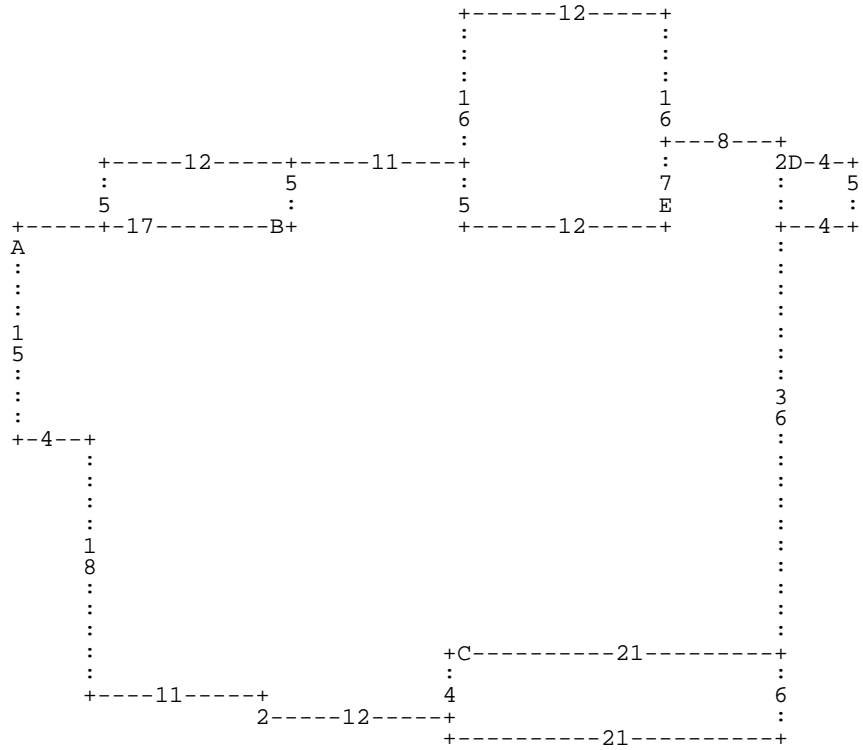

:A DD15 DR4 DD18 DR11 DD2 DR12 DU4 :C DR21 DD6 DL21 DU6 \* DR21 DU36 :D DR4 DD5 D  
 L4 DU5 \* DU2 DL8 DD7 :E DU16 DL12 DD16 DR12 \* DL12 DU5 DL11 DD5 :B DL12 DU5 DR12  
 DD5 \* DL17 \*

- |                   |                      |                   |                     |                   |                      |
|-------------------|----------------------|-------------------|---------------------|-------------------|----------------------|
| <b>A=</b> MA 112  | 1,605.00 SFR-1.5 STY | <b>B=</b> AC 1071 | 60.00 UTILITY STG-F | <b>C=</b> AC 1052 | 126.00 PORCH-OPEN-MA |
| <b>D=</b> AC 1052 | 20.00 PORCH-OPEN-MA  | <b>E=</b> AC 1064 | 192.00 DECK-WOOD    |                   |                      |