

CRANDELL RICHARD LAMARS  
 2611 HIGHFIELD DR W  
 L211S2 WESTHAVEN 1.00LT  
 .250 AC

Wilson County  
 N2 FOUND YR 2024 3712000995.000  
 2611 HIGHFIELD DR W  
 PIN: 3712 00 0995 000  
 DISTRICT: 31 C/CIWI-WILSON

ACCOUNT#: 1119019  
 NBHD: 8362 WESTHAVEN  
 Plat Bk/Pg 36 21  
 EXCD: NOTICE: 82 3/08/2024  
 APPR: KRC APPR DT: 4/03/2020

Bldg No. 1  
 Imp Desc: R1.0 SFR-1.0 STY EYB: 2019 2611 HIGHFIELD DR W Exempt Code  
 Grade : C+10 C+10 GRADE AYB: 2019 Finished Area: 1,443.00  
 # of Units 7 Rms 3 Bedrms 2.0 Bathrms HBaths  
 LAND VALUE 45,000  
 MISC VALUE 0  
 BLDG VALUE 225,116  
 TOTAL VALUE 270,116

TYPE/CODE/DESCRIPTION	PCT	%CMP	UNITS	RATE	STR#	STR%	SIZ%	HGT%	PER%	COST
AC 1052 PORCH-OPEN-MAS	100		100	29.10		100.00	104.00			3,026
AC 1061 PATIO-CONC	100		168	7.50		100.00	102.00			1,285
MA 111 SFR-1.0 STY	100		1443	136.00	1.00		101.88			199,936
- AR 27 ELECTRIC HEAT PUMP	100		1443	.00						0
- EW 02 VINYL SIDING	100		162	.00						0
- FC 50 LAMINATE	100		1443	3.25						4,689
- FN 06 SPREAD FOOTING	100		162	5.30-						858-
- FP 3 1STY SNGL	0		1	5100.00						5,100
- IF 01 DRYWALL	100		1443	.00						0
- RC 07 WOOD SHAKES/3D-SHING	100		1443	.00						0
- RT 04 HIP ROOF	100		1443	.00						0
-----										
RCN...			PCT COMPLETE		100	x				213,178
QUAL..		C+10			110.00	x				234,495
DEPR.. RC					4.00	-		9,379		9,379 T
--ASV...										225,116

PROPERTY NOTES:	PERMIT NO	TYPE	DATE	BOOK	PAGE	DT	DATE	QS	SALES	PRICE
95% COMPLETE ON SFD/12/06/2019/KRC	BP19001091N		6/07/2019	2825	366	WD	3/09/2020			160,000
	AMOUNT	100,000		2781	755	WD	4/18/2019 A			72,000
	AMOUNT			1932	509	SPL	3/20/2007 #			

MISC CODE	DESC	UNITS	RATE	AYB	EYB	DT	PCT	%CMP	ADD.DEPR	PCT	VALUE	EXMPT
							.00					
							.00					
							.00					
							.00					

#	ZONE	TYPE/CODE	LAND QTY	LAND RATE	DPTH	DPT%	TOP%	LOC%	SIZ%	SHP%	OTH%	ADJ	FMV	EXMPT
1	SR6	LT 0100	1.000	45,000.00		.00	.00	.00	100.00	.00	.00	.00	45,000	

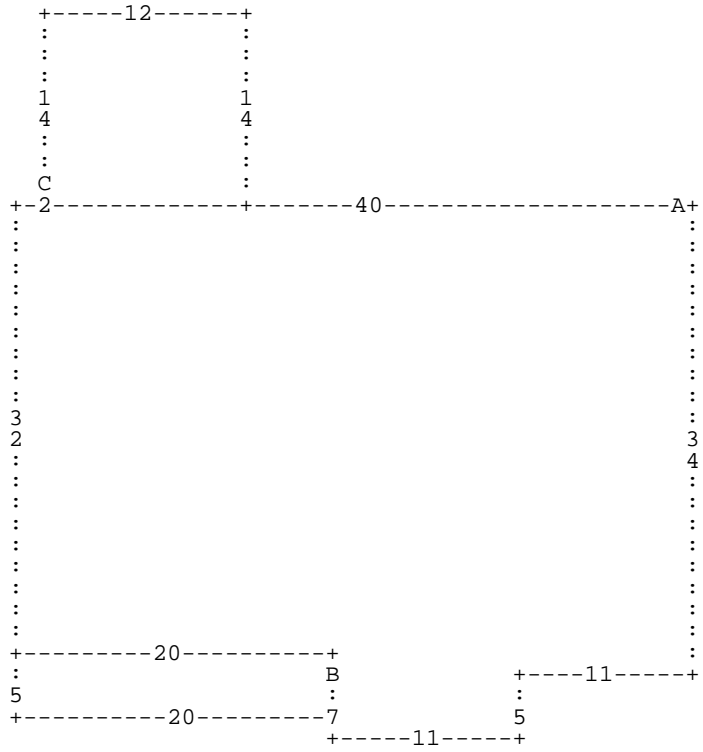

:A DL40 :C DU14 DR12 DD14 DL12 \* DL2 DD32 DR20 :B DD5 DL20 DU5 DR20 \* DD7 DR11 D  
U5 DR11 DU34 \*

**A=** MA 111

1,443.00 SFR-1.0 STY

**B=** AC 1052

100.00 PORCH-OPEN-MA

**C=** AC 1061

168.00 PATIO-CONC