

Wilson County
 SLIPSTREAM RTP REAL ESTATE II N2 FOUND YR 2024 3711365333.000
 2513 SHREVE ST SW 2513 SHREVE ST SW
 L13S4 CRESTVIEW 1.00LT PIN: 3711 36 5333 000
 .363 AC DISTRICT: 31 C/CIWI-WILSON

ACCOUNT#: 1109754 PAGE 1
 NBHD: 8079 CRESTVIEW
 Plat Bk/Pg 11 7 APPR: REV APPR DT: 12/23/2014
 EXCD: NOTICE: 82 3/08/2024

Bldg No. 1 Exempt Code
 Imp Desc: R1.0 SFR-1.0 STY EYB: 1995 2513 SHREVE ST SW LAND VALUE 33,000
 Grade : C+10 C+10 GRADE AYB: 1968 Finished Area: 1,540.00 MISC VALUE 10,953
 # of Units 5 Rms 3 Bedrms 2.0 Bathrms HBaths BLDG VALUE 182,850
 TOTAL VALUE 226,803

TYPE/CODE/DESCRIPTION	PCT	%CMP	UNITS	RATE	STR#	STR%	SIZ%	HGT%	PER%	COST
AC 1031 CARPORT	100		280	27.90			97.00			7,577
AC 1053 STOOP-MAS	100		24	19.40			120.00			558
AC 1061 PATIO-CONC	100		400	7.50			55.00			1,650
AC 1071 UTILITY STG-FR	100		112	39.45			104.00			4,595
MA 111 SFR-1.0 STY	100		1540	136.00	1.00		100.63			210,758
- AR 10 FORCED AIR HEAT W/ A100	100		1540	.00						0
- EW 18 BRICK VENEER	100		166	35.00						5,810
- FC 54 CARPET/ASPHALT TILE	100		1540	1.25-						1,925-
- FN 03 CONT WALL-BRICK	100		166	.00						0
- FP 3 1STY SNGL	100		1	5100.00						5,100
- IF 30 DRYWALL/CUSTOM	100		1540	.00						0
- RC 02 COMPOSITION SHINGLE	100		1540	.00						0
- RT 03 DOUBLE PITCH ROOF	100		1540	.00						0
RCN...		PCT COMPLETE			100	x				234,123
QUAL..	C+10				110.00	x				257,535
DEPR.. RC					29.00	-		74,685		74,685 T
--ASV...										182,850

PROPERTY NOTES:

PERMIT NO	TYPE	DATE	BOOK	PAGE	DT	DATE	QS	SALES	PRICE
			2709	772	TD	8/03/2017	P		66,000
	AMOUNT		2583	917	WD	8/08/2014			89,000
			2010	CDTH	CDTH	3/15/2010	E		
	AMOUNT		2000E	429	WI	9/04/2000	E		

MISC CODE	DESC	UNITS	RATE	AYB	EYB	DT	PCT	%CMP	ADD.DEPR	PCT	VALUE	EXMPT
81 1173	STORAGE 010 X 020	200.00	24.00	1962	1978	MAV	65.00	100			1,580	
82 1121	GARAGE 020 X 026	520.00	51.50	1968	1981	MAV	65.00	100			9,373	
							.00					
							.00					

#	ZONE	TYPE/CODE	LAND QTY	LAND RATE	DPTH	DPT%	TOP%	LOC%	SIZ%	SHF%	OTH%	ADJ	FMV	EXMPT
1	SR6	LT 0100	1.000	30,000.00	140	.00	.00	.00	110.00	.00	.00	110.00	33,000	

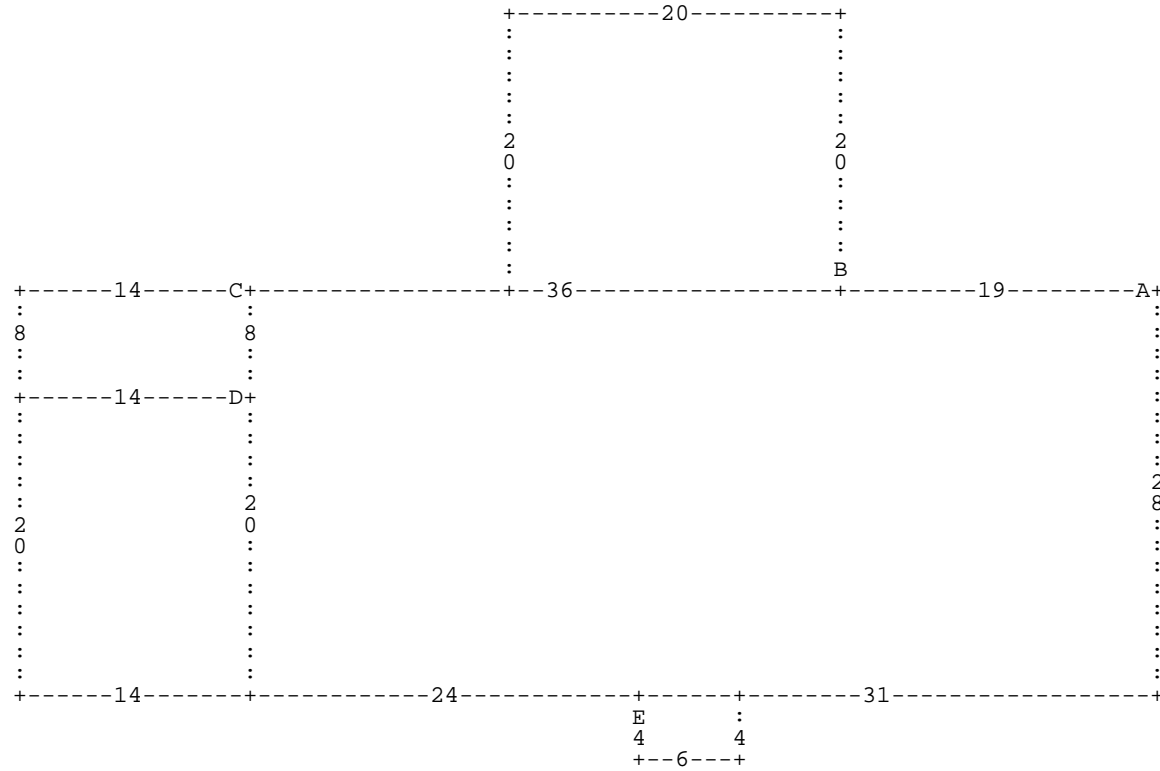

:A DL19 :B DU20 DL20 DD20 DR20 * DL36 :C DL14 DD8 DR14 DU8 * DD8 :D DL14 DD20 DR
 14 DU20 * DD20 DR24 :E DD4 DR6 DU4 DL6 * DR31 DU28 *

A= MA 111
 D= AC 1031

1,540.00 SFR-1.0 STY
 280.00 CARPORT

B= AC 1061
 E= AC 1053

400.00 PATIO-CONC
 24.00 STOOP-MAS

C= AC 1071

112.00 UTILITY STG-F