

WILLIAMS JACQUELINE
 2514 MCNAIR ST SW
 L4S2 CRESTVIEW 1.00LT
 .239 AC

Wilson County
 YR 2024 3711355864.000
 2514 MCNAIR ST SW
 PIN: 3711 35 5864 000
 DISTRICT: 31 C/CIWI-WILSON

ACCOUNT#: 1107707
 NBHD: 8079 CRESTVIEW
 Plat Bk/Pg 10 54
 EXCD: NOTICE: 82 3/08/2024
 APPR: REV APPR DT: 12/17/2014

Bldg No. 1
 Imp Desc: R1.0 SFR-1.0 STY EYB: 1995 2514 MCNAIR ST SW Exempt Code LAND VALUE 30,000
 Grade : C+05 C+05 GRADE AYB: 1968 Finished Area: 1,760.00 MISC VALUE 968
 # of Units 5 Rms 3 Bedrms 2.0 Bathrms HBaths BLDG VALUE 186,917
 TOTAL VALUE 217,885

TYPE/CODE/DESCRIPTION	PCT	%CMP	UNITS	RATE	STR#	STR%	SIZ%	HGT%	PER%	COST
AC 1031 CARPORT	100		280	27.90			97.00			7,577
AC 1053 STOOP-MAS	100		24	19.40			120.00			558
AC 1071 UTILITY STG-FR	100		72	39.45			106.00			3,010
MA 111 SFR-1.0 STY	100		1760	136.00	1.00		98.00			234,572
- AR 10 FORCED AIR HEAT W/ A100			1760	.00						0
- EW 18 BRICK VENEER	100		206	35.00						7,210
- FC 54 CARPET/ASPHALT TILE	100		1760	1.25-						2,200-
- FN 03 CONT WALL-BRICK	100		206	.00						0
- IF 01 DRYWALL	100		1760	.00						0
- RC 02 COMPOSITION SHINGLE	100		1760	.00						0
- RT 03 DOUBLE PITCH ROOF	100		1760	.00						0

RCN...			PCT COMPLETE		100	x				250,727
QUAL..		C+05			105.00	x				263,263
DEPR.. RC					29.00	-		76,346		76,346 T
--ASV...										186,917

PROPERTY NOTES:

PERMIT NO	TYPE	DATE	BOOK	PAGE	DT	DATE	QS	SALES	PRICE
			2675	501	WD	10/31/2016			98,000
AMOUNT			1997	CDTH	CDTH	12/09/2015	E		
					@	10/25/1999	@		
AMOUNT			1200	239	WD	12/23/1980	E		

MISC CODE	DESC	UNITS	RATE	AYB	EYB	DT	PCT	%CMP	ADD.DEPR	PCT	VALUE	EXMPT
81 1173	STORAGE 010 X 012	120.00	24.00	1968	1983	MAV	65.00	100			968	
							.00					
							.00					
							.00					

#	ZONE	TYPE/CODE	LAND QTY	LAND RATE	DPTH	DPT%	TOP%	LOC%	SIZ%	SHP%	OTH%	ADJ	FMV	EXMPT
1	SR6	LT 0100	1.000	30,000.00	140	.00	.00	.00	100.00	.00	.00	.00	30,000	

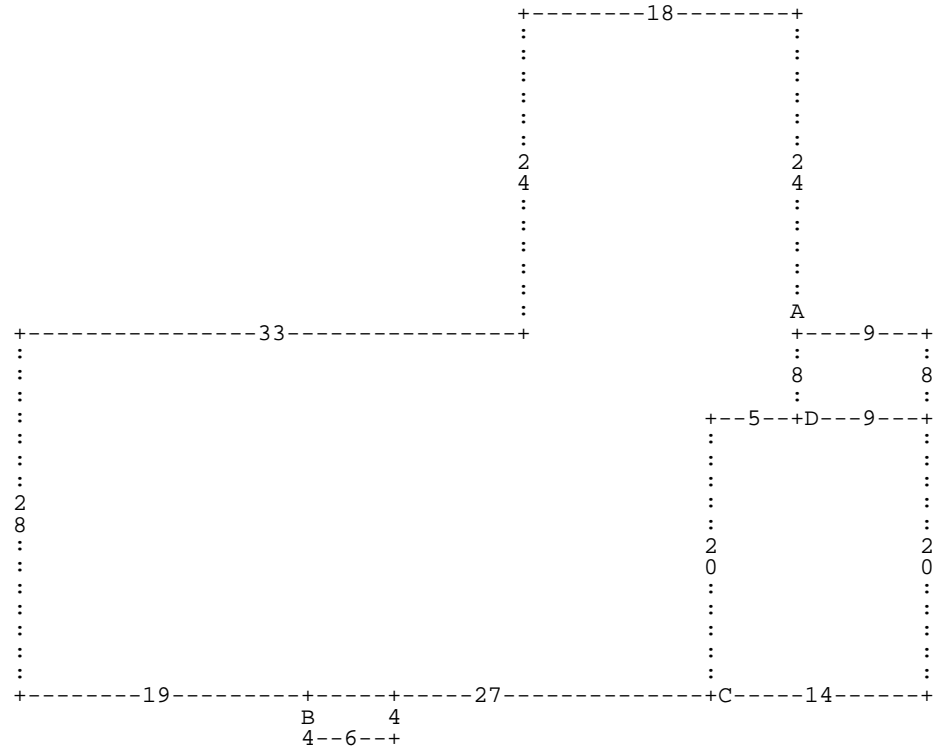

:A DU24 DL18 DD24 DL33 DD28 DR19 :B DD4 DR6 DU4 DL6 * DR27 :C DR14 DU20 DL14 DD2
 0 * DU20 DR5 :D DR9 DU8 DL9 DD8 * DU8 *

A= MA 111
 D= AC 1071

1,760.00 SFR-1.0 STY
 72.00 UTILITY STG-F

B= AC 1053

24.00 STOOP-MAS

C= AC 1031

280.00 CARPORT