

SWAIN DANIEL T
 1109 SUNNYBROOK RD S
 BK-F L15 WILLOW SPRNGS1LT
 .359 AC

N2 FOUND YR 2024 3710378001.000
 1109 SUNNYBROOK RD S
 PIN: 3710 37 8001 000
DISTRICT: 31 C/CIWI-WILSON

Wilson County

ACCOUNT#: 1104271
NBHD: 8371 WILLOW_SPRINGS
 Plat Bk/Pg 12 100 APPR: REV APPR DT: 4/14/2015
EXCD: NOTICE: 82 3/08/2024

Bldg No. 1
 Imp Desc: R1.0 SFR-1.0 STY EYB: 1990 1109 SUNNYBROOK RD S Exempt Code
 Grade : C+05 C+05 GRADE AYB: 1977 Finished Area: 1,713.00
 # of Units 5 Rms 3 Bedrms 2.0 Bathrms HBaths

LAND VALUE 30,000
MISC VALUE 968
BLDG VALUE 177,028
TOTAL VALUE 207,996

TYPE/CODE/DESCRIPTION	PCT	%CMP	UNITS	RATE	STR#	STR%	SIZ%	HGT%	PER%	COST
AC 1021 GARAGE-ATT-FR	100		576	42.55			90.00			22,057
AC 1052 PORCH-OPEN-MAS	100		52	29.10			106.00			1,603
AC 1054 PORCH-SCR-MAS	100		168	45.80			102.00			7,848
AC 1071 UTILITY STG-FR	100		75	39.45			106.00			3,136
MA 111 SFR-1.0 STY	100		1713	136.00	1.00		98.50			229,473
- AR 14 GAS PACK	100		1713	.00						0
- EW 02 VINYL SIDING	100		184	.00						0
- FC 48 VINYL/CARPET	100		1713	.00						0
- FN 03 CONT WALL-BRICK	100		184	.00						0
- FP 2 PREFAB	100		1	3500.00						3,500
- IF 01 DRYWALL	100		1713	.00						0
- RC 02 COMPOSITION SHINGLE	100		1713	.00						0
- RT 03 DOUBLE PITCH ROOF	100		1713	.00						0

RCN...			PCT COMPLETE		100	x				267,617
QUAL..		C+05			105.00	x				280,997
DEPR.. RC					37.00	-		103,969		103,969
--ASV...										177,028

PROPERTY NOTES:

PERMIT NO	TYPE	DATE	BOOK	PAGE	DT	DATE	QS	SALES	PRICE
			2784	892	WD	5/15/2019			85,000
AMOUNT			2007	CDTH	CDTH	1/01/2014	E		
					@	10/25/1999	@		
AMOUNT			1135	363	WD	3/15/1977			5,000

MISC CODE	DESC	UNITS	RATE	AYB	EYB	DT	PCT	%CMP	ADD.DEPR	PCT	VALUE	EXMPT
81 1173	STG-FR 10 X 12	120.00	24.00	1977	1977	MAV	65.00	100			968	
							.00					
							.00					
							.00					

#	ZONE	TYPE/CODE	LAND QTY	LAND RATE	DPTH	DPT%	TOP%	LOC%	SIZ%	SHP%	OTH%	ADJ	FMV	EXMPT
1	SR4	LT 0100	1.000	30,000.00		.00	.00	.00	100.00	.00	.00	.00	30,000	

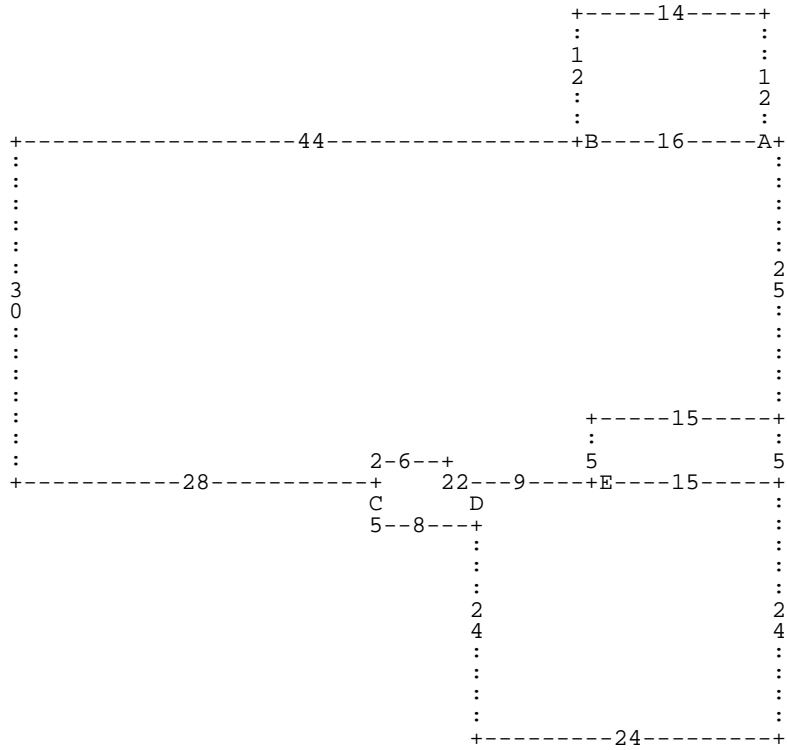

:A DL16 :B DR14 DU12 DL14 DD12 * DL44 DD30 DR28 :C DD5 DR8 DU5 DL2 DU2 DL6 DD2 *
 DU2 DR6 DD2 DR2 :D DD24 DR24 DU24 DL24 * DR9 :E DR15 DU5 DL15 DD5 * DU5 DR15 DU
 25 *

A= MA 111
D= AC 1021

1,713.00 SFR-1.0 STY
 576.00 GARAGE-ATT-FR

B= AC 1054
E= AC 1071

168.00 PORCH-SCR-MAS
 75.00 UTILITY STG-F

C= AC 1052

52.00 PORCH-OPEN-MA