

WILLIAMS CHARLES B  
 5907 WEST BAKER RD  
 L353 BAKERS MOB AC 1.00LT  
 1.010 AC

Wilson County  
 YR 2024 3704561846.000  
 5907 WEST BAKER RD  
 PIN: 3704 56 1846 000  
 DISTRICT: 14 C/SW/SILVER LAK SWAF

ACCOUNT#: 1079365  
 NBHD: 8420 BAKERS ACRES  
 Plat Bk/Pg 12 129 APPR: REV APPR DT: 4/20/2015  
 1.00 EXCD: NOTICE: 82 3/08/2024

Bldg No. 1 Exempt Code  
 Imp Desc: DW MH-DOUBLE WIDE EYB: 2000 5907 WEST BAKER RD  
 Grade : C+05 C+05 GRADE AYB: 1990 Finished Area: 1,728.00  
 # of Units 5 Rms 3 Bedrms 2.0 Bathrms HBaths  
 Manufacturer: Serial#: Model:

LAND VALUE 30,000  
 MISC VALUE 12,460  
 BLDG VALUE 135,227  
 TOTAL VALUE 177,687

TYPE/CODE/DESCRIPTION	PCT	%CMP	UNITS	RATE	STR#	STR%	SIZ%	HGT%	PER%	COST
AC 1031 CARPORT	100		780	27.90			90.00			19,585
AC 1052 PORCH-OPEN-MAS	100		144	29.10			102.00			4,274
AC 1054 PORCH-SCR-MAS	100		84	45.80			106.00			4,078
AC 1064 DECK-WOOD	100		224	24.95			100.00			5,588
MA 152 MFG-DOUBLE WIDE	100		1728	111.00	1.00		94.50			181,258
- AR 10 FORCED AIR HEAT W/ A100			1728	.00						0
- EW 02 VINYL SIDING	100		182	.00						0
- FC 48 VINYL/CARPET	100		1728	.00						0
- FN 03 CONT WALL-BRICK	100		182	.00						0
- FP 2 PREFAB	100		1	3500.00						3,500
- IF 01 DRYWALL	100		1728	.00						0
- RC 02 COMPOSITION SHINGLE	100		1728	.00						0
- RT 03 DOUBLE PITCH ROOF	100		1728	.00						0

RCN... PCT COMPLETE 100 x 218,283  
 QUAL.. C+05 105.00 x 229,197  
 DEPR.. MC 41.00 - 93,970 T 93,970  
 --ASV... 135,227

PROPERTY NOTES:	PERMIT NO	TYPE	DATE	BOOK	PAGE	DT	DATE	QS	SALES	PRICE
PERMIT CODE: N MO/YR: 041998 NOTE: 3000				2021	CDTH	CDTH	5/02/2021	E		
	AMOUNT			1321	232	@	10/25/1999	@		10,000
	AMOUNT					WD	3/11/1987			

MISC CODE	DESC	UNITS	RATE	AYB	EYB	DT	PCT	%CMP	ADD.DEPR	PCT	VALUE	EXMPT
81 1173	STG-FR 15 X 12	180.00	24.00	1990	1990	MAV	65.00	100			1,421	
82 038	SHED-IMPLEMENT 20 X 12	240.00	9.75	1990	1990	MAV	65.00	100			770	
83 1121	GAR-DET-FR 36 X 24	864.00	51.50	1996	1996	MFR	75.00	100			7,509	
84 1173	STG-FR 12 X 20	240.00	24.00	1995	1995	MAV	65.00	100			1,895	

#	ZONE	TYPE/CODE	LAND QTY	LAND RATE	DPTH	DPT%	TOP%	LOC%	SIZ%	SHP%	OTH%	ADJ	FMV	EXMPT
1	AR	LT 0210	1.000	30,000.00		.00	.00	.00	100.00	.00	.00	.00	30,000	

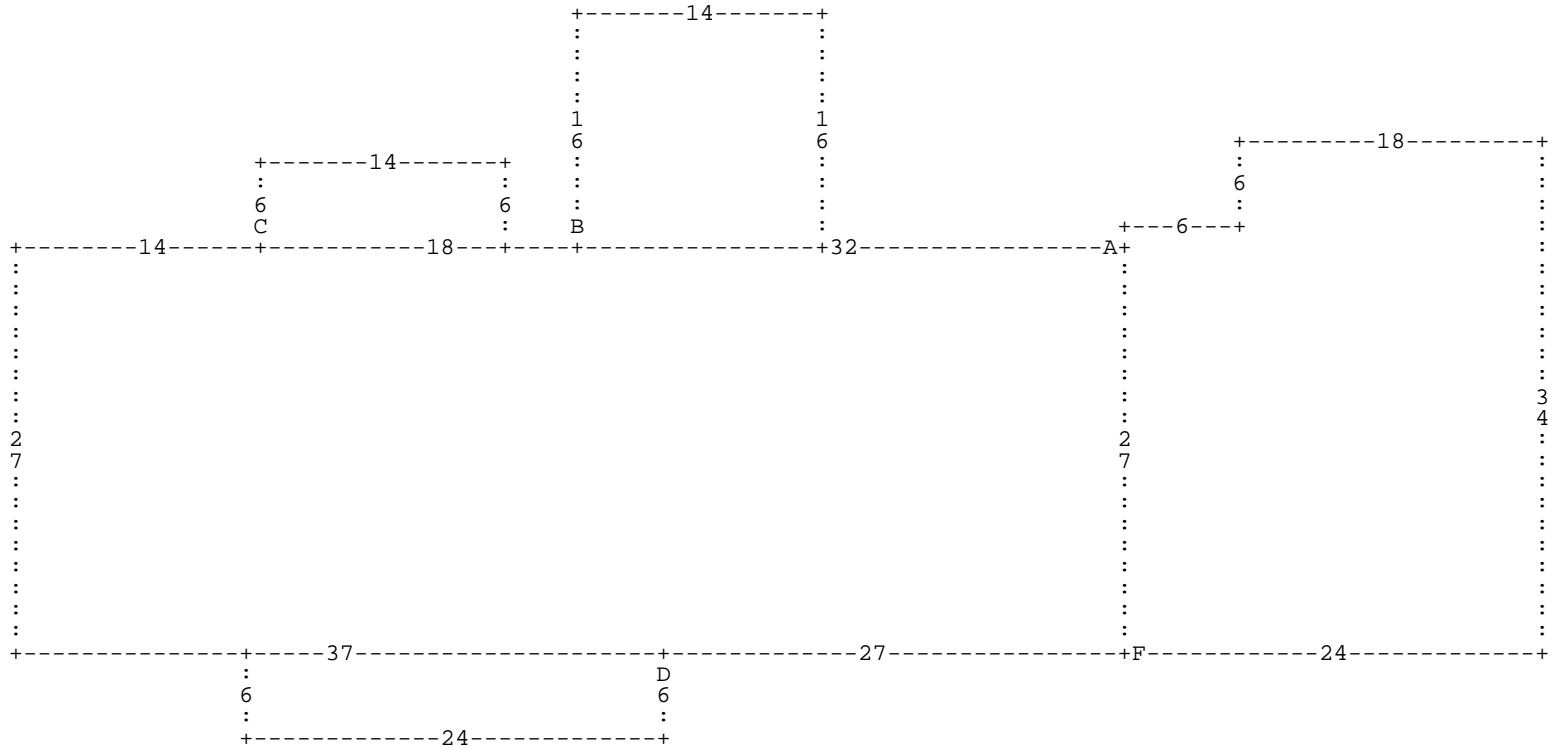

:A DL32 :B DU16 DR14 DD16 DL14 \* DL18 :C DU6 DR14 DD6 DL14 \* DL14 DD27 DR37 :D D  
 D6 DL24 DU6 DR24 \* DR27 :F DR24 DU34 DL18 DD6 DL6 DD28 \* DU27 \*

**A=** MA 152  
**D=** AC 1052

1,728.00 MFG-DOUBLE WI  
 144.00 PORCH-OPEN-MA

**B=** AC 1064  
**F=** AC 1031

224.00 DECK-WOOD  
 780.00 CARPORT

**C=** AC 1054

84.00 PORCH-SCR-MAS

WILLIAMS CHARLES B  
 5907 WEST BAKER RD  
 L353 BAKERS MOB AC 1.00LT  
 1.010 AC

Wilson County  
 YR 2024 **3704561846.000**  
 5907 WEST BAKER RD  
 PIN: 3704 56 1846 000  
**DISTRICT:** 14 C/SW/SILVER LAK SWAF

**ACCOUNT#:** 1079365 **PAGE** 3  
**NBHD:** 8420 BAKERS ACRES  
 Plat Bk/Pg 12 129 **APPR:** REV APPR DT: 4/20/2015  
 1.00 EXCD: NOTICE: 82 3/08/2024

Bldg No. 1 Exempt Code  
 Imp Desc: DW MH-DOUBLE WIDE EYB: 2000 5907 WEST BAKER RD  
 Grade : C+05 C+05 GRADE AYB: 1990 Finished Area: 1,728.00  
 # of Units 5 Rms 3 Bedrms 2.0 Bathrms HBaths

-----  
**TYPE/CODE/DESCRIPTION PCT %CMP UNITS RATE STR# STR% SIZ% HGT% PER% COST**  
 -----

PROPERTY NOTES:

PERMIT NO	TYPE	DATE	BOOK	PAGE	DT	DATE	QS	SALES	PRICE

MISC CODE	DESC	UNITS	RATE	AYB	EYB	DT	PCT	%CMP	ADD.DEPR	PCT	VALUE	EXMPT
85 1143	SHELTER-OPEN 20 X 12	240.00	10.50	1995	1995	MAV	65.00	100			865	
							.00					
							.00					
							.00					

#	ZONE	TYPE/CODE	LAND QTY	LAND RATE	DPTH	DPT%	TOP%	LOC%	SIZ%	SHP%	OTH%	ADJ	FMV	EXMPT
---	------	-----------	----------	-----------	------	------	------	------	------	------	------	-----	-----	-------

