

ROBLES ORVELIN URIETA  
 3900 HUNTSMOOR LN NW  
 L174S5PH2 JETSTRM PK 1LT  
 .190 AC

N2 FOUND YR 2024 **3703959638.000**  
 3900 HUNTSMOOR LN NW  
 PIN: 3703 95 9638 000  
**DISTRICT:** 31 C/CIWI-WILSON

Wilson County

**ACCOUNT#:** 1123222 **PAGE** 1  
**NBHD:** 8162 LANTERN\_SQUARE  
 Plat Bk/Pg 34 219 **APPR:** REV APPR DT: 1/21/2015  
**EXCD:** NOTICE: 82 3/08/2024

Bldg No. 1  
 Imp Desc: R1.0 SFR-1.0 STY EYB: 2008 3900 HUNTSMOOR LN NW Exempt Code  
 Grade : C+10 C+10 GRADE AYB: 2008 Finished Area: 1,222.00  
 # of Units 5 Rms 3 Bedrms 2.0 Bathrms HBaths

**LAND VALUE** 35,000  
**MISC VALUE** 0  
**BLDG VALUE** 173,833  
**TOTAL VALUE** 208,833

TYPE/CODE/DESCRIPTION	PCT	%CMP	UNITS	RATE	STR#	STR%	SIZ%	HGT%	PER%	COST
AC 1051 PORCH-OPEN-FR	100		30	38.80		100.00	120.00			1,396
AC 1061 PATIO-CONC	100		192	7.50		100.00	60.00			864
AC 1071 UTILITY STG-FR	100		25	39.45		100.00	120.00			1,183
MA 111 SFR-1.0 STY	100		1222	136.00	1.00		105.12			174,700
- AR 10 FORCED AIR HEAT W/ A100			1222	.00						0
- EW 02 VINYL SIDING	100		146	.00						0
- FC 48 VINYL/CARPET	100		1222	.00						0
- FN 03 CONT WALL-BRICK	100		146	.00						0
- FP 2 PREFAB	100		1	3500.00						3,500
- IF 01 DRYWALL	100		1222	.00						0
- RC 07 WOOD SHAKES/3D-SHING	100		1222	.00						0
- RT 03 DOUBLE PITCH ROOF	100		1222	.00						0
RCN...			PCT COMPLETE		100	x				181,643
QUAL..	C+10				110.00	x				199,807
DEPR.. RC					13.00	-		25,974		25,974 T
--ASV...										173,833

PROPERTY NOTES:

PERMIT NO	TYPE	DATE	BOOK	PAGE	DT	DATE	QS	SALES	PRICE
BP00081110N		4/28/2008	2907	277	SWD	7/12/2021	I	145,500	
AMOUNT		92,000	2838	188	TD	6/16/2020	P	99,500	
AMOUNT			2734	2	WD	3/01/2018		125,000	
			2013		CDTH	10/18/2013	E		

MISC CODE	DESC	UNITS	RATE	AYB	EYB	DT	PCT	%CMP	ADD.DEPR	PCT	VALUE	EXMPT
							.00					
							.00					
							.00					
							.00					

#	ZONE	TYPE/CODE	LAND	QTY	LAND RATE	DPTH	DPT%	TOP%	LOC%	SIZ%	SHP%	OTH%	ADJ	FMV	EXMPT
1	GR6	LT 0100		1.000	35,000.00		.00	.00	.00	100.00	.00	.00	.00	35,000	

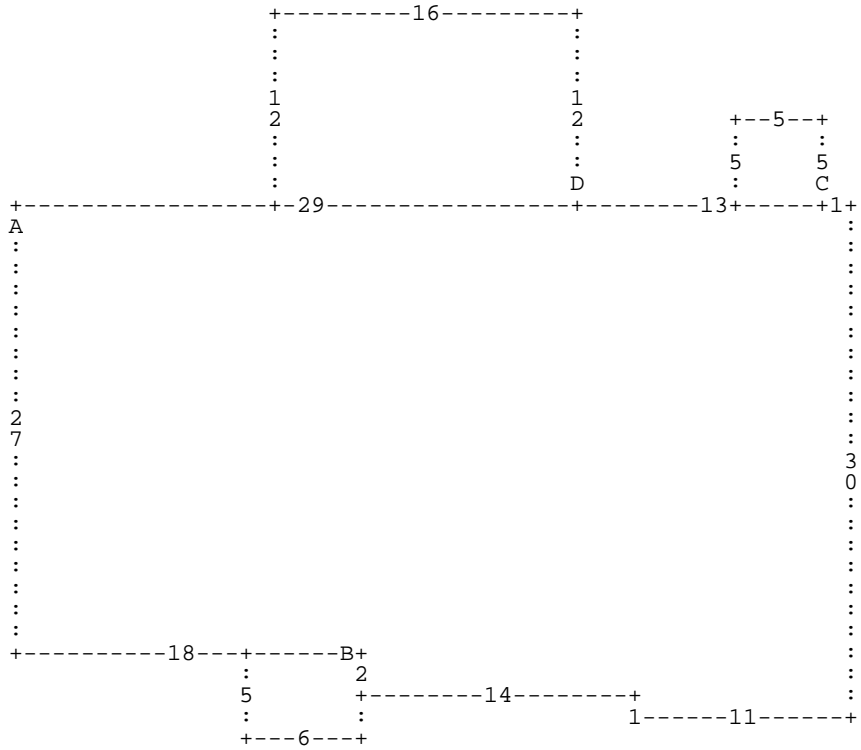

:A DD27 DR18 :B DL6 DD5 DR6 DU5 \* DD2 DR14 DD1 DR11 DU30 DL1 :C DU5 DL5 DD5 DR5  
 \* DL13 :D DU12 DL16 DD12 DR16 \* DL29 \*

**A=** MA 111  
**D=** AC 1061

1,222.00 SFR-1.0 STY  
 192.00 PATIO-CONC

**B=** AC 1051

30.00 PORCH-OPEN-FR

**C=** AC 1071

25.00 UTILITY STG-F