

GRIFFIN JEAN S  
 3603 FULTON PL NW  
 L60S4 WOODRIDGE WST 1.00LT  
 .470 AC

Wilson County  
 N2 FOUND YR 2024 3703815129.000  
 3603 FULTON PL NW  
 PIN: 3703 81 5129 000  
 DISTRICT: 31 C/CIWI-WILSON

ACCOUNT#: 1122257  
 NBHD: 8401 WOODRIDGE\_WEST  
 Plat Bk/Pg 28 218 APPR: REV APPR DT: 7/07/2006  
 EXCD: NOTICE: 82 3/08/2024

Bldg No.	1	Exempt Code		LAND VALUE	55,000
Imp Desc:	R1.0 SFR-1.0 STY	EYB: 2000	3603 FULTON PL NW	MISC VALUE	0
Grade :	B-10 B-10 GRADE	AYB: 2000	Finished Area:	BLDG VALUE	211,032
# of Units	5 Rms 3 Bedrms 2.0 Bathrms HBaths		1,577.00	TOTAL VALUE	266,032

TYPE/CODE/DESCRIPTION	PCT	%CMP	UNITS	RATE	STR#	STR%	SIZ%	HGT%	PER%	COST
AC 1052	PORCH-OPEN-MAS	100	64	29.10			106.00			1,974
AC 1053	STOOP-MAS	100	16	19.40			120.00			372
AC 1064	DECK-WOOD	100	180	24.95			100.00			4,491
AC 1071	UTILITY STG-FR	100	30	39.45			120.00			1,420
MA 111	SFR-1.0 STY	100	1577	136.00	1.00		100.00			214,472
- AR 27	ELECTRIC HEAT PUMP	100	1577	.00						0
- EW 02	VINYL SIDING	100	198	.00						0
- FC 20	HARDWOOD/CARPET	100	1577	2.00						3,154
- FN 02	CONT WALL-CONC BLOCK	100	198	.00						0
- FP 2	PREFAB	100	1	3500.00						3,500
- IF 30	DRYWALL/CUSTOM	100	1577	.00						0
- RC 07	WOOD SHAKES/3D-SHING	100	1577	.00						0
- RT 04	HIP ROOF	100	1577	.00						0
-----										
	RCN...		PCT COMPLETE		100	x				229,383
	QUAL..	B-10			115.00	x				263,790
	DEPR.. RB				20.00	-		52,758		52,758 T
	--ASV...									211,032

PROPERTY NOTES:	PERMIT NO	TYPE	DATE	BOOK	PAGE	DT	DATE	QS	SALES	PRICE
PERMIT CODE: N MO/YR: 012000 NOTE: 72000				2889	697	WD	4/12/2021	C	2,000	
	AMOUNT			2706	375	STD	7/07/2017	P	131,500	
				2487	268	WD	5/24/2012		138,500	
	AMOUNT			2482	913	WD	4/17/2012		134,000	

MISC CODE	DESC	UNITS	RATE	AYB	EYB	DT	PCT	%CMP	ADD.DEPR	PCT	VALUE	EXMPT
							.00					
							.00					
							.00					
							.00					

#	ZONE	TYPE/CODE	LAND QTY	LAND RATE	DPTH	DPT%	TOP%	LOC%	SIZ%	SHP%	OTH%	ADJ	FMV	EXMPT
1	SR6	LT 0100	1.000	55,000.00		.00	.00	.00	100.00	.00	.00	.00	55,000	

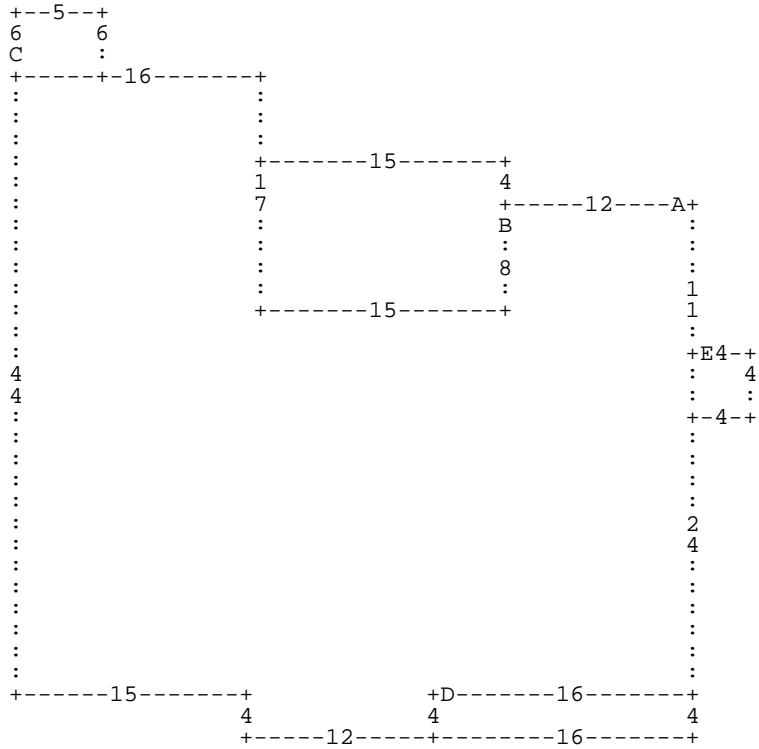

:A DL12 :B DD8 DL15 DU12 DR15 DD4 \* DD8 DL15 DU17 DL16 :C DU6 DR5 DD6 DL5 \* DD44  
DR15 DD4 DR12 DU4 :D DR16 DD4 DL16 DU4 \* DR16 DU24 :E DR4 DD4 DL4 DU4 \* DU11 \*

A= MA 111	1,577.00 SFR-1.0 STY	B= AC 1064	180.00 DECK-WOOD	C= AC 1071	30.00 UTILITY STG-F
D= AC 1052	64.00 PORCH-OPEN-MA	E= AC 1053	16.00 STOOP-MAS		