

SIKES GAINUS SR
 3821 ALTHORP DR W
 L91S6 HERITAGE PL 1.00LT
 .280 AC

Wilson County
 N2 FOUND YR 2024 3702548863.000
 3821 ALTHORP DR W
 PIN: 3702 54 8863 000
 DISTRICT: 31 C/CIWI-WILSON

ACCOUNT#: 1060573
 NBHD: 8189 MEADOWMONT
 Plat Bk/Pg 32 211
 EXCD: NOTICE: 82 3/08/2024
 APPR: REV APPR DT: 2/26/2015

Bldg No. 1
 Imp Desc: R1.5 SFR-UPTO 1.5 STY EYB: 2004 3821 ALTHORP DR W Exempt Code LAND VALUE 50,000
 Grade : B-10 B-10 GRADE AYB: 2004 Finished Area: 1,806.00 MISC VALUE 0
 # of Units 5 Rms 3 Bedrms 2.0 Bathrms HBaths BLDG VALUE 236,437
 TOTAL VALUE 286,437

TYPE/CODE/DESCRIPTION	PCT	%CMP	UNITS	RATE	STR#	STR%	SIZ%	HGT%	PER%	COST
AC 1021 GARAGE-ATT-FR	100		500	42.55			90.00			19,147
AC 1052 PORCH-OPEN-MAS	100		165	29.10			102.00			4,897
AC 1061 PATIO-CONC	100		168	7.50			60.00			756
AC 1064 DECK-WOOD	100		132	24.95			102.00			3,359
MA 112 SFR-1.5 STY	100		1806	116.00	1.00		97.50			204,258
- AR 10 FORCED AIR HEAT W/ A100			1806	.00						0
- AT UAT UNF ATTIC	11		198	27.00			97.50			5,212
- EW 02 VINYL SIDING	100		224	.00						0
- FC 20 HARDWOOD/CARPET	100		1806	2.00						3,612
- FN 02 CONT WALL-CONC BLOCK100			224	.00						0
- FP 2 PREFAB	100		1	3500.00						3,500
- IF 48 CUSTOM INTERIOR	100		1806	.00						0
- RC 07 WOOD SHAKES/3D-SHING100			1806	.00						0
- RT 03 DOUBLE PITCH ROOF	100		1806	.00						0

RCN...			PCT COMPLETE		100	x				244,741
QUAL..	B-10				115.00	x				281,472
DEPR.. RB					16.00	-		45,035		45,035 T
--ASV...										236,437

PROPERTY NOTES:	PERMIT NO	TYPE	DATE	BOOK	PAGE	DT	DATE	QS	SALES	PRICE
HSE '05				2321	454	WD	6/16/2008			185,000
	AMOUNT			2048	544	WD	7/23/2004			177,000
	AMOUNT			1858	679	@	2/20/2004 @			
						WD	1/16/2002 X			

MISC CODE	DESC	UNITS	RATE	AYB	EYB	DT	PCT	%CMP	ADD.DEPR	PCT	VALUE	EXMPT
							.00					
							.00					
							.00					
							.00					

#	ZONE	TYPE/CODE	LAND QTY	LAND RATE	DPTH	DPT%	TOP%	LOC%	SIZ%	SHP%	OTH%	ADJ	FMV	EXMPT
1	SR6	LT 0100	1.000	50,000.00		.00	.00	.00	100.00	.00	.00	.00	50,000	

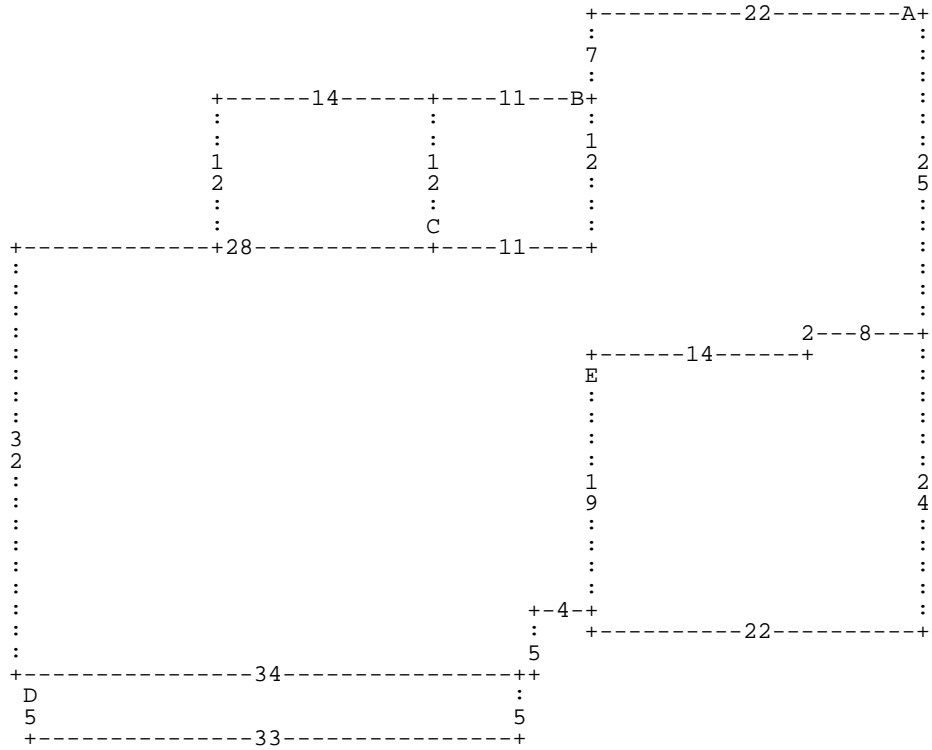

:A DL22 DD7 :B DL11 DD12 DR11 DU12 * DD12 DL11 :C DU12 DL14 DD12 DR14 * DL28 DD3
 2 DR1 :D DD5 DR33 DU5 DL33 * DR34 DU5 DR4 DU19 :E DD22 DR22 DU24 DL8 DD2 DL14 *
 DR14 DU2 DR8 DU25 *

A= MA 112
 D= AC 1052

1,806.00 SFR-1.5 STY
 165.00 PORCH-OPEN-MA

B= AC 1064
 E= AC 1021

132.00 DECK-WOOD
 500.00 GARAGE-ATT-FR

C= AC 1061

168.00 PATIO-CONC