

NEAL OLLIE B  
 3001 CRANBERRY RIDGE DR SW  
 L110S2 CRANBERRY RDG1.00LT  
 .240 AC

N2 FOUND YR 2024 **3701981674.000**  
 3001 CRANBERRY RDG DR SW  
 PIN: 3701 98 1674 000  
**DISTRICT:** 31 C/CIWI-WILSON

Wilson County

**ACCOUNT#:** 1107801  
**NBHD:** 8076 CRANBERRY RIDGE  
 Plat Bk/Pg 29 110 APPR: JHB APPR DT: 3/22/2017  
 EXCD: ELD2 NOTICE: 82 3/08/2024

Bldg No. 1  
 Imp Desc: 0501 SFR-PATIO HOME EYB: 2016 3001 CRANBERRY RIDGE DR SW Exempt Code  
 Grade : C+10 C+10 GRADE AYB: 2016 Finished Area: 1,286.00  
 # of Units 6 Rms 3 Bedrms 2.0 Bathrms HBaths

**LAND VALUE** 35,000  
**MISC VALUE** 0  
**BLDG VALUE** 197,344  
**TOTAL VALUE** 232,344

TYPE/CODE/DESCRIPTION	PCT	%CMP	UNITS	RATE	STR#	STR%	SIZ%	HGT%	PER%	COST
AC 1052 PORCH-OPEN-MAS	100		108	29.10		100.00	104.00			3,268
AC 1052 PORCH-OPEN-MAS	100		112	29.10		100.00	104.00			3,389
AC 1071 UTILITY STG-FR	100		44	39.45		100.00	88.00			1,527
AC 2071 UTILITY STG-FR	100		80	28.50		100.00	70.00			1,596
MA 161 SFR-PATIO HOME	100		1286	136.00	1.00		104.00			181,891
- AR 14 GAS PACK	100		1286	.00						0
- EW 02 VINYL SIDING	100		154	.00						0
- FC 48 VINYL/CARPET	100		1286	.00						0
- FN 06 SPREAD FOOTING	100		154	5.30-						816-
- IF 01 DRYWALL	100		1286	.00						0
- RC 07 WOOD SHAKES/3D-SHING	100		1286	.00						0
- RT 03 DOUBLE PITCH ROOF	100		1286	.00						0
RCN...			PCT COMPLETE		100	x				190,855
QUAL..	C+10				110.00	x				209,940
DEPR.. RC					6.00	-		12,596		12,596 T
--ASV...										197,344

PROPERTY NOTES:  
 100% COMPLETE/11/18/2016/JHB; ADD FUT 4 18. 2023 LIST: NEW  
 FLR CVR \$1827.

PERMIT NO	TYPE	DATE	BOOK	PAGE	DT	DATE	QS	SALES	PRICE
BP00170760		1/25/2017	2679	112	WD	11/29/2016		126,000	
AMOUNT			2666	456	WD	8/16/2016	A	37,500	
BP01602088N		8/19/2016	1472	392	@	8/02/2000	@		
AMOUNT		122,934	1777	6	WD	7/24/2000	X		

MISC CODE	DESC	UNITS	RATE	AYB	EYB	DT	PCT	%CMP	ADD.DEPR	PCT	VALUE	EXMPT
							.00					
							.00					
							.00					
							.00					

#	ZONE	TYPE/CODE	LAND QTY	LAND RATE	DPTH	DPT%	TOP%	LOC%	SIZ%	SHP%	OTH%	ADJ	FMV	EXMPT
1	SR6	LT 0150	1.000	35,000.00		.00	.00	.00	100.00	.00	.00	.00	35,000	

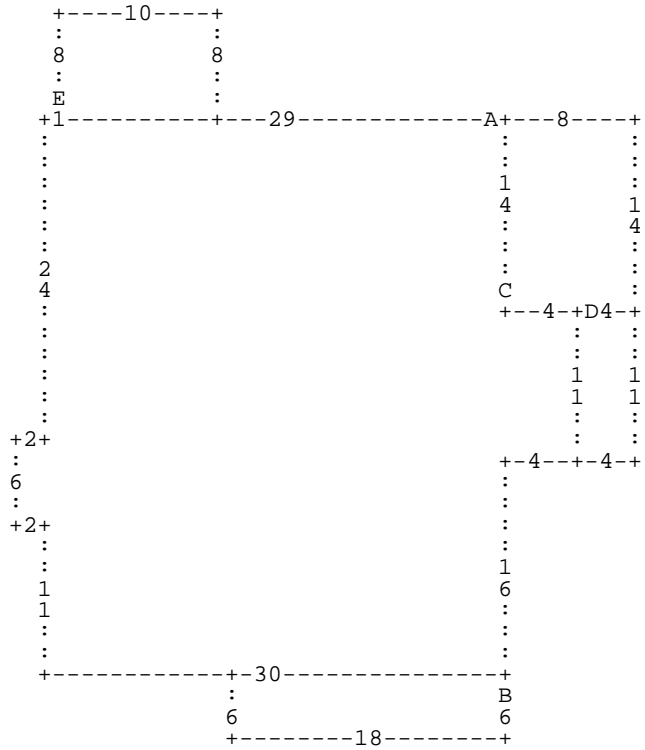

:A DL29 :E DU8 DR10 DD8 DL10 \* DL1 DD24 DL2 DD6 DR2 DD11 DR30 :B DD6 DL18 DU6 DR  
18 \* DU16 DR4 DU11 :D DR4 DD11 DL4 DU11 \* DL4 :C DU14 DR8 DD14 DL8 \* DU14 \*

A= MA 161  
D= AC 1071

1,286.00 SFR-PATIO HOM  
44.00 UTILITY STG-F

B= AC 1052  
E= AC 2071

108.00 PORCH-OPEN-MA  
80.00 UTILITY STG-F

C= AC 1052

112.00 PORCH-OPEN-MA