

HARRIS JEFFREY A
 3005 WYNFALL LN SW
 L16PH2 WALNUT CRK 1.00LT
 .253 AC

Wilson County
 N2 FOUND YR 2024 3701888225.000
 3005 WYNFALL LN SW
 PIN: 3701 88 8225 000
 DISTRICT: 31 C/CIWI-WILSON

ACCOUNT#: 69919180
 NBHD: 8348 WALNUT_CREEK
 Plat Bk/Pg 26 154 APPR: REV APPR DT: 3/12/2015
 EXCD: NOTICE: 82 3/08/2024

Bldg No. 1
 Imp Desc: 6205 APARTMENT-DUPLEX/TRIPLEX EYB: 2001 3005 WYNFALL LN SW Exempt Code
 Grade : D+05 D+05 GRADE AYB: 1997 Finished Area: 1,800.00
 # of Units 2 Rms Bedrms Bathrms HBaths
 LAND VALUE 25,000
 MISC VALUE 0
 BLDG VALUE 148,894
 TOTAL VALUE 173,894

TYPE/CODE/DESCRIPTION	PCT	%CMP	UNITS	RATE	STR#	STR%	SIZ%	HGT%	PER%	COST
AC 2051 PORCH-OPEN-FR	100		20	38.80			120.00			931
AC 2051 PORCH-OPEN-FR	100		72	38.80			106.00			2,961
AC 2061 PATIO-CONC	100		112	7.50			64.00			537
AC 2061 PATIO-CONC	100		112	7.50			64.00			537
AC 2071 UTILITY STG-FR	100		32	28.50			120.00			1,094
AC 2071 UTILITY STG-FR	100		32	28.50			120.00			1,094
MA 251 APT-DUPLEX/TRIPLEX	100		1800	118.00	1.00		108.00			229,392
- AR 10 FORCED AIR HEAT W/ A100			1800	.00						0
- EW 02 VINYL SIDING	100		180	.00						0
- FC 48 VINYL/CARPET	100		1800	.00						0
- FN 06 SPREAD FOOTING	100		180	5.30-						954-
- FT 01 WOOD FRAME	100		1800	.00						0
- IF 30 DRYWALL/CUSTOM	100		1800	.00						0
- RC 02 COMPOSITION SHINGLE	100		1800	.00						0
- RT 03 DOUBLE PITCH ROOF	100		1800	.00						0

RCN...			PCT COMPLETE		100	x				235,592
QUAL..	D+05				80.00	x				188,473
DEPR..	C50				21.00	-		39,579		39,579 T
--ASV...										148,894

PROPERTY NOTES:	PERMIT NO	TYPE	DATE	BOOK	PAGE	DT	DATE	QS	SALES	PRICE
2008 INFORMAL APPEALS: NBHD CHANGE				2745	21	WD	5/30/2018			110,000
PERMIT CODE: N MO/YR: 061997 NOTE: 87048				AMOUNT	2016	CDTH	9/11/2016	E		
				AMOUNT	2364	306	WD	5/22/2009		121,000
					2220	400	WD	12/21/2006		117,000

MISC CODE	DESC	UNITS	RATE	AYB	EYB	DT	PCT	%CMP	ADD.DEPR	PCT	VALUE	EXMPT
							.00					
							.00					
							.00					
							.00					

#	ZONE	TYPE/CODE	LAND QTY	LAND RATE	DPTH	DPT%	TOP%	LOC%	SIZ%	SHP%	OTH%	ADJ	FMV	EXMPT
1	GR6	LT 0562	1.000	25,000.00		.00	.00	.00	100.00	.00	.00	.00	25,000	

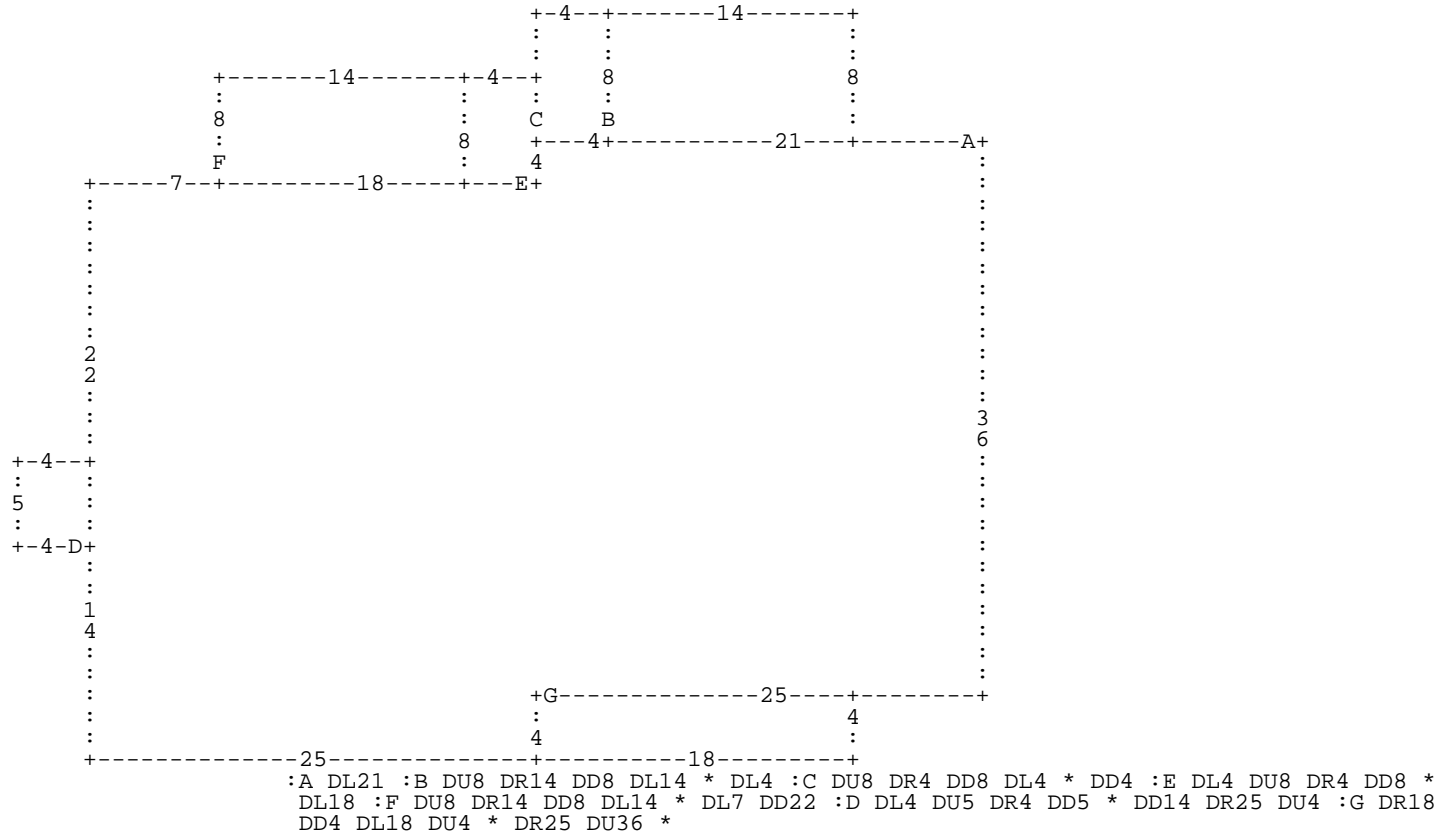

A= MA 251	1,800.00 APT-DUPLEX/TR	B= AC 2061	112.00 PATIO-CONC	C= AC 2071	32.00 UTILITY STG-F
D= AC 2051	20.00 PORCH-OPEN-FR	E= AC 2071	32.00 UTILITY STG-F	F= AC 2061	112.00 PATIO-CONC
G= AC 2051	72.00 PORCH-OPEN-FR				